



# BUTTERFLY VALVE MANUAL

蝶阀选型手册

---



欧拉姆阀门科技有限公司  
OULAM VALVE TECHNOLOGY CO., LTD

**欧拉姆® 中国**

Good Valve  
Flexible Manufacturing

## 六项精进：

- 付出不亚于任何人的努力。
- 要每天反省。
- 积善行，思利他。
- 要谦虚，不要骄傲。
- 活着，就要感谢。
- 忘却感性的烦恼。

**董事长：金志远**

**我为欧拉姆品牌代言**



## 走进欧拉姆



- 中国通用机械工业协会会员单位
- 中国民营科技促进会泵阀产业科技创新分会理事单位
- 中国机械工程学会会员单位
- 中国复合材料学会会员单位
- 中国燃气协会理事单位
- 浙江省泵阀协会副会长单位
- 浙江省发明协会副会长单位
- 中石油一级供应商
- 中石化合格供应商
- 中国石化行业合格供应商
- 国家级高新技术企业
- 国家级“基础智能工厂”培育企业
- 数字泵阀复合材料产业创新示范基地
- 浙江省高新技术企业研究开发中心
- 温州市企业技术研究发展中心
- 浙江省专精特新中小企业
- 浙江省守合同重信用企业
- 浙江省科技型中小企业
- 浙江省创新型中小企业
- 浙江省区域名牌企业
- 浙江省商业秘密保护点示范企业
- 温州市绿色低碳工厂
- 温州市知名商标
- 永嘉县明星企业



欧拉姆阀门科技有限公司专业从事工业阀门和泵阀新材料研究的科技创新型企业，公司注册资本10000万元，是国家级高新技术企业、浙江省“专精特新”中小企业、国家级“基础智能工厂”培育企业、浙江省科技型中小企业、浙江省创新型中小企业，入围中石油一级供应商和中石化合格供应商。

公司总部坐落在中国浙江温州的永嘉工业园区，厂区建筑面积10000平方米，公司历经二十多年的创新发展，形成了以“OULAM”为核心品牌，涵盖各种材质、高中低压、高低温的球阀、闸阀、截止阀、止回阀、蝶阀、调节阀、以及组合装置等多种优质产品。公司研发技术团队有中、高级工程师12名，拥有8项发明专利及28项实用新型专利，积极参与了若干国家标准和团体标准的修订；公司与浙江大学温州研究院、温州职业技术学院、哈尔滨工业大学、上海交通大学、上海同济大学、华东理工大学建立了良好合作关系。

公司获得A1级TS特种设备制造许可证，通过了美国石油学会API6D和602认证、海关联盟EAC认证，以及ISO9001质量管理认证、ISO14001环境管理认证、ISO45001职业健康安全认证、ISO10012测量体系认证、五星级售后服务管理体系认证等，连续多年荣获浙江省AAA级守合同重信用企业、永嘉县明星企业等荣誉称号。

### **央视媒体“东方时空”专业品牌宣传**

公司因坚持技术和管理创新，成为国家级中小企业转型升级成功典型案例，两次接受央视“东方时空”专访报道，又多次在新华社等国内媒体进行大量的正面报道，在国内外业界引起极大的关注和肯定。我公司因在2020年疫情期间优化升级了柔性制造云平台，浙江日报报道了公司柔性制造应用云平台在APS智能排程中发挥出其独特的优势，使得公司借“智”突围，“泵”发新活力。

### **自研工业阀门“柔性制造”应用云平台**

公司打造“好阀门柔性造”的企业战略定位！公司以柔性制造云平台的集合模块，SCM供应链管理、APS智能排程系统、PLM产品生命周期管理、MES精益制造等，从工业大数据分析、柔性制造和客户体验等各方面进行系统性构建。公司的柔性制造云平台落地促进了欧拉姆的数字化生产与经营能力、计算机应用技术、企业管理水平的改造与提升。

### **推出工业阀门“个性化定制”服务**

我们秉承“工业阀门个性化定制”的核心理念，根据不同的应用场景、不同的定制需求，公司全力推广工业阀门个性定制并提供个性化行业解决方案，公司研发团队在阀门领域进行积极开拓，通过柔性制造平台使多品种、小批量的个性化订单需求“化零为整”进行物料需求合并、归类，自动比对物料库存后，自动下单、集中采购、智能化生产出货。公司以柔性制造云平台为依托，打造了一支专业化程度高，创新能力强，技术含量高，工艺装备好的优秀团队。同时，公司在阀门新材料领域进行积极开拓，朝着做专、做精的方向探索高端工业阀门的产业提升之路，为我国的泵阀产业发展注入新的活力。

🗨️ 先进个人



## 央视采访



2011年11月25日，工信部和中宣部关于开展中小企业巡礼，在省市县领导的关心和支持下，欧拉姆阀门被列为**国家级中小企业典型**接受央视采访。2012年5月2日，再次接受央视13频道热点栏目东方时空的采访。



# 一步一台阶的欧拉姆

付出不亚于任何人的努力  
坚定不移的信念与坚持不懈的创新  
才能令我们迈出的每一步，都更加靠近梦想

## 2006年

成立：  
永嘉县欧拉姆阀门有限公司

## 2009年

升级为：  
浙江欧拉姆阀门科技有限公司

通过：  
ISO9001:2005质量体系认证



## 2010~ 2011年

成为：  
中国燃气协会会员单位  
浙江省泵阀协会理事单位

荣获：  
温州市千星成长企业  
永嘉县百星成长企业  
交通银行二星级信用企业

受邀：  
参加第二届“中国浙江成长型企业投融资大会”获得意向投资和银行的资金授信

## 2012年

升级为：  
欧拉姆阀门科技有限公司

考察：  
温州市市长陈金彪一行莅临欧拉姆考察指导工作

荣获：  
浙江省中小微企业创新发展先进单位  
市长结对联系重点企业

列为：  
国家级中小企业的成长典型  
央视栏目“东方时空”采访



# 2013~ 2019年

荣获：

省创新型示范中小企业

温州市知名商标

永嘉县明星企业

设立：

温州市企业技术研究  
开发中心

欧拉姆阀门爱心慈善基金

通过：

国家特种设备制造许可  
TS认证

API美国石油学会认证

# 2020~ 2023年

荣获：

国家级高新技术企业

省级专精特新中小企业

省“AAA”级守合同  
重信用企业

建立：

省级高新技术研究  
开发中心

泵阀复合材料产业  
创新示范基地



# 2024~ 2025年

成为：

浙江省泵阀行业协会  
副会长单位

荣获：

浙江省商业秘密保护点

温州市绿色低碳工厂

中石油入网单位

中石化入网单位



# 2026~ 2030年

5年计划：

防爆认证

船级社认证

CE欧盟认证

德国TUV认证

领军工业认证

中电力入网单位

中海油入网单位

中燃气入网单位

标准创新型企业

创新型试点企业

.....



## 全球化的欧拉姆





我们一直在努力

1, 000, 000, 000+

1, 000, 000+

1, 000+

60+

50+



# 企业荣誉

荣誉是质量的表述，质量是企业的生命，回望前路，我们知道，欧拉姆今天所得远胜所付出的……客户的肯定是对企业产品和服务最好的认可，欧拉姆提供的产品和服务已经得到客户的一致肯定。





# 中石油准入



中国石油招标投标网

邮箱一号

首页 信息公告 结果公示 通知公告 供应商新增准入 承包商新增准入 失信信息公告 三商黑名单 招投标平台

分类导航 / CATEGORIES

当前位置: / 新增准入结果公示 / 44大类阀门新增准入结果公示

- 新增准入招标公告
- 新增准入招标结果公示
- 新增准入结果公示

## 44大类阀门新增准入结果公示

2025-06-05

序号	供应商名称	品类编码	品类名称
23	希佛姆阀门集团有限公司	44010201	高压手动阀
		44010220	高压齿轮传动阀
		44010301	高压手动截止阀
		44010320	高压齿轮传动截止阀
		44010601	高压止回阀
		44020201	中压手动阀
		44020220	中压齿轮传动阀
		44020301	中压手动截止阀
		44020320	中压齿轮传动截止阀
		44020601	中压止回阀
		44010501	高压手动球阀
		44010520	高压齿轮传动球阀
		44020501	中压手动球阀
		44020520	中压齿轮传动球阀
		44010201	高压手动阀
		44010220	高压齿轮传动阀
44010301	高压手动截止阀		
44010320	高压齿轮传动截止阀		
44010601	高压止回阀		
44020201	中压手动阀		
44020220	中压齿轮传动阀		
44020301	中压手动截止阀		
44020320	中压齿轮传动截止阀		
44020601	中压止回阀		
44010501	高压手动球阀		
44010520	高压齿轮传动球阀		
44020501	中压手动球阀		
44020520	中压齿轮传动球阀		
25	欧拉姆阀门科技有限公司	44010201	高压手动阀
		44010220	高压齿轮传动阀
		44010301	高压手动截止阀
		44010320	高压齿轮传动截止阀
		44010601	高压止回阀
		44020201	中压手动阀
		44020220	中压齿轮传动阀
		44020301	中压手动截止阀
		44020320	中压齿轮传动截止阀
		44020601	中压止回阀
		44010501	高压手动球阀
		44010520	高压齿轮传动球阀
		44020501	中压手动球阀
		44020520	中压齿轮传动球阀
		44010201	高压手动阀
		44010220	高压齿轮传动阀
44010301	高压手动截止阀		
44010320	高压齿轮传动截止阀		
44010601	高压止回阀		
26	四川凯沃阀门制造有限公司	44010201	高压手动阀
		44010220	高压齿轮传动阀
		44010301	高压手动截止阀
		44010320	高压齿轮传动截止阀

重要通知

普华咨询

返回

欧拉姆已于2025年3月17日通过中石油一级供应商现场评审!

欧拉姆阀门科技有限公司 \ 好阀门 系性造

# 中石化准入



## 入围通知书

欧拉姆阀门科技有限公司：

在我公司组织的中原油田-球阀（46202503002）球阀\分体式 CL150 RF A105 AISI 4140+ENP 手动 DN25 防火防静电 全通经所需的球阀\分体式 CL150 RF A105 AISI 4140+ENP 手动 DN25 防火防静电 全通经招标中（招标编号：NZZ250422-4603-073352），经评标委员会评审，确定贵公司为入围投标人第1名。

入围货物：球阀\分体式 CL150 RF A105 AISI 4140+ENP 手动 DN25 防火防静电 全通经。请你公司依据入围通知书尽快与中国石油化工股份有限公司中原油田分公司签订合同。

中国石油化工股份有限公司中原油田分公司  
2025-5-5



欧拉姆已于2025年4月22日通过中石化合格供应商现场评审!

# 发明专利



# 实用新型专利



# 经营能力



- ◎ 车铣复合车床
- ◎ 数控立式车床
- ◎ 立式加工中心
- ◎ 龙门加工中心

- ◎ 数控车床
- ◎ 高速钻床
- ◎ 平面磨床
- ◎ 工业电阻炉

- ◎ 超声波清洗机
- ◎ 吊钩式抛丸机
- .....



- ◎ 台式光谱仪
- ◎ 金相显微镜
- ◎ 低温冲击试验
- ◎ 磁粉探伤仪
- ◎ 超声波探伤仪
- ◎ 三坐标测量仪
- ◎ HIC抗氢试验
- ◎ 耐火试验设备
- ◎ 高压试验压机
- ◎ 高压气密试验
- ◎ 超低温试验

# 产品目录

## 蝶阀介绍 INTRODUCTION TO BUTTERFLY VALVE / 001-008



▶ 蝶阀三维立体图与零件 Butterfly Valve 3D Drawing And Parts	001-002
型号编制说明 Model Order Instruction	003
蝶阀密封原理 Butterfly Valve Sealing Principle	004-005
蝶阀结构特征 Butterfly Valve Structure Characteristic	006-008

## 金属硬密封蝶阀 METAL HARD SEAL BUTTERFLY VALVE / 009-031



▶ 对夹式多层次金属硬密封蝶阀 Wafer Multi-Layer Metal Hard Seal Butterfly Valve	009-012
法兰式多层次金属硬密封蝶阀 Flange Multi-Layer Metal Hard Seal Butterfly Valve	013-015
焊接式金属硬密封蝶阀 Welded Metal Hard Seal Butterfly Valve	016-017
对焊式金属硬密封蝶阀 Butt Welding Metal Seated Butterfly Valve	018-021
三偏心多层次金属硬密封/四氟密封蝶阀 Three-Eccentric Multi-Layer Metal-To-Metal/Ptfe Butterfly Valve	022
三偏心多层次金属硬密封/四氟密封蜗轮传动法兰式蝶阀 Three-Eccentric Multi-Layer Metal-To-Metal/Ptfe Worm Gear Flange Type Butterfly Valve	023-025
三偏心多层次金属硬密封/四氟密封蜗轮传动对夹式蝶阀 Three-Eccentric Multi-Layer Metal-To-Metal/Ptfe Worm Gear Wafer Type Butterfly Valve	026-027
三偏心多层次金属硬密封/四氟密封电动传动法兰式蝶阀 Three-Eccentric Multi-Layer Metal-To-Metal/Ptfe Electric Flange Type Butterfly Valve	028-029
三偏心多层次金属硬密封/四氟密封气动传动法兰式蝶阀 Three-Eccentric Multi-Layer Metal-To-Metal/Ptfe Pneumatic Flange Type Butterfly Valve	030-031

## 硬碰硬蝶阀 METAL TO METAL BUTTERFLY VALVE / 032-033



▶ 硬碰硬蝶阀 Metal To Metal Butterfly Valve	032-033
---	---------

**伸缩蝶阀 TELESCOPIC BUTTERFLY VALVE / 034-035**



▶ 伸缩蝶阀 ..... 034-035  
Telescopic Butterfly Valve

**液控蝶阀 HYDRAULIC CONTROL BUTTERFLY VALVE / 036-039**



▶ 液控蝶阀 ..... 036-039  
Hydraulic Control Butterfly Valve

**液控缓闭止回蝶阀 HYDRAULIC CONTROLLED SLOW STOP BUTTERFLY VALVE / 040-045**



▶ 液控缓闭止回蝶阀 ..... 040-045  
Hydraulic Controlled Slow Stop Butterfly Valve

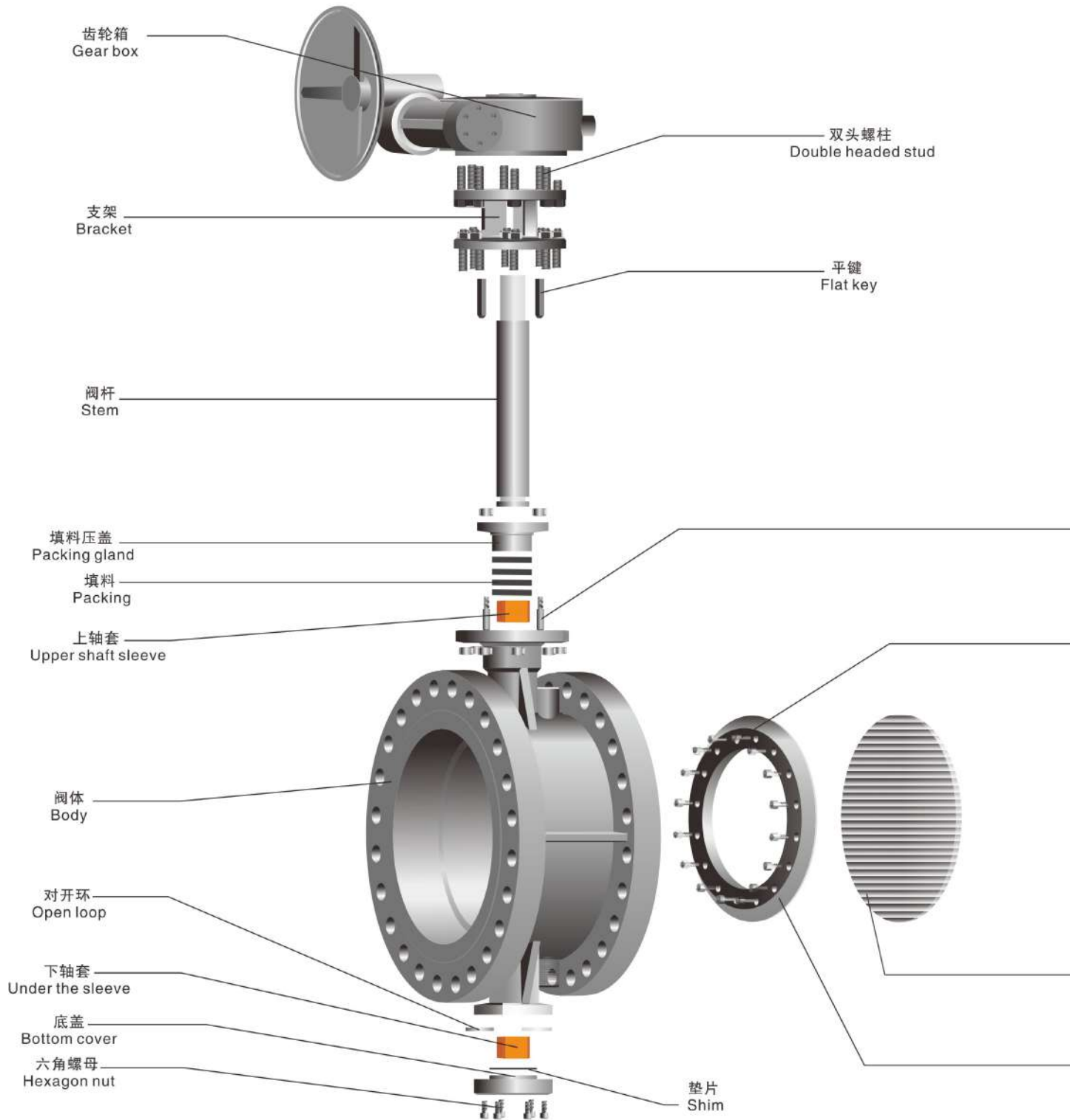

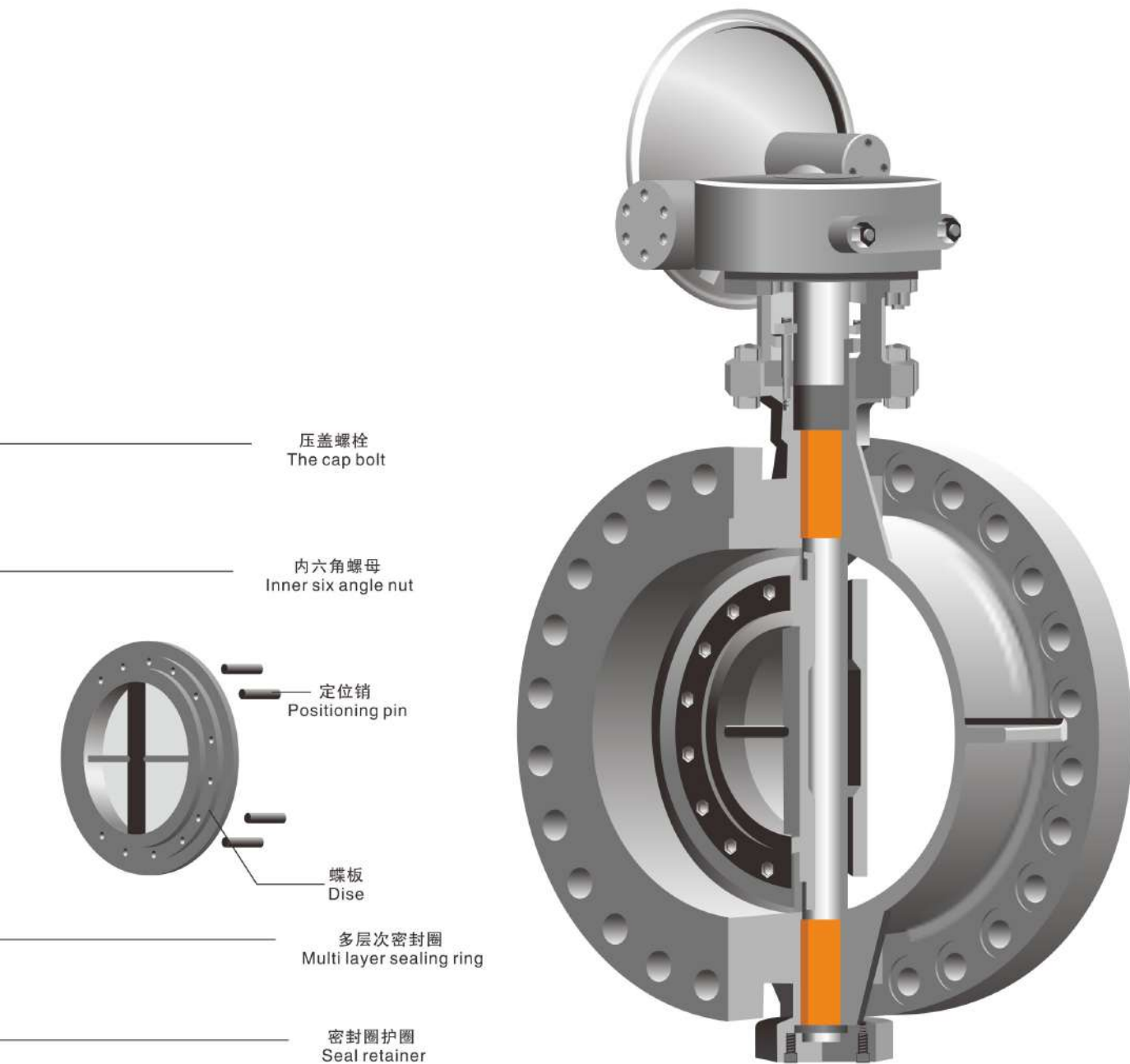

蝶阀型号编制说明 Model Order Instruction



蝶阀流向截断方式 Butterfly Valve Flow Truncation Method

Ds	D
可任意流向截断介质的蝶阀(双向压) Butterfly valve with any flow direction to cut off the medium(Bi-directional pressure)	只能单一流向截断介质的蝶阀(单向压) Butterfly valve with one way flow direction to cut off the medium(One way pressure)

蝶阀驱动方式 Butterfly Valve Operator Type

3	6	7	9
手动减速机驱动 Manual Operator	气动装置驱动 Pneumatic Operator	液动装置驱动 Hydraulic Operator	电动装置驱动 Electrical Operator

蝶阀连接方式 Butterfly Valve Connection Type

4	6	7
法兰式 Flange Type	对焊式 Butt welding Type	对夹式 Wafer Type

蝶阀结构型式 Butterfly Valve Structure Type

1	2	3
中线结构 Midline structure	双偏心结构 Double eccentric structure	三偏心结构 Three eccentric structure

密封面材料代号 Sealing Surface Material Code

H	Y	YY	X	F	W
合金钢 HRC30-45度 Alloy steel HRC30-45 Degree	司太立合金 HRC40-60度 Stellite Alloy HRC40-60 Degree	硬碰硬 Metal to metal	橡胶 Rubber	氟塑料 Fluorine Plastics	本体材料 Body Material

蝶阀公称压力 Nominal Pressure of Butterfly Valve

1、用MPa的10倍值表示 10 times of MPa Marks
2、用磅级表示 Pound Level Marks

阀体材料代号 Body Material Code

阀体材料 Body material	碳钢 Carbon steel	铬镍合金钢 Chromium nickel alloy steel	铬镍钛钢 Chromium nickel steel	铬镍钼钛钢 Cr.ni.mo.ti steel
代号 Code	C	I	P	R

蝶阀公称口径 Nominal Diameter of Butterfly Valve

DN(mm)	inch	DN(mm)	inch	DN(mm)	inch
50	2	450	18	1600	64
65	2.5	500	20	1800	72
80	3	600	24	2000	80
100	4	700	28	2200	88
125	5	800	32	2400	96
150	6	900	36	2600	104
200	8	1000	40	2800	112
250	10	1200	48	3000	120
300	12	1400	56		
350	14				
400	16				

我公司生产的系列蝶阀的密封结构形式有以下几种：中线密封、单偏心密封、双偏心密封，三偏心密封，变偏心密封，各种结构类型蝶阀的密封原理简述如下：

Our butterfly valves are structured to centerline seal, single eccentric seal, double eccentric seal, triple eccentric seal and variable eccentric seal. The sealing principles of these structures are stated as following:

### 中线密封蝶阀的密封原理 Sealing Principle of Centerline Seal Butterfly Valve

蝶阀的蝶板密封中心和阀杆的回转中心重合，阀门依靠一定的过盈量在阀门与蝶板密封面间造成密封比压，保证阀门密封副的密封效果。此结构在阀体上衬胶，多适用于中小口径的蝶阀，由于是挤压变形，阀门在开关过程中，蝶板始终受到挤压，因此上下阀轴部分受到挤压较大，阀门的使用寿命受到影响；阀门的启闭力矩较大。缺点是由于蝶板与阀座始终处于挤压、刮擦状态、阻距大、磨损快。为克服挤压、刮擦、保证密封性能、阀座基本上采用橡胶或聚四氟乙烯等弹性材料、但也因而在使用上受到温度的限制、这就是为什么传统上人们认为蝶阀不耐高温的原因。

With the disc seal center of butterfly valve and rotation center of stem overlapped, sealing load will be produced between the sealing faces of seat and disc under certain magnitude of interference, thus to ensure effective seal of valve. Lined with rubber on the body, this structure is applicable for medium and small-bore butterfly valves. Due to the deformation under extrusion, during the process of opening and closing, disc is always under extrusion. So, the upper and lower valve shafts are seriously extruded, which can be bad to the service life of valve. And the open-close moment of valve is relatively high. The defect is that disc and seat are always under extrusion, scratch and to ensure the good seal, seat basically uses rubber or PTFE, or other elastic materials. However, the temperature can be the problem. That it why it is said that butterfly valves are conventionally ,not resistant to high temperature.

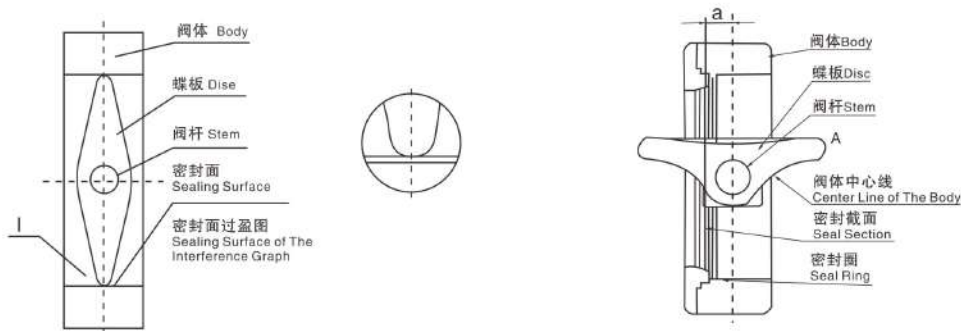

### 单偏心密封蝶阀的密封原理 Sealing Principle Of Single Eccentric Seal Butterfly Valve

由于蝶板的回转中心(即阀轴中心)与蝶板密封截面按 $a$ 偏心设计，使得蝶阀在开启过程中，蝶板密封面逐渐脱离阀座密封面，蝶板转动至 $15^\circ - 25^\circ$ 时，蝶板密封面完全脱离阀座密封，完全开启时，两密封面之间形成间隙，从而使得蝶阀在启闭过程中，两密封面之间相对机械磨损及挤压大为降低，从而保证了蝶阀的密封原理。但由于整个开关过程中蝶板与阀座的刮擦现象并未消失、在应用范围上和同心蝶阀大同小异、故采用不多。

Because of the rotation center of the disc (i.e. valve shaft center) and the butterfly plate sealing section is designed according to an eccentric, making the valve in the opening process, the disc sealing surface gradually separates from the valve seat sealing surface, once the butterfly plate rotates to  $15^\circ - 25^\circ$  degrees, the disc sealing surface separates completely from the valve seat seal once fully open, it forms a gap between the two sealing surface, so that the valve in the opening and closing process, the relative mechanical wear and extrusion between the sealing surface is greatly reduced, so as to ensure the sealing of butterfly valve. However as the scratch between the disc and seat doesn't disappear during the whole process of open and close, they are almost similar to concentric butterfly valves in the area of application, this is why they have not been popularly used.

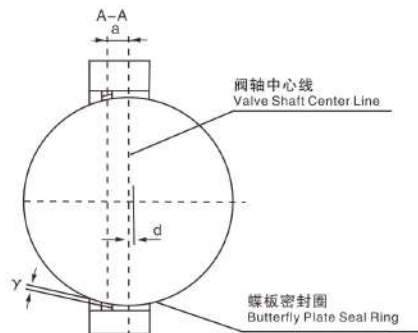

单偏心密封蝶阀密封副结构  
Single Eccentric Butterfly Valve Sealing Structure

三偏心由于在双偏心蝶阀的基础上将阀座中心线再与阀体中心线形成一个 $\beta$ 角偏置,使得蝶阀在启闭过程中,蝶板的密封面在开启瞬间立即脱离阀座密封面,而在关闭瞬间才会接触并压紧阀座密封面。当完全开启时,两密封面之间形成一个与双偏心密封蝶阀相同间隙 $Y$ ,该类蝶阀的设计,彻底消除了两密封面之间的机械磨损和擦伤,使蝶阀的密封性能和使用寿命得到大大提高。阀门关闭时,密封圈受阀体密封面跟蝶板的挤压,产生了两个方向的弹性变形。密封面在长轴方向上受到了向外的张力,在短轴方向上受到向内的压应力,长短轴产生不同方向的弹性形变。从而使阀门密封面间的密封力逐渐达到最大值。

这一独特的偏心组合,即利用凸轮效应,又完全消除了摩擦,从而实现阀门 $90^\circ$ 行程中,阀座与蝶板上的密封圈之间无摩擦,去除了磨损和泄漏的可能。

A" $\beta$ "eccentric is formed up between the centerline of seat and the centerline of body on the basis of double eccentric butterfly valve, making disc sealing face immediately disengaged from seat sealing face upon the opening or closing of butterfly valve, and in close contact with the seat sealing face upon closing. When fully opened, a gap "Y", which is same as that in double eccentric sealing butterfly valve, is formed upon the two sealing faces. This type design of butterfly valves has thoroughly eliminated the mechanical wear and scratch between the two sealing faces, making the sealing performance and service life of butterfly valves greatly improved. When the valve is closed, with sealing ring under the extrusion of body sealing face and disc, two upwards elastic deformations are produced. The sealing face is fallen under outward tension at long shaft and inward compressive stress at short shaft. The long and short shafts produce elastic deformation of different directions, thus to maximize the sealing force between the sealing faces of valves.

This distinctive eccentric combination not only uses cam effect, but also eliminates friction completely, thus to ensure no friction between seat and sealing ring on disc during  $90^\circ$  stroke.

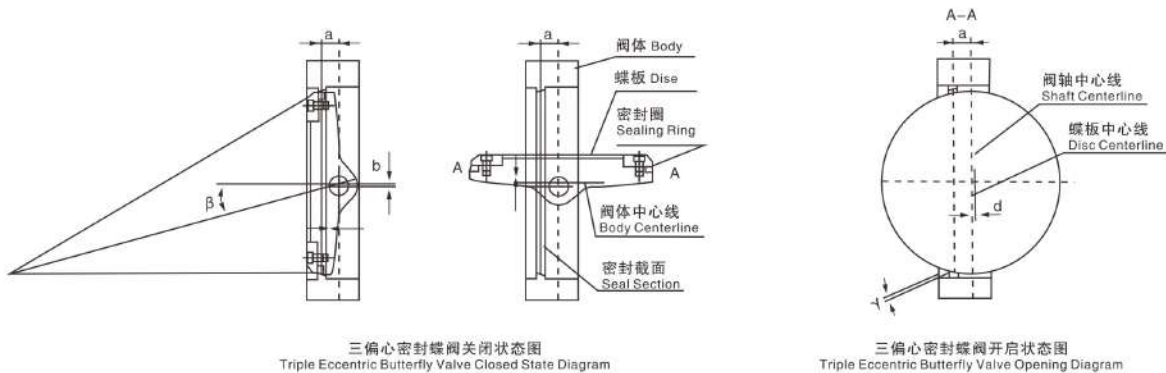

三偏心密封蝶阀密封副结构  
Triple Eccentric Butterfly Valve Sealing Pair Structure

## 变偏心密封的密封原理 The Sealing Principle of Variable Eccentric Sealing

变偏心蝶阀的独特之处在于安装蝶板的阀杆轴是一个三段轴式结构,此三段轴式阀杆两段轴段同心,而中间段轴中心线与两端轴线偏离一个中心距,蝶板就安装在中间轴段上。这样的偏心结构使得蝶板在全开位置时成为双偏心状,而在蝶板转动到关闭位置时则成为单偏心状。由于偏心轴的作用,在接近关闭时,蝶板向阀座的密封锥面内移进一个距离,蝶板与阀座的密封面相吻合达到可靠的密封性能,当使用一定周期时阀座密封面磨损后,可以调整驱动机构,使蝶板的关闭位置,驱前若干角度,这样可以恢复到新的密封状态。

The distinctive feature of variable eccentric butterfly valve is that the shaft where disc is mounted with is a three-segment eccentric shaft. The two ends of the three-segment shaft are concentric, while the centerline of the middle segment is deviated from the axial lines of the two ends by a center-to-center distance. Disc is just mounted on the middle segment. This eccentric structure forms up a double eccentric shape when disc is completely opened, and a single eccentric shape when disc is turned to be closed. Under the force of eccentric shaft, when tending to be closed, disc will move somewhat toward the conical sealing surface of the seat, and then engaged to perform dependable sealing. When seat sealing face is abraded after a period of service, adjust the driving mechanism to make the close position of disc forward for some degrees, in this way to set up a new sealing state.

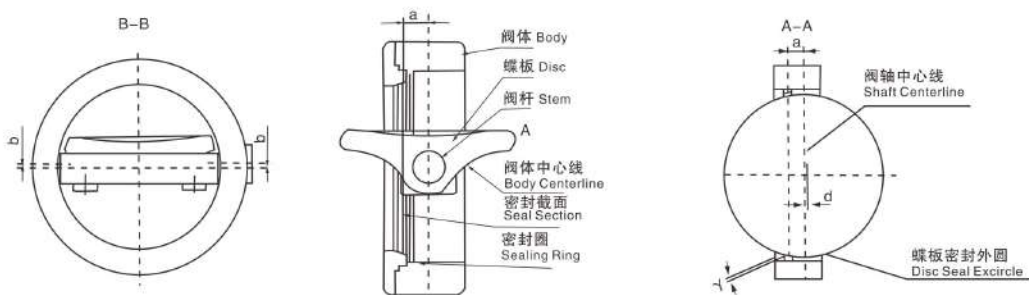

双偏心密封蝶阀密封副结构  
Double Eccentric Butterfly Valve Seal Pair Structure

蝶阀是用来打开和关闭管道内介质流通或调节管道内介质流量。它们主要结构及特点如下：  
The butterfly valve is used to open and close the medium circulation or regulate the medium flow in the pipeline.

### 主要结构特点 The Main Structure Features

1、结构简单、体积小、重量轻、安装尺寸小。根据阀体连接形式可分对夹式(包括凸耳对夹式)、法兰连接和对焊连接三种基本连接形式。

2、密封结构形式有多层次硬密封、整板式硬密封和弹性硬密封三种，可用于各种不同工况，且密封性能好，使用寿命长。

1)多层次硬密封和整板硬密封蝶阀(分别见下图和左图)，全部采用了三偏心、锥面密封结构形式，密封副具有越关越紧的功能，并能有效清除阀座上的结垢，大锥角设计能承受600℃的高温。本系列蝶阀压力等级达到Class600。

2)弹性硬密封结构(见上图)采用J型金属密封圈结构，适用于双偏心结构的蝶阀，压力等级<Class300，具有优良的密封性，寿命长、易加工制造。

3)、本系列蝶阀所有的密封部件均采用了防火设计，即使着火后还能保证各个位置的密封性能。

4)、蝶阀在完全开启的情况下流阻较小，部分开启的情况下能进行灵敏的流量控制。

5)、驱动力矩小，操作简便、迅速。

1. Simple structure, small volume, light weight and small size for installation. According to the connection type, there are three kinds of basic connection: wafer type (including lug wafer type), flange type and butt welding type.

2. The sealing structure has three kinds including multi-layer metal sealed, wholly metal Metal Sealed and the elastic Metal Sealed, used for a variety of different conditions, with good sealing performance and long service life.

1) multi-layer hard seal and the whole board (see below are hard sealing butterfly valve, and left) all the three eccentric, cone sealing structure, sealing with more tightening function, and can effectively remove fouling on the seat, the design of high temperature can withstand 600 degrees wide angle. The pressure level of this series of butterfly valves reaches Class600.

2) Flexible metal seal structure (see above picture) adopts J type metal seal structure, which is suitable for double eccentric butterfly valve, pressure rating <Class 300 and characterized by excellent sealing, long service life, easy processing and manufacturing.

3) All the sealing parts of this series butterfly valve are used with fire protection design, ensuring the sealing performance of each position even after the fire.

4) Small flow resistance as the butterfly valve in the fully open condition, sensitive control of the flow as valve in partially open condition .

5) The torque force is small, operating easily and fast.

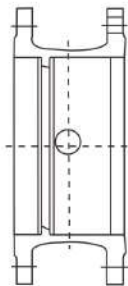

法兰连接形式  
Flange Connection Type

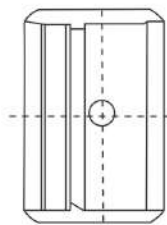

对接焊连接形式  
Butt Welding Connection Type

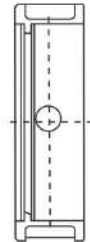

对夹连接形式  
Wafer Connection Type

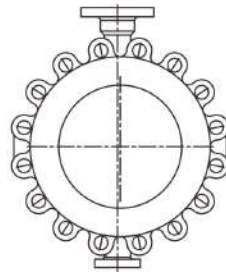

凸耳连接形式  
Lug Connection Type

### 1)软密封结构(见下图)Soft Sealing Structure (See Bellow Picture)

适用单偏心和双偏心结构的蝶阀，压力等级≤Class 600。(中线密封结构适用压力等级≤Class 150)密封圈(材料为PTFE)放置在阀体上具有以下特点：

A)不需要使用附加的密封圈或金属支撑圈即可可靠密封。

B)可保持双向的无泄漏的密封。

C)维修量少，寿命长。

It is applicable for single and double eccentric butterfly valve, the pressure rating≤Class 600. (Centerline sealing structure applied to pressure ≤ Class 150), seal material (PTFE) placed on the body has the following characteristics:

A) Don't require additional sealing ring or metal support ring, with reliably sealed.

B) Maintaining bi-directional sealing with zero leakage.

C) Less repair, long service life.

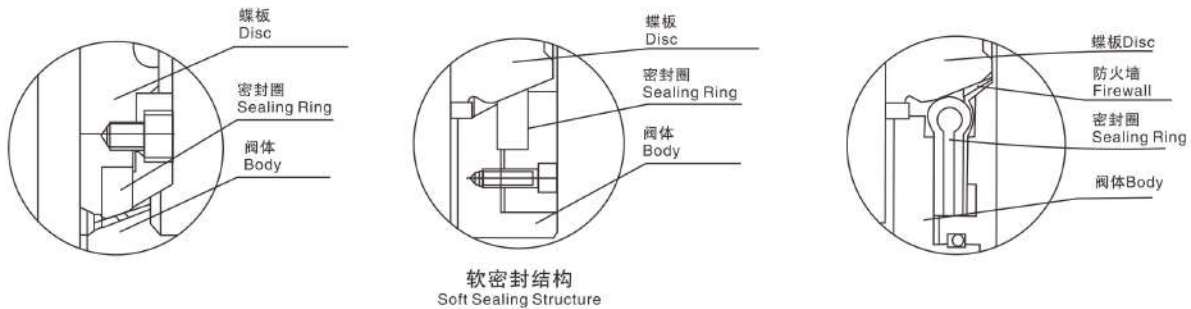

## 2)多层次硬密封结构(见下图) The Multi-Layer Metal Sealed Structure (See Bellow Picture)

多层次硬密封结构，适用于单偏心、双偏心和三偏心结构的蝶阀，压力等级 $\leq$ Class 600，其中三偏心蝶阀可保持双向无泄漏。多层次密封圈可采用不锈钢和非金属材料复合而成，其中非金属材料根据使用工矿选用柔性石墨、PTFE或非石棉材料等。

Multi-layer metal sealed structure, is suitable for single eccentric butterfly valves, double eccentric butterfly valves and triple eccentric butterfly valves, with pressure rating $\leq$ Class 600. Besides, triple eccentric butterfly valves can be bi-directional zero leakage. The multilayer sealing ring can be made of stainless steel and non-metal material, which non-metal material can be flexible graphite, PTFE or non asbestos materials etc.

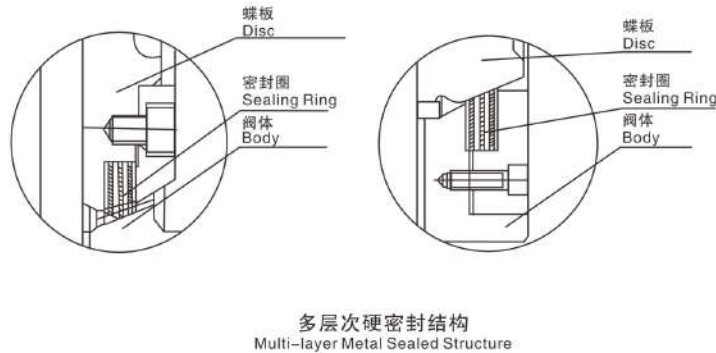

## 3)弹性圈硬密封结构(见下图) Elastic Ring Metal Sealed Structure

采用J型金属密封圈结构，适用于单偏心双偏心结构的蝶阀，压力等级 $<$ Class300。此结构本身具有防火结构，可适用温度变化较大的场合，具有优良的密封性，寿命长、易加工制造。

Using J type metal sealed structure, is suitable for single eccentric butterfly valve and double eccentric butterfly valve, the pressure class rating  $<$ Class300. This structure has fireproof structure, can be suitable for large temperature changes, with excellent sealing performance, long service life, easy for processing and manufacturing.

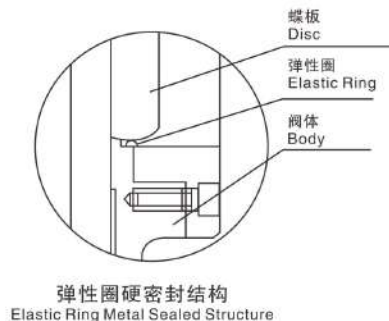

## 用途及特点 Purpose and Characteristic

硬密封蝶阀系列产品，是我公司新开发的长寿命、节能型蝶阀。产品符合国家标准JB/T8527 (金属密封蝶阀)和GB/T13927 (通用阀门压力试验)标准及阀门其它相关标准的规定。

本产品由阀体、蝶板、密封圈、传动机构等主要部件组成。其结构采用二维或三维偏心原理设计，硬软多层次密封兼容的加工新工艺，使蝶阀在运行工作时，减少其扭矩力，达到省力、节能之功能。从而确保蝶阀整体的抗腐蚀、耐高温、抗磨损的可能性。其主要性能特点是：

- 1、结构独特、型小轻便、操作灵活、省力、方便；
- 2、密封可靠，可满足各级标准；
- 3、流量特性好，且具有调节功能；
- 4、采用偏心原理，使密封面近似零磨损，延长了阀门使用寿命；
- 5、应用范围广，可用于水、蒸气、油品、空气、煤气等介质；
- 6、适用不同温度及15.0MPa以下的压力等级、耐腐蚀等各种工况之管线。

Hard seal butterfly valve series products, is my company's new development of long-life, energy-saving butterfly valve. Products comply with national standards JB/T8527 (metal sealed butterfly valve) and GB/T13927 (general valve pressure test) standards and other relevant standards of the valve.

This product is composed of main parts, such as valve body, butterfly plate, sealing ring, transmission mechanism and so on. The structure of the two-dimensional or three-dimensional eccentric principle design, a new machining process of hard and soft sealing multi-level compatible, butterfly valve in the operation, reduce the torque, achieving the function of saving, energy saving. So as to ensure the overall corrosion resistance, high temperature and wear resistance of the butterfly valve. Its main performance characteristics are:

- 1, Unique structure, small size, light, flexible operation, labor-saving and convenient;
- 2, Sealed reliable, can meet all levels of standards;
- 3, The flow characteristic is good, and has the adjustment function;
- 4, The use of eccentric principle, so that the close cover of zero wear and tear, to extend the service life of the valve;
- 5, Wide range of applications, can be used in water, steam, oil, air, gas and other media;
- 6, Applicable to different temperature and 15.0MPa below the pressure level, corrosion resistance and other conditions of the pipeline.

## 用途 Purpose

本蝶阀适用于食品、医药、石油化工、电厂、钢厂、工业环保水处理及高层建筑、供排水管道上作调节流量和截断流体最佳装置。

Our butterfly valve can be applied to food, medicine, petroleum and chemical industry, electric plant, steel plant, industrial environmental protection water treatment and high building water supply and drainage etc, being the best device for isolating or regulating flow in pipeline.

## 主要性能参数及采用标准 Main Performance Parameters and Standard

设计标准 Design Standard		JB/T8527						
法兰连接尺寸 Flange Connection Dimension		GB/T9124.1、GB/T9124.2						
结构长度 Face to Face Length		GB/T12221						
压力试验 Pressure Test		GB/T13927 JB/T9092						
公称通径 Nominal Diameter		50~2000						
公称压力 Nominal Pressure		1.0	1.6	2.5	4.0	6.3	10.0	15.0
试验压力 Test Pressure	强度试验 Shell Test	1.5	2.4	3.75	6.0	9.5	14.4	20.9
	密封试验 Sealing Test	1.1	1.76	2.75	4.4	7.0	10.6	15.3
	气密封试验 Air Sealing Test	0.5~0.7MPa						
适用介质 Applicable Media		水、油品、蒸汽、煤气、酸、碱等 Water, Oil, Steam, Gas, Acid, Alkali, Etc.						
适用温度 Applicable Temperature		-100℃~800℃						

## 产品用途 Production Use

本蝶阀适用于食品、医药、石油化工、电厂、钢厂、工业环保水处理及高层建筑、供排水管道上，是作调节流量和截断流体的理想装置。  
The butterfly valve is suitable for food, medicine, petrochemical industry, power plant, steel plant, industrial environmental water treatment, high-rise buildings, water supply and drainage pipes, and is an ideal device for regulating flow and cutting off fluid.

## 产品特点 Production Features

本蝶阀系吸收、消化国外技术，并结合国内用户意见和生产中积累的经验而精心研制的新一代产品。

- 1、采用三维偏心结构，阀体密封圈采用多层次密封圈结构，使蝶板同阀体密封面均匀可靠接触，可达到气密封无泄漏。
- 2、结构独特、操作灵活、省力、方便，使用寿命长。
- 3、耐高温、耐腐蚀、耐磨损的三维偏心。

This butterfly valve is absorption and digestion of foreign technology, combined with the domestic users opinions and accumulated experience in production and carefully developed a new generation of products.

1. Using three-dimensional eccentric structure, the body sealing ring adopts multi-layer sealing ring structure, make the butterfly plate valve sealing surface with uniform and reliable contact, can achieve without leaking gas seal.
2. Unique structure, flexible operation, energy saving, convenient, long service life.
3. High temperature resistance, corrosion resistance, wear resistance of three-dimensional eccentric.

## 执行标准 Standard Adopted

设计与制造 Design and manufacture	法兰连接 Flange connection	结构长度 Face to face	试验与检验 Test and inspection
GB/T 12238、JB/T8527	GB/T 9113、JB/T79、HG20592	GB/T 12221	GB/T 13927

## 主要技术参数 Main Technical Parameters

公称通径 Nominal diameter	DN(mm)	50~2000				50~500
公称压力 Nominal pressure	PN(MPa)	0.6	1.0	1.6	2.5	4.0
试验压力 Ps(MPa) Test pressure	强度试验 Strength test	0.9	1.5	2.4	3.75	6.0
	密封试验 Sealing test	0.66	1.1	1.76	2.75	4.4
	气密封试验 Gas seal test	0.6	0.6	0.6	0.6	0.6
渗漏率 Leak rate	零泄漏或(Zero leakage or) $<0.1 \times DNmm^3/s$ (符合 Conform GB/T13927标准 Standard)					
适用温度 Applicable temperature	碳钢 Carbon steel: $-29^{\circ}C \sim 425^{\circ}C$ 不锈钢 Stainless steel: $-40^{\circ}C \sim 600^{\circ}C$					
适用介质 Applicable medium	空气、水、蒸汽、煤气、油品及酸、碱、盐带有弱腐蚀性介质等 Air, water, steam, gas, oil, acid, alkali, salt with weak corrosive medium, etc					
驱动形式 Drive form	蜗轮传动、气动传动、电动传动、液动传动 Worm gear drive, pneumatic drive, electric drive, hydraulic drive					

## 主要零件材料 Main Parts Material

零件名称 Part name	材料 Material
阀体 Body	铸钢、不锈钢、铬钼钢、合金钢、双相钢 Cast steel, stainless steel, chrome molybdenum steel, alloy steel, dual phase steel
蝶板 Plate	铸钢、不锈钢、铬钼钢、合金钢、双相钢 Cast steel, stainless steel, chrome molybdenum steel, alloy steel, dual phase steel
阀座 Seat	不锈钢、堆焊司太立等硬质合金 Stainless steel, welding department is instant cemented carbide
密封圈 Sealing ring	不锈钢与耐高温石棉板组合成多层次 Stainless steel and high temperature resistant asbestos board layers
阀杆 Stem	20Cr13、1Cr13不锈钢、铬钼钢、特殊材料 Stainless steel, chrome molybdenum steel, special material
轴套 Shaft	奥氏体不锈钢 Austenitic stainless steel、304氮化 Nitride
填料 Packing	柔性石墨 Flexible graphite、PTFE
填料压盖 Packing gland	铸钢、不锈钢 Cast steel, stainless steel
支架 Stents	铸钢、不锈钢 Cast steel, stainless steel

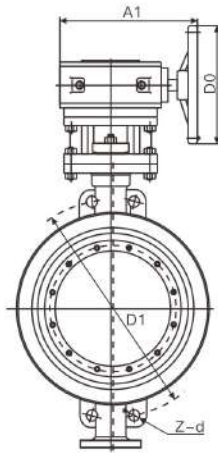

(D373<sup>H</sup><sub>F</sub>)

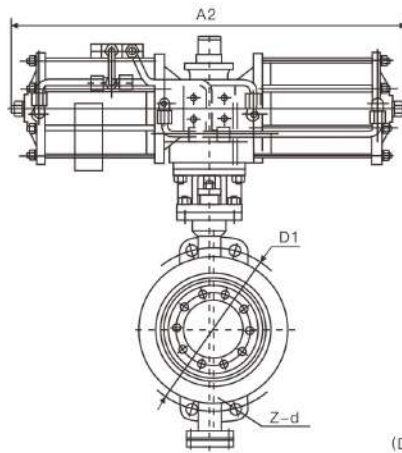
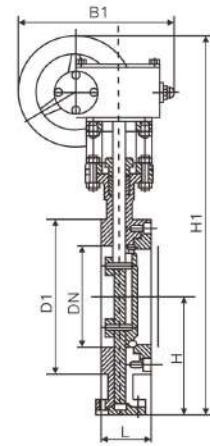

(D673<sup>H</sup><sub>F</sub>)

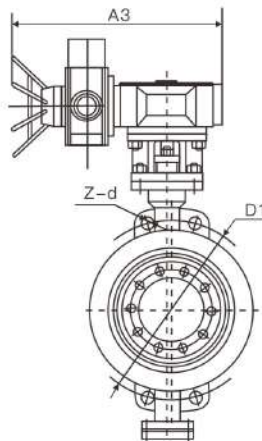
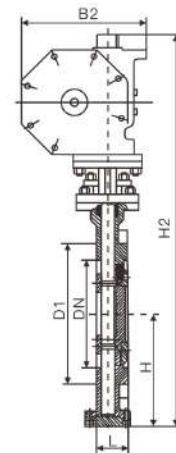

(D973<sup>H</sup><sub>F</sub>)

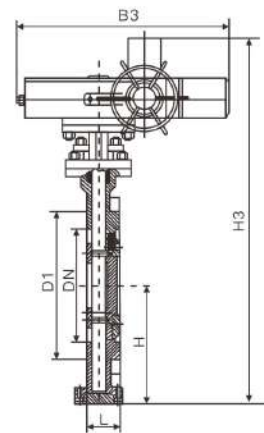

主要外形连接尺寸 Main External Connection Dimensions

PN0.6/1.0MPa

DN		L		H	D373H			D673H			D973H			PN0.6MPa		PN1.0MPa		D373H WT(Kg)
毫米 mm	英寸 Inches	短Short	长Long		H <sub>1</sub>	A <sub>1</sub>	B <sub>1</sub>	H <sub>2</sub>	A <sub>2</sub>	B <sub>2</sub>	H <sub>3</sub>	A <sub>3</sub>	B <sub>3</sub>	D <sub>1</sub>	Z-φd	D <sub>1</sub>	Z-φd	
40	1 1/2	33	33	107	330	180	200	625	245	72	530	250	255	100	4-14	110	4-18	10
50	2	43	43	112	350	180	200	625	245	72	530	250	255	110	4-14	125	4-18	12
65	2 1/2	46	46	115	370	180	200	625	245	72	530	250	255	130	4-14	145	8-18	13
80	3	46	64	125	380	180	200	645	245	72	565	250	255	150	4-18	160	8-18	15
100	4	52	64	138	420	180	200	675	355	92	600	250	255	170	4-18	180	8-18	17
125	5	56	70	164	460	180	200	715	355	92	640	250	255	200	8-18	210	8-18	27
150	6	56	76	175	555	270	280	800	355	92	704	300	315	225	8-18	240	8-22	29
200	8	60	89	215	780	400	425	850	250	170	775	300	315	280	8-18	295	8-22	45
250	10	68	114	243	840	400	425	925	250	170	945	300	315	335	12-18	350	12-22	69
300	12	78	114	285	995	450	560	1035	450	220	1070	300	315	395	12-22	400	12-22	86
350	14	78	127	320	1050	450	560	1070	450	220	1140	300	315	445	12-22	460	16-22	122
400	16	102	140	350	1220	535	580	1190	450	220	1210	300	315	495	16-22	515	16-22	141
450	18	114	152	350	1280	535	580	1250	650	280	1335	575	714	550	16-22	565	20-26	191
500	20	127	152	380	1365	535	580	1290	650	280	1415	575	714	600	20-22	620	20-26	260
600	24	154	178	435	1460	570	660	1455	850	380	1605	656	810	705	20-26	725	20-30	380
700	28	165	229	480	1520	750	550	1585	850	380	1844	656	810	810	24-26	840	24-30	450
800	32	190	241	530	1710	750	550	1700	1250	380	2040	656	810	920	24-30	950	24-33	650
900	36	203	241	595	1810	750	550	1965	1250	380	2255	785	863	1020	24-30	1050	28-33	830
1000	40	216	300	650	1900	900	750	2015	1250	380	2380	785	863	1120	28-30	1160	28-36	1050
1200	48	254	360	775	1180	1000	925	2250	1250	380	2640	785	863	1340	32-33	1380	32-39	1400
1400	56	279	390	870	1450	1000	925	-	-	-	2886	-	-	1560	36-36	1590	36-42	1900
1600	64	318	440	1000	1730	1000	925	-	-	-	3156	-	-	1760	40-36	1820	40-48	2900
1800	72	356	490	1110	3020	1100	980	-	-	-	3421	-	-	1970	44-39	2020	44-48	4000
2000	80	406	540	1250	3270	1100	980	-	-	-	3685	-	-	2180	48-42	2230	48-48	5300

主要外形连接尺寸 Main External Connection Dimensions

PN1.6/2.5MPa

DN		L		H	D373H			D673H			D973H			PN1.6MPa		PN2.5MPa		D373H WT(Kg)
毫米 mm	英寸 Inches	短Short	长Long		H <sub>1</sub>	A <sub>1</sub>	B <sub>1</sub>	H <sub>2</sub>	A <sub>2</sub>	B <sub>2</sub>	H <sub>3</sub>	A <sub>3</sub>	B <sub>3</sub>	D <sub>1</sub>	Z-φd	D <sub>1</sub>	Z-φd	
40	1 1/2	33	33	107	330	180	200	625	245	72	530	250	255	110	4-18	110	4-18	10
50	2	43	43	112	350	180	200	625	245	72	530	250	255	125	4-18	125	4-18	12
65	2 1/2	46	46	115	370	180	200	625	245	72	530	250	255	145	8-18	145	8-18	13
80	3	46	64	125	380	180	200	645	245	72	565	250	255	160	8-18	160	8-18	15
100	4	52	64	138	420	180	200	675	355	92	600	250	255	180	8-18	190	8-22	17
125	5	56	70	164	460	180	200	715	355	92	640	250	255	210	8-18	220	8-26	27
150	6	56	76	175	555	270	280	800	355	92	704	300	315	240	8-22	250	8-26	29
200	8	60	89	215	780	400	425	850	250	170	775	300	315	295	12-22	310	12-26	45
250	10	68	114	243	840	400	425	925	250	170	945	300	315	355	12-26	370	12-30	69
300	12	78	114	285	995	450	560	1035	450	220	1070	300	315	410	12-26	430	16-30	86
350	14	78	127	320	1050	450	560	1070	450	220	1140	300	315	470	16-26	490	16-33	122
400	16	102	140	350	1220	535	580	1190	450	220	1210	300	315	525	16-30	550	16-36	141
450	18	114	152	350	1280	535	580	1250	650	280	1335	575	714	585	20-30	600	20-36	191
500	20	127	152	380	1365	535	580	1290	650	280	1415	575	714	650	20-33	660	20-36	260
600	24	154	178	435	1460	570	660	1455	850	380	1605	656	810	770	20-36	770	20-39	380
700	28	165	229	480	1520	750	550	1585	850	380	1844	656	810	840	24-36	875	24-42	450
800	32	190	241	530	1710	750	550	1700	1250	380	2040	656	810	950	24-39	990	24-48	650
900	36	203	241	595	1810	750	550	1965	1250	380	2255	785	863	1050	28-39	1090	28-48	830
1000	40	216	300	650	1900	900	750	2015	1250	380	2380	785	863	1170	28-42	1210	28-56	1050
1200	48	254	360	775	1180	1000	925	2250	1250	380	2640	785	863	1390	32-48	1420	32-56	1400
1400	56	279	390	870	1450	1000	925	-	-	-	2886	-	-	1590	36-48	1640	36-62	1900
1600	64	318	440	1000	1730	1000	925	-	-	-	3156	-	-	1820	40-56	1860	40-62	2900
1800	72	356	490	1110	3020	1100	980	-	-	-	3421	-	-	2020	44-56	2070	44-70	4000
2000	80	406	540	1250	3270	1100	980	-	-	-	3685	-	-	2230	48-62	2300	48-70	5300

注：本表中法兰尺寸按JB/T 79标准系列1尺寸，结构长度按GB/T 12221标准。

Note: The dimensions of flanges in this table are JB/T 79 standard series 1, and the Face to Face is GB/T 12221 standard.

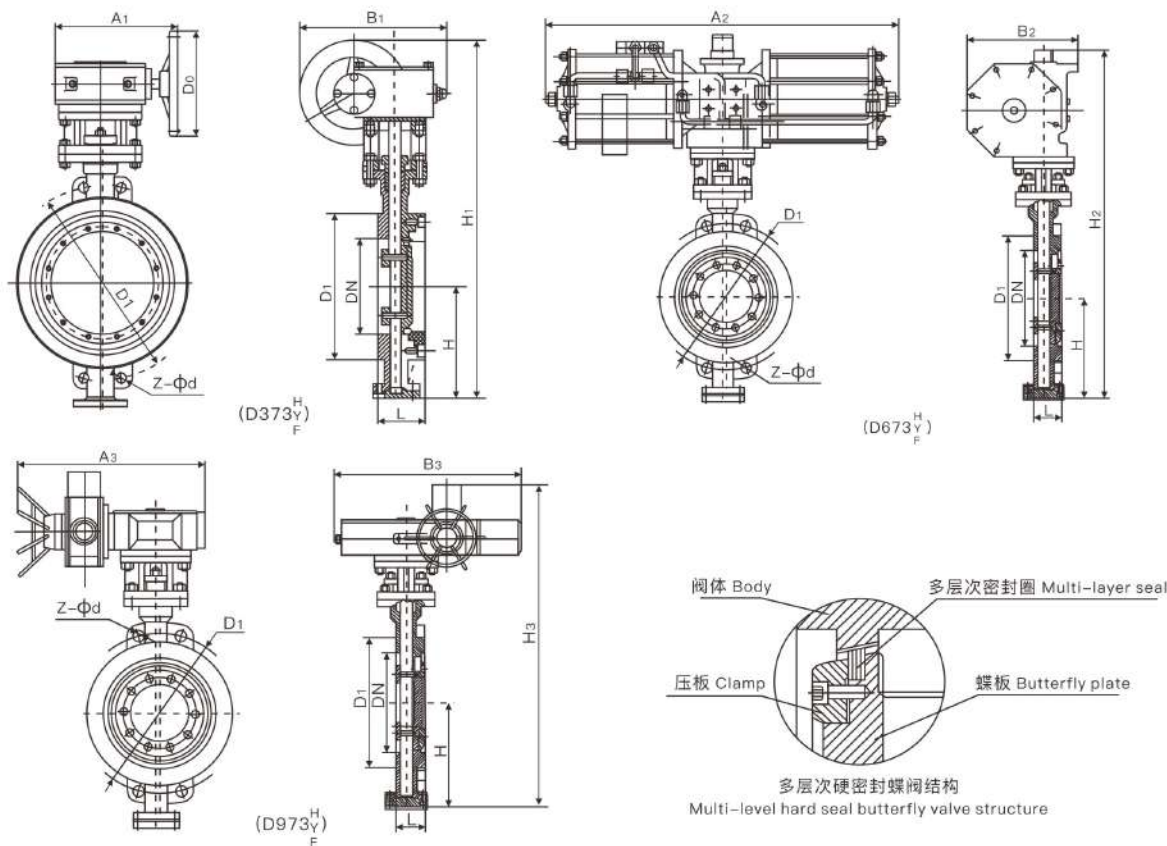

主要外形连接尺寸 Main External Connection Dimensions

PN4.0MPa

DN		L	H	D373H			D673H			D973H			PN4.0MPa	
毫米 mm	英寸 Inches			H <sub>1</sub>	A <sub>1</sub>	B <sub>1</sub>	H <sub>2</sub>	A <sub>2</sub>	B <sub>2</sub>	H <sub>3</sub>	A <sub>3</sub>	B <sub>3</sub>	D <sub>1</sub>	Z-φd
50	2	-	112	350	180	200	625	250	170	530	250	255	125	4-18
65	2 1/2	-	115	370	270	280	625	250	170	530	250	255	145	8-18
80	3	49	120	380	270	280	645	250	170	565	250	255	160	8-18
100	4	56	138	420	270	280	675	250	170	600	250	255	190	8-22
125	5	64	164	460	380	420	715	450	220	640	250	255	220	8-26
150	6	70	175	555	380	420	800	450	220	705	300	315	250	8-26
200	8	71	208	780	400	425	850	450	220	775	300	315	320	12-30
250	10	76	243	840	400	425	925	450	280	945	300	315	385	12-33
300	12	83	285	995	450	560	1035	650	280	1070	300	315	450	16-33
350	14	127	320	1050	450	560	1070	650	280	1140	300	315	510	16-36
400	16	140	350	1220	535	580	1190	650	280	1210	300	315	585	16-39
450	18	160	350	1280	535	580	-	-	-	1335	575	714	610	20-39
500	20	170	380	1365	535	580	-	-	-	1415	575	714	670	20-42

注：本表中法兰尺寸按JB/T 79标准系列1尺寸，结构长度按GB/T 12221标准。

Note: The dimensions of flanges in this table are JB/T 79 standard series 1, and the Face to Face is GB/T 12221 standard.

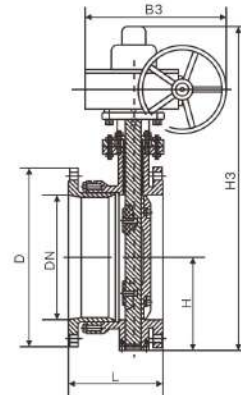
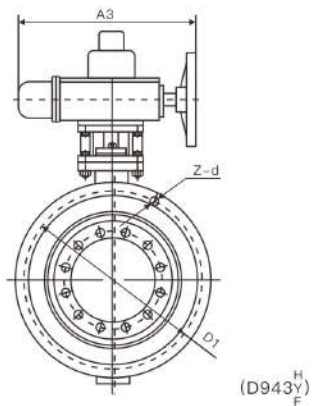
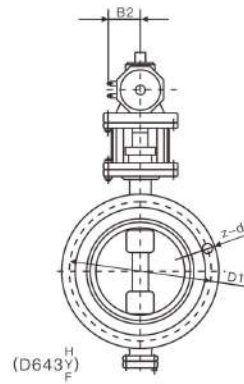
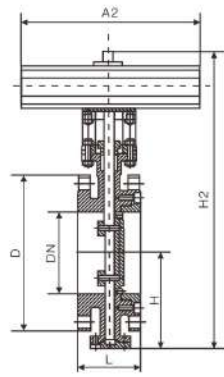
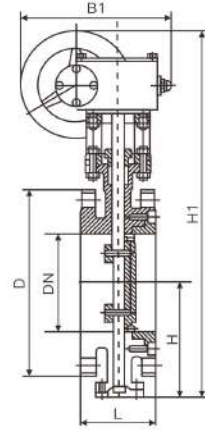
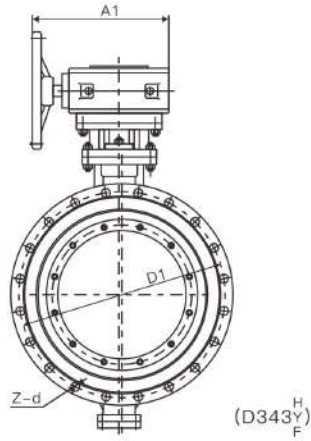

主要外形连接尺寸 Main External Connection Dimensions

PN0.25/0.6/1.0MPa

DN		L		H	D343H			D643H			D943H			PN0.25MPa			PN0.6MPa			PN1.0MPa		
毫米 mm	英寸 Inches	短 Short	长 Long		H <sub>1</sub>	A <sub>1</sub>	B <sub>1</sub>	H <sub>2</sub>	A <sub>2</sub>	B <sub>2</sub>	H <sub>3</sub>	A <sub>3</sub>	B <sub>3</sub>	D	D <sub>1</sub>	Z-φd	D	D <sub>1</sub>	Z-φd	D	D <sub>1</sub>	Z-φd
40	1 1/2	106	140	107	330	180	200	605	245	72	530	250	255	130	100	4-14	130	100	4-14	150	110	4-18
50	2	108	150	112	350	180	200	625	245	72	530	250	255	140	110	4-14	140	110	4-14	165	125	4-18
65	2 1/2	112	170	115	370	180	200	645	245	72	530	250	255	160	130	4-14	160	130	4-14	185	145	8-18
80	3	114	180	120	380	180	200	675	355	92	565	250	255	190	150	4-18	190	150	4-18	200	160	8-18
100	4	127	190	138	420	180	200	715	355	92	600	250	255	210	170	4-18	210	170	4-18	220	180	8-18
125	5	140	200	164	460	180	200	800	355	92	640	250	255	240	200	8-18	240	200	8-18	250	210	8-18
150	6	140	210	175	555	270	280	850	250	170	705	300	315	265	225	8-18	265	225	8-18	285	240	8-22
200	8	152	230	200	760	400	425	925	250	170	775	300	315	320	280	8-18	320	280	8-18	340	295	8-22
250	10	165	250	243	830	400	425	1035	450	220	945	300	315	375	335	12-18	375	335	12-18	395	350	12-22
300	12	178	270	250	895	450	560	1070	450	220	1070	300	315	440	395	12-22	440	395	12-22	445	400	12-22
350	14	190	290	280	950	450	560	1190	450	280	1140	300	315	490	445	12-22	490	445	12-22	505	460	16-22
400	16	216	310	305	1190	535	580	1250	650	280	1210	300	315	540	495	16-22	540	495	16-22	565	515	16-26
450	18	222	330	350	1255	535	580	1295	650	280	1335	575	714	595	550	16-22	595	550	16-22	615	565	20-26
500	20	229	350	380	1305	535	580	1455	850	380	1415	575	714	645	600	20-22	645	600	20-22	670	620	20-26
600	24	267	390	445	1340	570	660	1585	850	380	1605	656	810	755	705	20-26	755	705	20-26	780	725	20-30
700	28	292	430	480	1520	750	550	1700	1250	380	1844	656	810	860	810	24-26	860	810	24-26	895	840	24-30
800	32	318	470	530	1710	750	550	1865	1250	380	2040	656	810	975	920	24-30	975	920	24-30	1015	950	24-33
900	36	330	510	580	1810	750	550	2015	1500	580	2255	785	863	1075	1020	24-30	1075	1020	24-30	1115	1050	28-33
1000	40	410	550	650	1960	900	750	2226	1500	580	2380	785	863	1175	1120	28-30	1175	1120	28-30	1230	1160	28-36
1200	48	470	630	760	2250	1000	925	-	-	-	2640	785	863	1375	1320	32-30	1405	1340	32-33	1455	1380	32-39
1400	56	530	710	850	2435	1000	925	-	-	-	2886	-	-	1575	1520	36-30	1630	1560	36-36	1675	1590	36-42
1600	64	600	790	1030	2780	1000	925	-	-	-	3156	-	-	1790	1730	40-30	1830	1760	40-36	1915	1820	40-48
1800	72	670	870	1230	3020	1100	980	-	-	-	3421	-	-	1990	1930	44-30	2045	1970	44-39	2115	2020	44-48
2000	80	760	950	1350	3270	1100	980	-	-	-	3685	-	-	2190	2130	48-30	2265	2180	48-42	2325	2230	48-48

主要外形连接尺寸 Main External Connection Dimensions

PN1.6/2.5MPa

DN		L		H	D343H			D643H			D943H			PN1.6MPa			PN2.5MPa		
毫米 mm	英寸 Inches	短 Short	长 Long		H <sub>1</sub>	A <sub>1</sub>	B <sub>1</sub>	H <sub>2</sub>	A <sub>2</sub>	B <sub>2</sub>	H <sub>3</sub>	A <sub>3</sub>	B <sub>3</sub>	D	D <sub>1</sub>	Z-φd	D	D <sub>1</sub>	Z-φd
50	2	108	150	112	350	180	200	625	245	72	530	250	255	165	125	4-18	165	125	4-18
65	2 1/2	112	170	115	370	180	200	625	245	72	530	250	255	185	145	8-18	185	145	8-18
80	3	114	180	120	380	180	200	645	245	72	565	250	255	200	160	8-18	200	160	8-18
100	4	127	190	138	420	180	200	675	355	92	600	250	255	220	180	8-18	235	190	8-22
125	5	140	200	164	460	180	200	715	355	92	640	250	255	250	210	8-18	270	220	8-26
150	6	140	210	175	555	270	280	800	355	92	705	300	315	285	240	8-22	300	250	8-26
200	8	152	230	200	760	400	425	850	250	170	775	300	315	340	295	12-22	360	310	12-26
250	10	165	250	243	830	400	425	925	250	170	945	300	315	405	355	12-26	425	370	12-30
300	12	178	270	250	895	450	560	1035	450	220	1070	300	315	460	410	12-26	485	430	16-30
350	14	190	290	280	950	450	560	1070	450	220	1140	300	315	520	470	16-26	555	490	16-33
400	16	216	310	305	1190	535	580	1190	450	220	1210	300	315	580	525	16-30	620	550	16-36
450	18	222	330	350	1255	535	580	1250	650	280	1335	575	714	640	585	20-30	670	600	20-36
500	20	229	350	380	1305	535	580	1290	650	280	1415	575	714	715	650	20-33	730	660	20-36
600	24	267	390	445	1340	570	660	1455	850	380	1605	656	810	840	770	20-36	845	770	20-39
700	28	292	430	480	1520	750	550	1585	850	380	1844	656	810	910	840	24-36	960	875	24-42
800	32	318	470	530	1710	750	550	1700	1250	380	2040	656	810	1025	950	24-39	1085	990	24-48
900	36	330	510	580	1810	750	550	1865	1250	380	2255	785	863	1125	1050	28-39	1185	1090	28-48
1000	40	410	550	650	1960	900	750	2015	1250	380	2380	785	863	1255	1170	28-42	1320	1210	28-56
1200	48	470	630	760	2250	1000	925	2250	1250	380	2640	785	863	1485	1390	32-48	1530	1420	32-56
1400	56	530	710	850	2435	1000	925	-	-	-	2886	-	-	1685	1590	36-48	1755	1640	36-62
1600	64	600	790	1030	2780	1000	925	-	-	-	3156	-	-	1930	1820	40-56	1975	1860	40-62
1800	72	670	870	1230	3020	1100	980	-	-	-	3421	-	-	2130	2020	44-56	2195	2070	44-70
2000	80	760	950	1350	3270	1100	980	-	-	-	3685	-	-	2345	2230	48-62	2425	2300	48-70

注：本表中法兰尺寸按JB/T 79标准系列1尺寸，结构长度按GB/T 12221标准。

Note: The dimensions of flanges in this table are JB/T 79 standard series 1, and the Face to Face is GB/T 12221 standard.

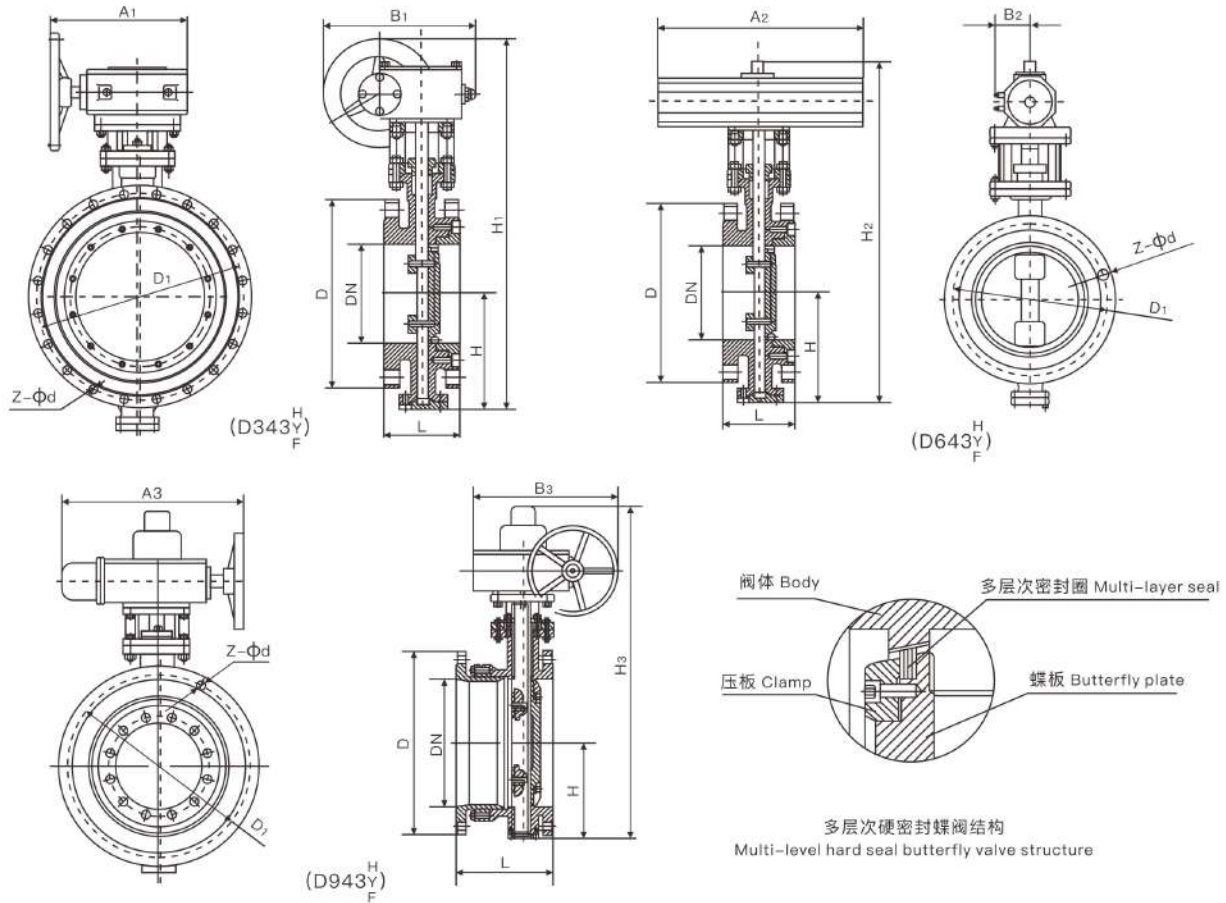

主要外形连接尺寸 Main External Connection Dimensions

PN4.0MPa

DN		L		H	D343H			D643H			D943H			PN4.0MPa		
毫米 mm	英寸 Inches	短 Short	长 Long		H <sub>1</sub>	A <sub>1</sub>	B <sub>1</sub>	H <sub>2</sub>	A <sub>2</sub>	B <sub>2</sub>	H <sub>3</sub>	A <sub>3</sub>	B <sub>3</sub>	D	D <sub>1</sub>	Z-φd
50	2	108	150	112	350	180	200	625	250	170	530	250	255	165	125	4-18
65	2 <sup>1</sup> / <sub>2</sub>	112	170	115	370	270	280	625	250	170	530	250	255	185	145	8-18
80	3	114	180	120	380	270	280	645	250	170	565	250	255	200	160	8-18
100	4	127	190	138	420	270	280	675	250	170	600	250	255	235	190	8-22
125	5	140	200	164	460	380	420	715	450	220	640	250	255	270	220	8-26
150	6	140	210	175	555	380	420	800	450	220	705	300	315	300	250	8-26
200	8	152	230	200	780	400	425	850	450	220	775	300	315	375	320	12-30
250	10	165	250	243	830	400	425	925	450	280	945	300	315	450	385	12-33
300	12	178	270	250	895	450	560	1035	650	280	1070	300	315	515	450	16-33
350	14	190	290	280	950	450	560	1070	650	280	1140	300	315	580	510	16-36
400	16	216	310	305	1190	535	580	1190	650	280	1210	300	315	660	585	16-39
450	18	222	330	350	1255	535	580	-	-	-	1335	575	714	685	610	20-39
500	20	229	350	380	1305	535	580	-	-	-	1415	575	714	755	670	20-42

注：本表中法兰尺寸按JB/T 79标准系列1尺寸，结构长度按GB/T 12221标准。

Note: The dimensions of flanges in this table are JB/T 79 standard series 1, and the Face to Face is GB/T 12221 standard.

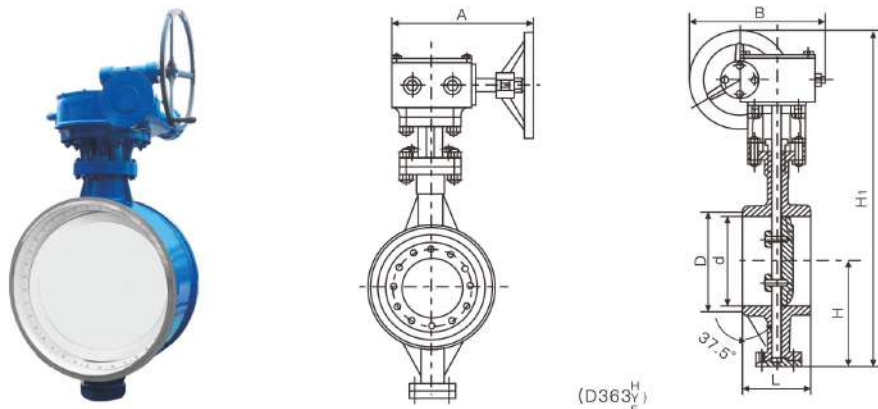

### 产品概述 Product Overview

焊接式金属硬密封蝶阀采用三偏心结构，此阀门设计在高温、高压、防火应用中是气泡级密封的理想硬密封蝶阀。由于采用焊接结构，所以阀门与管道平面达到永久的零泄漏，该焊接蝶阀没有法兰，对管道保温包扎带来了很大的方便。

Welded metal hard seal butterfly valve uses three eccentric structure, this valve design applied in high temperature and high pressure, fire prevention is an ideal hard seal butterfly valve to a level bubble. Due to the welding structure, so the valve and pipeline plane to achieve permanent zero leakage, should not have a flange welding butterfly valve, pipe insulation bandaging has brought great convenience.

### 产品用途 Production Use

焊接式金属硬密封蝶阀广泛应用于热力、石油、化工、电力、冶金、食品、医药、轻纺、造纸等行业，可安装在温度 $\leq 600^{\circ}\text{C}$ ，介质为煤气、空气、蒸汽、水、海水、油品等工业管网上作调节流量和切断介质用。

Welded metal hard seal butterfly valve is widely used in heat, oil, chemical, electric power, metallurgy, food, medicine, textile, paper and other industries, can be installed in the temperature of  $425^{\circ}\text{C}$  or less, the medium for gas, air, steam, water, sea water, oil and other industries to adjust flow and cut off the medium in pipeline.

### 产品特点 Production Features

1. 结构紧凑、体积小、重量轻、操作灵活、使用方便；
2. 采用三维偏心多层次硬密封结构，其密封性能可靠达到零泄漏；
3. 此阀无法兰，对管道的保温包扎带来很大方便和美观；
4. 具有耐高温、高压、耐腐蚀、耐磨损等特点。

1. Compact structure, small volume, light weight, flexible operation, easy to use;
2. Using three-dimensional eccentric hard sealing structure, multi-level reliable sealing performance to achieve zero leakage.
3. The valve flange, pipe insulation bandaging bring great convenience and beautiful;
4. High temperature, high pressure resistance, corrosion resistance, wear resistance, etc.

### 执行标准 Execution Standard

设计与制造 Design and manufacture	焊接尺寸 Welding size	结构长度 Face to Face	试验与检验 Test & check
GB/T12238 JB/T8527	GB/T12224	GB/T12221	GB/T113927、GB/T26480

### 主要技术参数 Main Technical Parameters

公称直径 Nominal diameter	DN(mm)	50~700				
公称压力 Nominal pressure	PN(MPa)	0.6	1.0	1.6	2.5	4.0
试验压力 (Mpa) Test pressure	强度试验 Strength test	0.9	1.5	2.4	3.75	6.0
	密封试验 Sealing test	0.66	1.1	1.76	2.75	4.4
	气密封试验 Gas seal test	0.6	0.6	0.6	0.6	0.6
适用介质 Applicable medium	水、汽、油品、酸类腐蚀性等 Water, steam, oil, acid corrosion, etc					
适用温度 Applicable temperature	碳钢 Stainless steel: $-29^{\circ}\text{C}\sim 425^{\circ}\text{C}$ 不锈钢 Carbon steel: $-40^{\circ}\text{C}\sim 600^{\circ}\text{C}$					

### 主要零件材质 Main Part Material

零件名称 Part name	材料 Material
阀体 Body	铸钢、不锈钢、铬钼钢、合金钢、双相钢 Cast steel, stainless steel, chrome molybdenum steel, alloy steel, dual phase steel
蝶板 Plate	铸钢、不锈钢、铬钼钢、合金钢、双相钢 Cast steel, stainless steel, chrome molybdenum steel, alloy steel, dual phase steel
阀座 Seat	不锈钢、堆焊司太立等硬质合金 Stainless steel, welding department is instant cemented carbide
密封圈 Seal ring	不锈钢与耐高温石棉板组合成多层次 Stainless steel and high temperature resistant asbestos board layers
阀杆 Stem	20Cr13、1Cr13不锈钢、铬钼钢、特殊材料 Stainless steel, chrome molybdenum steel, special material
轴套 Shaft	奥氏体不锈钢 Austenitic stainless steel、304氮化 Nitride
填料 Packing	柔性石墨 Flexible graphite、PTFE
填料压盖 Packing gland	铸钢、不锈钢 Cast steel, stainless steel
支架 Yoke	铸钢、不锈钢 Cast steel, stainless steel

**主要外形连接尺寸 Main Boundary Connection Dimension**

PN0.6/1.0MPa

公称压力 Nominal pressure PN0.6MPa									公称压力 Nominal pressure PN1.0MPa							
DN	外形尺寸 Boundary dimensions							WT (kg)	外形尺寸 Boundary dimensions							WT (kg)
mm	L	D	d	H	H <sub>i</sub>	A	B		L	D	d	H	H <sub>i</sub>	A	B	
600	390	636	602	499	1280	570	660	450	390	636	602	499	1280	570	660	465
700	430	726	692	566	1480	750	550	660	430	726	692	566	1480	750	550	680
800	470	826	792	632	1608	750	550	780	470	826	792	632	1608	750	550	810
900	510	926	892	693	1857	750	550	820	510	926	892	693	1857	750	550	860
1000	550	1028	992	757	2038	900	750	1460	550	1028	992	757	2038	900	750	1625
1200	630	1228	1192	851	2237	1000	925	1590	630	1228	1192	851	2237	1000	925	1770
1400	710	1428	1392	876	2411	1000	925	2185	710	1428	1392	876	2411	1000	925	2425
1600	790	1628	1592	1095	2756	1000	925	3210	790	1628	1592	1095	2756	1000	925	3560
1800	870	1828	1792	1214	3093	1100	980	4090	870	1828	1792	1214	3093	1100	980	4545
2000	950	2028	1992	1332	3355	1100	980	5610	950	2028	1992	1332	3355	1100	980	6230

**主要外形连接尺寸 Main Boundary Connection Dimension**

PN1.6MPa

公称压力 Nominal pressure PN1.6MPa									公称压力 Nominal pressure PN1.6MPa								
DN	外形尺寸 Boundary dimensions							WT (kg)	DN	外形尺寸 Boundary dimensions							WT (kg)
mm	L	D	d	H	H <sub>i</sub>	A	B		mm	L	D	d	H	H <sub>i</sub>	A	B	
80	46	90	78	90	356	180	200	27	600	390	636	602	509	1369	570	660	457
100	52	110	96	100	375	180	200	34	700	430	726	692	572	1492	750	550	810
125	56	135	121	113	401	180	200	41	800	470	826	792	638	1622	750	550	1093
150	56	161	146	130	450	270	280	43	900	510	926	892	700	1924	750	550	1410
200	60	222	202	205	545	400	425	81	1000	550	1028	992	765	2054	900	750	1870
250	68	278	254	235	630	400	425	102	1200	630	1228	1192	860	2259	1000	925	2082
300	78	330	303	275	715	450	560	132	1400	710	1428	1392	986	2610	1000	925	2850
350	78	382	351	309	817	450	560	164	1600	790	1628	1592	1106	2856	1000	925	4235
400	102	432	398	346	923	535	580	193	1800	870	1828	1792	1226	3121	1100	980	5346
450	114	484	450	392	1059	535	580	238	2000	950	2028	1992	1345	3385	1100	980	7328
500	127	535	501	427	1126	535	580	302	-	-	-	-	-	-	-	-	-

**主要外形连接尺寸 Main Boundary Connection Dimension**

PN2.5/4.0MPa

公称压力 Nominal pressure PN2.5MPa									公称压力 Nominal pressure PN4.0MPa							
DN	外形尺寸 Boundary dimensions							WT (kg)	外形尺寸 Boundary dimensions							WT (kg)
mm	L	D	d	H	H <sub>i</sub>	A	B		L	D	d	H	H <sub>i</sub>	A	B	
80	46	90	78	90	356	180	200	38	180	90	78	108	430	180	200	39
100	52	110	96	106	387	180	200	40	190	110	96	108	392	180	200	50
125	56	135	121	122	413	180	200	60	200	135	120	120	414	180	200	75
150	56	161	146	136	459	270	280	65	210	161	145	135	494	270	280	100
200	60	222	202	215	585	400	425	85	230	222	200	202	578	400	425	135
250	68	278	254	247	649	400	425	135	250	278	252	235	673	400	425	190
300	78	330	303	288	771	450	560	175	270	330	301	280	793	450	560	240
350	78	382	351	333	929	450	560	195	290	382	351	315	921	450	560	320
400	102	432	398	359	993	535	580	295	310	432	398	355	1021	535	580	450
450	114	484	450	405	1053	535	580	350	330	484	448	370	1143	535	580	500
500	127	535	501	444	1245	535	580	510	350	535	495	420	1192	535	580	560

注：本表中结构长度按GB/T 12221标准。

Note: The Face to Face in this table is in accordance with GB/T 12221 standard.

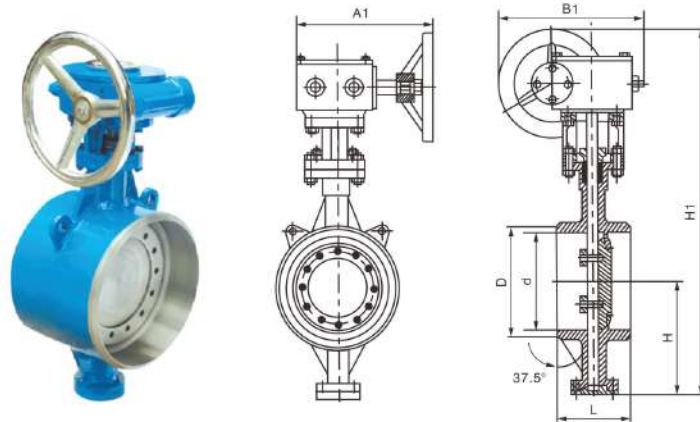

### 用途及特点 Uses and Characteristics

本蝶阀适用于高温、高压、防火、保温等管道上作启闭或调节介质之用。其主要特点如下：

- 1、结构紧凑、体积小、重量轻、操作灵活、使用方便；
- 2、采用三维偏心弹性或多层次硬密封结构，其密封性能可靠达到零泄漏；
- 3、此阀无法兰，对管道的保温包扎带来很大方便和美观；
- 4、具有耐高温、高压、耐腐蚀、耐磨损等特点。

The butterfly valve is used as opening and closing, or adjusting medium on the pipe of high temperature, high pressure and fireproof. Its main characteristics as below:

1. Tight structure, small volume, light weight, smart operation and convenient using.
2. The valve adopts triple eccentric resilience or multilayer metal seated structure to achieve zero leakage of sealing.
3. This valve doesn't have flange, so it is convenient for thermal insulation of the pipeline.
4. The valve is characterised by high temperature resistance, high pressure resistance, corrosion resistance and wear resistance, etc.

### 传动型式 Drive Type

蜗轮传动、气传动、电传动、液传动。

Worm and worm gear drive, pneumatic transmission, electric drive, hydraulic transmission

### 采用标准 Adoption Standard

焊接尺寸 Welding dimension: GB12224 ; ASME B16.25

结构长度 Face to face length: GB/T12221 ; API609

压力试验 Pressure test: GB/T13927 ; API598

### 主要技术参数 Main Technology Parameter

公称口径 Nominal Diameter	DN(mm)	50 ~ 2000				
公称压力 Nominal Pressure	PN(MPa)	0.6	1.0	1.6	2.5	4.0
试验压力 Ps(MPa) Test Pressure	强度试验 Shell test	0.9	1.5	2.4	3.75	6.0
	密封试验 Seal test	0.66	1.1	1.76	2.75	4.4
	气密封试验 Air Sealing Test	0.6	0.6	0.6	0.6	0.6
适用介质 Appropriate Medium	水、蒸气、油品、酸类腐蚀性等。Water, Steam, Oil, Acid corrosive and so on.					
适用温度 Appropriate Temperature	碳钢 Carbon steel: -29℃ ~ 425℃ 不锈钢 Stainless steel: -40℃ ~ 600℃					

### 主要零件材质 Material for Main Parts

零件名称 Parts Name	材料 Material
阀体 Body	铸钢、不锈钢、铬钼钢及特殊材料 Cast steel, stainless steel, Cr.Mo.Steel and ad hoc material
蝶板 Disc	铸钢、合金钢(镀硬铬)、不锈钢、铬钼钢及特殊材料 Cast steel, Alloy steel, stainless steel, Cr.Mo.Steel and ad hoc material
密封圈 Sealing Ring	不锈钢、抗磨材料 Stainless steel, resist grind material
阀杆 Stem	20Cr13、1Cr13不锈钢、铬钼钢 Stainless steel, Cr.Mo.Steel
填料 Packing	柔性石墨 Flexible Graphite

## 主要连接尺寸 Main Connection Dimensions

单位: Unit: mm

公称压力 PN(MPa)	公称通径 Diameter DN	L	D	H0	D363H				D963H			
					H	A	B	W(kg)	H	A	B	W(kg)
0.6	100	190	117	115	295	170	50	20	360	66	150	35
	125	200	138	130	321	260	67	29	400	66	150	44
	150	210	161	230	385	66	150	40	385	66	150	98
	200	230	222	297	471	85	170	78	471	85	170	102
	250	250	278	327	533	85	170	98	533	85	170	126
	300	270	330	364	606	106	205	130	606	106	205	172
	350	290	382	404	695	106	205	1621	694	106	205	212
	400	310	432	444	757	130	240	190	757	130	240	251
	450	330	484	472	814	155	240	232	814	155	240	342
	500	350	535	522	902	169	306	326	902	169	306	376
	600	390	636	606	1180	198	324	460	1048	198	324	528
	700	430	726	738	1460	220	335	820	1277	220	335	743
	800	470	826	801	1588	241	356	1090	1385	241	356	919
	900	510	926	989	1856	241	356	1430	1490	241	356	970
	1000	550	1028	950	1990	241	356	1476	1620	241	356	1575
	1200	630	1228	1340	2190	35	785	1605	2191	35	785	1733
	1400	710	1428	1450	2306	35	785	2190	2326	35	785	2330
	1600	790	1628	1590	2680	35	785	32515	2685	35	785	3478
	1800	870	1828	1710	2917	60	865	4100	2924	60	865	4360
	2000	950	2028	1854	2174	60	865	5700	3186	60	865	6058
2200	1000	2260	2004	3256	90	1055	7485	1620	241	356	7970	
2400	1100	2464	2130	3437	90	1055	10540	2191	35	785	11250	
2600	1200	2674	2410	3629	130	1430	10890	2326	35	785	11592	
2800	1300	2872	2590	3850	130	1430	13700	2685	35	785	14629	
3000	1400	3078	2810	4070	180	1700	14850	2924	60	865	15733	
1.0	100	190	117	115	295	170	50	20	360	66	150	35
	125	200	138	130	321	260	67	29	400	66	150	44
	150	210	161	230	385	66	150	40	385	66	150	98
	200	230	222	297	471	85	170	78	471	85	170	102
	250	250	278	327	533	85	170	98	533	85	170	126
	300	270	330	364	606	106	205	130	606	106	205	172
	350	290	382	404	694	106	205	161	694	106	205	212
	400	310	432	444	757	130	240	190	757	130	240	251
	450	330	484	472	814	155	240	232	814	155	240	342
	500	350	535	522	902	169	306	326	902	169	306	376
	600	390	636	606	1180	198	324	460	1048	198	324	533
	700	430	726	738	1460	220	335	670	1277	220	335	748
	800	470	826	801	1588	241	356	810	1385	241	356	927
	900	510	926	989	1856	241	356	850	1490	241	356	978
	1000	550	1028	950	1990	241	356	1620	1620	241	356	1770
	1200	630	1228	1340	2190	35	785	1768	2191	35	785	2195
	1400	710	1428	1450	2306	35	785	2420	2326	35	785	2695
1600	790	1628	1590	2680	35	785	3540	2685	35	785	3830	
1800	870	1828	1710	2917	60	865	4540	2924	60	865	4991	
2000	950	2028	1854	3174	60	865	6220	3186	60	865	7034	

## 主要连接尺寸 Main Connection Dimensions

单位: Unit: mm

公称压力 PN(MPa)	公称通径 Diameter DN	L	D	H0	D363H				D963H			
					H	A	B	W(kg)	H	A	B	W(kg)
1.6	100	190	117	115	295	170	50	20	360	66	150	35
	125	200	138	130	321	260	67	29	400	66	150	44
	150	210	161	230	385	66	150	40	385	66	150	102
	200	230	222	297	471	85	170	78	471	85	170	107
	250	250	278	327	533	85	170	98	533	85	170	132
	300	270	330	364	606	106	205	130	606	106	205	177
	350	290	382	404	694	106	205	161	694	106	205	218
	400	310	432	444	757	130	240	190	757	130	240	257
	450	330	484	4723	814	155	240	232	814	155	240	348
	500	350	535	522	902	169	306	326	902	169	306	382
	600	390	636	606	1180	198	324	460	1048	198	324	578
	700	430	726	738	1460	220	335	670	1277	220	335	1023
	800	470	826	801	1588	241	356	810	1385	241	356	1410
	900	510	926	989	1856	241	356	850	1490	241	356	1770
	1000	550	1028	950	1990	241	356	1620	1620	241	356	2326
	1200	630	1228	1340	2190	35	785	17689	2191	35	785	3166
	1400	710	1428	1450	2306	35	785	2420	2326	35	785	3792
	1600	790	1628	1590	2680	35	785	3540	2685	35	785	5353
1800	870	1828	1710	2917	60	865	4540	2924	60	865	6203	
2000	950	2028	1854	2174	60	865	6220	3186	60	865	8490	
2.5	100	190	117	115	295	170	50	20	360	66	150	35
	125	200	138	130	321	260	67	29	400	66	150	44
	150	210	161	230	385	66	150	91	470	66	150	102
	200	230	222	297	471	85	170	112	534	85	170	107
	250	250	278	327	533	85	170	137	566	85	170	132
	300	270	330	364	606	106	205	177	606	106	205	177
	350	290	382	404	694	106	205	198	694	106	205	218
	400	310	432	444	757	130	240	298	757	130	240	257
	450	330	484	472	814	155	240	352	814	155	240	348
	500	350	535	522	902	169	306	532	902	169	306	450
	600	390	636	606	1180	198	324	637	1048	198	324	670
	700	430	726	738	1460	220	335	947	1277	220	335	1221
	800	470	826	801	1588	241	356	1295	1385	241	356	1609
	900	510	926	989	1856	241	356	1825	1490	241	356	2140
	1000	550	1028	1053	1990	241	356	1975	1620	241	356	2442
	1200	630	1228	1162	2190	35	785	2861	2191	35	785	3531
1400	710	-	-	-	-	-	-	-	-	-	-	
1600	790	-	-	-	-	-	-	-	-	-	-	
1800	870	-	-	-	-	-	-	-	-	-	-	
2000	950	-	-	-	-	-	-	-	-	-	-	

## 主要连接尺寸 Main Connection Dimensions

单位: Unit: mm

公称压力 PN(MPa)	公称通径 Diameter DN	L	D	H0	D363H				D963H				
					H	A	B	W(kg)	H	A	B	W(kg)	
4.0	100	190	117	115	295	170	50	20	360	66	150	35	
	125	200	138	130	321	260	67	29	400	66	150	44	
	150	210	161	280	445	66	150	93	472	66	150	108	
	200	230	222	297	510	85	170	119	537	85	170	197	
	250	250	278	339	569	85	170	137	570	85	170	270	
	300	270	330	375	653	106	205	267	653	106	205	371	
	350	290	382	463	730	106	205	294	730	106	205	466	
	400	310	432	495	810	130	240	363	810	130	240	557	
	450	330	484	566	850	155	240	504	850	155	240	707	
	500	350	535	630	940	169	306	556	940	169	306	871	
	600	390	636	727	1150	198	324	908	1150	198	324	1042	
	700	430	726	780	1485	241	356	1362	1370	241	356	1367	
	800	470	826	835	1645	241	356	1618	1590	241	356	1850	
900	510	926	895	1940	35	785	2098	2140	35	785	2461		
1000	550	1028	957	2294	35	785	2370	2444	35	785	2808		
Class 150Lb	6"	150	210	161	230	385	66	150	44	385	66	150	97
	8"	200	230	222	297	471	85	170	82	471	85	170	100
	10"	250	250	278	327	533	85	170	103	533	85	170	127
	12"	300	270	330	364	606	106	205	132	606	106	205	170
	14"	350	290	382	404	694	106	205	164	694	106	205	206
	16"	400	310	432	444	757	130	240	193	757	130	240	244
	18"	450	330	484	472	814	155	240	240	814	155	240	302
	20"	500	350	535	522	902	169	306	309	902	169	306	373
	24"	600	390	636	5902	1048	198	324	460	1048	198	324	561
	28"	700	430	726	810	1277	220	335	817	1277	220	335	993
	32"	800	470	826	844	1385	241	356	1100	1385	241	356	1354
	36"	900	510	926	890	1490	241	356	1430	1490	241	356	1725
	40"	1000	550	1028	950	1620	241	356	1880	16230	241	356	2260
Class 300Lb	48"	1200	630	1228	1340	2191	35	785	2230	2191	35	785	2830
	6"	150	210	161	280	445	66	150	56	445	66	150	106
	8"	200	230	222	297	510	85	170	102	510	85	170	192
	10"	250	250	278	339	569	85	170	136	569	85	170	268
	12"	300	270	330	375	653	106	205	261	653	106	205	370
	14"	350	290	382	463	730	106	205	284	730	106	205	463
	16"	400	310	432	495	810	130	240	323	810	130	240	548
	18"	450	330	484	566	850	155	240	503	850	155	240	697
	20"	500	350	535	630	940	169	306	553	940	169	306	868
	24"	600	390	636	727	1150	198	324	904	1150	198	324	1032
	28"	700	430	736	775	-	-	-	-	1228	241	356	1268
	30"	800	470	786	780	-	-	-	-	1480	241	356	1504
	32"	900	470	826	835	-	-	-	-	1590	241	356	2035
36"	1000	510	926	895	-	-	-	-	2140	35	785	2700	
40"	1200	550	1028	957	-	-	-	-	2444	35	785	3085	

## 特点及用途 Features and usage

三偏心多层次金属硬密封蝶阀系列，系我公司新开发的长寿命、无泄漏、节能型蝶阀。产品符合国家标准JB/T8527 (金属硬密封蝶阀)、GB/T13927 (通用阀门压力试验)标准及阀门其它相关标准的规定，结合国内外先进技术，采用三维偏心原理设计，密封圈采用硬软密封兼具的多层次结构，适用于介质温度 $\leq 650^{\circ}\text{C}$ 的冶金、电力、石油化工、空气、煤气、以及给排水等介质管道上作调节流量和截断流体，密封性能可靠，是通用蝶阀向中压、中高温领域的延伸和发展。

在此结构基础上，可采用聚四氟乙烯替代多层次密封圈，形成新一代三偏心四氟密封蝶阀，广泛应用在温度 $\leq 200^{\circ}\text{C}$ 的腐蚀性介质环境中。

Three biased multi-level metals hard seal butterfly valve series, is the long life which the our company newly develops, not divulges, the energy conservation butterfly valve. The product conforms to national standard JB/T8527 (metal hard seal butterfly valve), GB/T13927 (general valve pressure test) the standard and the valve other correlation standards stipulations, unifies the domestic and foreign advanced technologies, uses the three dimensional eccentric principle design, the seal packing collar uses hard soft seals the concurrently multi-level structure, is suitable to the medium temperature  $\leq 65^{\circ}\text{C}$  metallurgy, the electric power, the petroleum chemical industry, the air, the coal gas, as well as for medium pipeline on and so on the draining water makes the adjustment current capacity and the interruption fluid, the sealing property is reliable, is the general reed valve presses, center high temperature domain extending to the center with the development.

In this structure foundation, may use the teflon to substitute the multi-level seal packing collar, forms the new generation of three biased four fluorine seals reed valve, widespread application in temperature  $\leq 200^{\circ}\text{C}$  corrosive medium environment.

## 特点 Features

- 1、蝶板密封圈为硬软多层，具有硬软密封双重密封优点，无论在低温还是高温工况下，均具有优良的密封性能。
- 2、采用三偏心结构，阀座与蝶板几乎无摩擦，具有越关越紧的密封性能，达到零泄漏。
- 3、启闭力矩小、操作灵活、活力节能，使用寿命较长。
- 4、耐高温、耐高压、耐腐蚀适用范围广。
- 5、新一代三偏心四氟密封蝶阀兼具了三偏心密封结构与软密封的优点，密封性能更加可靠，适用范围更广，使用寿命更长。
- 6、电动、气动装置采用国内外名优产品，性能更可靠(可由用户指定)。

1, The butterfly board seal packing collar for hard is soft double-decked, has the hard soft seal dual seal merit, regardless of in the low temperature or under the high temperature operating mode, has the fine sealing property.

2, Uses three eccentric structures, the valve seat and the butterfly board nearly no friction, has the pass tighter sealing property, achieved zero divulges.

3, Opens shuts the moment of force slightly, the operation nimble, the vigor energy conservation, the service life is longer.

4, Thermostable, bears the high pressure, the anti-corrosive applicable scope is broad. 5th, the new generation of three biased four fluorine seals reed valve concurrently has had three biased seals structure and the soft seal merit, the sealing property more reliable, the applicable scope broader, the service life is longer. 6th, electrically operated, the pneumatics uses the domestic and foreign famous products, the performance is more reliable (may assign by user).

## 采用标准 Applicable standard

标准所属国家 Standard respective country	制造标准 Manufacture standard	法兰标准 Flange standard	结构长度标准 Face to face standard	检验标准 Inspection standard
中国 GB	GB/T12238	GB/T9113.1	GB/T12221	GB/T13927
美国 API	API 609 ANSI B16.34	ANSI B16.5a MSS-SP-44	ANSI B16.10	API 598
日本 JIS	JIS B2064	JIS B2212	JIS B2002	FIS B2003

注：可按用户要求采用其它的标准加工产品或加工非标类蝶阀

Note: May use other standard processing products according to the user request or process the non-sign class butterfly valve

## 主要零部件材料 Material for main parts

零件名称 Parts name	零件材料 Parts material
阀体 Body	碳钢、不锈钢、铬钼钢、合金钢 Carbon steel, Stainless steel, Cr-Mo steel, Alloy steel
蝶板 Disc	碳钢、不锈钢、铬钼钢、合金钢 Carbon steel, Stainless steel, Cr-Mo steel, Alloy steel
密封圈 Seal ring	316不锈钢+柔性石墨、聚四氟乙烯 316 stainless steel+flexible graphite, Teflon
阀杆 Stem	45#、20Cr13、不锈钢、铬钼钢 Stainless steel, Cr-Mo steel
填料 Packing	柔性石墨、聚四氟乙烯 Flexible graphite, Teflon

备注Note: 铸钢: WCB, 合金钢: WC6、WC9, 铬钼钢: ZG1Cr5Mo、ZG20GrMo, 不锈钢: CF8、CF8M、CF3、CF3M

## 主要技术参数 Main technical parameter

公称通径 Nominal diameter	DN(mm)	100~3000					100~600
公称压力 Nominal pressure	PN(Mpa)	0.6	1.0	1.6	2.5	4.0	
试验压力 Test pressure	壳体强度试验 Shell structural testing	0.9	1.5	2.4	3.75	6.0	
	密封试验 Seal test	0.66	1.1	1.76	2.75	4.0	
	气密封试验 Air test	0.6	0.6	0.6	0.6	0.6	
适用介质 Applicable medium	水、蒸汽、油品、酸类腐蚀性介质等及粉尘颗粒物 Water, steam, oil quality, acids corrosive medium and so on and dust pellet						
适用温度 Applicable temperature	$-29^{\circ}\text{C} \leq$ 碳钢 Carbon steel $\leq 425^{\circ}\text{C}$ 、 $-40^{\circ}\text{C} \leq$ 不锈钢 Stainless steel $\leq 600^{\circ}\text{C}$ 、铬钼钢 Cr-Mo steel $\leq 650^{\circ}\text{C}$						
驱动形式 Actuation form	手柄、蜗轮、电动、气动 Handle, worm gear, electrically operated, air operated						

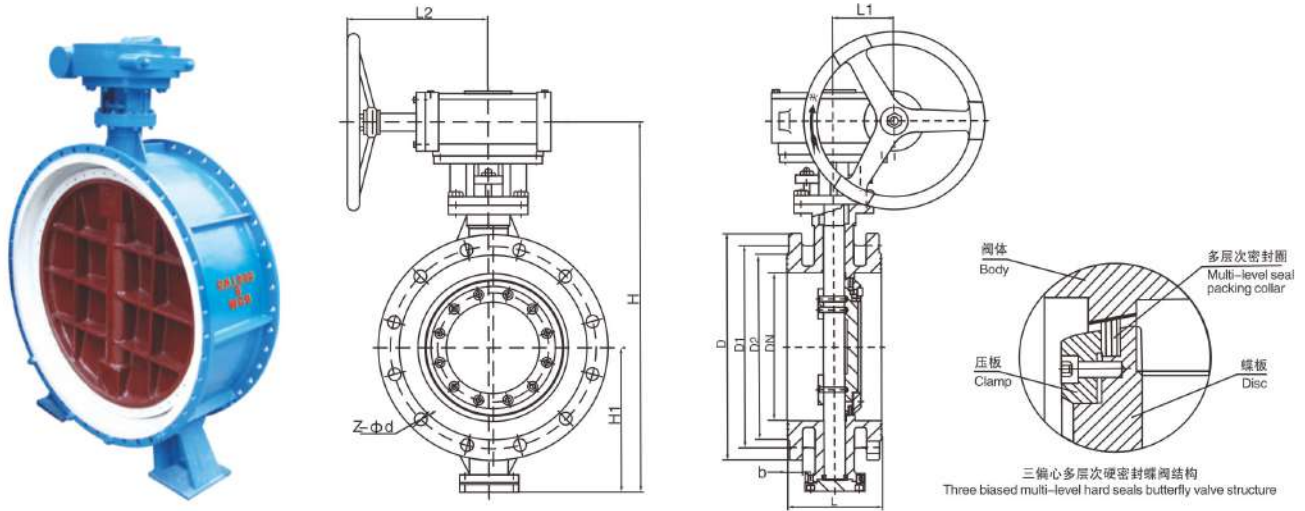

外型及连接尺寸 D343H/Y/F-PN6(DN50-3000) Contour and connection size

公称通径 DN(mm) Nominal diameter	主要外型及连接尺寸(mm) Main contour and connection size									
	L	D	D1	D2	b	H	H1	L1	L2	Z-φd
50	108	140	110	90	16	320	85	40	130	4-14
65	112	160	130	110	16	370	90	40	130	4-14
80	114	190	150	125	18	370	100	40	130	4-18
100	127	210	170	144	18	370	125	48	145	4-18
125	140	240	200	174	18	420	135	70	175	8-18
150	140	265	225	199	20	505	172	70	175	8-18
200	152	320	280	254	22	610	240	90	200	8-18
250	165	375	335	309	24	665	265	90	200	12-18
300	178	440	395	363	24	755	295	125	280	12-22
350	190	490	445	413	24	860	330	125	280	12-22
400	216	540	495	463	24	890	370	125	280	16-22
450	222	595	550	518	24	966	395	130	280	16-22
500	229	645	600	568	26	1040	430	130	280	20-22
600	267	755	705	667	30	1285	490	175	365	20-26
700	292	860	810	772	26	1395	545	175	365	24-26
800	318	975	920	878	26	1560	615	225	440	24-30
900	330	1075	1020	978	26	1700	700	225	440	24-30
1000	410	1175	1120	1078	26	1865	715	290	490	28-30
1200	470	1405	1340	1295	28	2125	865	290	490	32-33
1400	530	1630	1560	1510	32	2340	950	290	490	36-36
1600	600	1830	1760	1710	34	2580	1070	410	600	40-36
1800	670	2045	1970	1918	36	2880	1200	500	600	44-39
2000	760	2265	2180	2125	38	3200	1350	500	800	48-42
2200	590	2475	2390	2330	60	3730	1300			52-48
2400	650	2685	2600	2540	62	4300	1450			56-48
2600	700	2905	2810	2750	64	4600	1650			60-49
2800	760	3115	3020	2960	68	4900	1750			64-49
3000	810	3315	3220	3160	70	5300	1980			68-49

外型及连接尺寸 D343H/Y/F-PN10(DN50-3000) Contour and connection size

公称通径 DN(mm) Nominal diameter	主要外型及连接尺寸(mm) Main contour and connection size									
	L	D	D1	D2	b	H	H1	L1	L2	Z-φd
50	108	165	125	99	20	320	85	40	130	4-18
65	112	185	145	118	20	370	90	40	130	4-18
80	114	200	160	132	20	370	100	40	130	8-18
100	127	220	180	156	22	370	125	48	145	8-18
125	140	250	210	184	22	420	135	70	175	8-18
150	140	285	240	211	24	505	172	70	175	8-22
200	152	340	295	266	24	610	240	90	200	8-22
250	165	395	350	319	26	665	265	90	200	12-22
300	178	445	400	370	26	755	295	125	280	12-22
350	190	505	460	429	26	860	330	125	280	16-22
400	216	565	515	480	26	890	370	125	280	16-26
450	222	615	565	530	28	966	395	130	280	20-26
500	229	670	620	582	28	1040	430	130	280	20-26
600	267	780	725	682	34	1285	490	175	365	20-30
700	292	895	840	794	34	1395	545	175	365	24-30
800	318	1015	950	901	36	1560	615	225	440	24-33
900	330	1115	1050	1001	38	1700	700	225	440	28-33
1000	410	1230	1160	1112	38	1865	715	290	490	28-36
1200	470	1455	1380	1328	44	2125	865	290	490	32-39
1400	530	1675	1590	1530	48	2340	950	290	490	36-42
1600	600	1915	1820	1750	52	2580	1070	410	600	40-48
1800	670	2115	2020	1950	56	2880	1200	500	600	44-48
2000	760	2235	2230	2150	60	3200	1350	500	800	48-48
2200	590	2500	2440	2370	64	3750	1350			52-56
2400	650	2760	2650	2570	65	4350	1550			56-56
2600	700	2960	2850	2770	67	4600	1650			60-56
2800	760	3290	3050	2980	68	4900	1760			64-64
3000	810	3500	3250	3200	68	5300	1980			64-68

外型及连接尺寸 D343H/Y/F-PN16(DN50-2000) Contour and connection size

公称通径 DN(mm) Nominal diameter	主要外型及连接尺寸(mm) Main contour and connection size									
	L	D	D1	D2	b	H	H1	L1	L2	Z-φd
50	108	165	125	99	20	320	85	40	130	4-18
65	112	185	145	118	20	320	90	40	130	4-18
80	114	200	160	132	20	370	100	40	130	8-18
100	127	220	180	156	22	370	125	48	145	8-18
125	140	250	210	184	22	420	135	70	175	8-18
150	140	285	240	211	24	505	172	70	175	8-22
200	152	340	295	266	24	610	240	90	200	12-22
250	165	405	355	319	26	665	265	90	200	12-26
300	178	460	410	370	28	755	295	125	280	12-26
350	190	520	470	429	30	860	330	125	280	16-26
400	216	580	525	480	32	890	370	125	280	16-30
450	222	640	585	548	34	966	395	130	280	20-30
500	229	715	650	609	36	1040	430	130	280	20-33
600	267	840	770	720	38	1285	490	175	365	20-36
700	292	910	840	794	40	1395	545	175	365	24-36
800	318	1025	950	901	42	1560	615	225	440	24-39
900	330	1125	1050	1001	44	1700	700	225	440	28-39
1000	410	1255	1170	1112	46	1865	715	290	490	28-42
1200	470	1485	1390	1328	52	2125	865	290	490	32-48
1400	530	1685	1590	1530	58	2340	950	290	490	36-48
1600	600	1930	1820	1750	64	2580	1070	410	600	40-55
1800	670	2130	2020	1950	68	2880	1200	500	600	44-55
2000	760	2345	2230	2150	70	3200	1350	500	800	48-60

外型及连接尺寸 D343H/Y/F-PN25(DN50-2000) Contour and connection size

公称通径 DN(mm) Nominal diameter	主要外型及连接尺寸(mm) Main contour and connection size									
	L	D	D1	D2	b	H	H1	L1	L2	Z-φd
50	108	165	125	99	20	320	85	40	130	4-18
65	112	185	145	118	20	320	90	40	130	4-18
80	114	200	160	132	20	370	100	40	130	8-18
100	127	235	190	156	24	370	125	48	145	8-22
125	140	270	220	184	26	420	135	70	175	8-26
150	140	300	250	211	28	505	172	70	175	8-26
200	152	360	310	274	30	610	240	90	200	12-26
250	165	425	370	330	32	665	265	90	200	12-30
300	178	485	430	389	34	755	295	125	280	16-30
350	190	555	490	448	38	860	330	125	280	16-33
400	216	620	550	503	40	890	370	125	280	16-36
450	222	670	600	548	42	966	395	130	280	20-36
500	229	730	660	609	44	1040	430	130	280	20-36
600	267	845	770	720	46	1285	490	175	365	20-39
700	292	960	875	820	50	1395	545	175	365	24-42
800	318	1085	990	928	54	1560	615	225	440	24-48
900	330	1185	1090	1028	58	1700	700	225	440	28-48
1000	410	1320	1210	1140	62	1865	715	290	490	28-55
1200	470	1530	1420	1350	70	2125	865	290	490	32-55
1400	530	1755	1640	1560	76	2340	950	290	490	36-60
1600	600	1975	1860	1780	84	2580	1070	410	600	40-60
1800	670	2195	2070	1985	90	2880	1200	500	600	44-68
2000	760	2425	2300	2210	96	3200	1350	500	800	48-68

外型及连接尺寸 D343H/Y/F-PN40(DN50-600) Contour and connection size

公称通径 DN(mm) Nominal diameter	主要外型及连接尺寸(mm) Main contour and connection size									
	L	D	D1	D2	b	H	H1	L1	L2	Z-φd
50	108	165	125	99	20	320	110	40	130	4-18
65	112	185	145	118	20	320	110	40	130	8-18
80	114	200	160	132	20	370	120	40	130	8-18
100	190	235	190	156	24	370	142	160	223	8-22
125	200	270	220	184	26	420	157	160	223	8-26
150	210	300	250	211	28	505	192	195	230	8-26
200	230	375	320	284	34	620	255	195	230	12-30
250	250	450	385	345	38	680	270	195	300	12-33
300	270	515	450	409	42	770	350	250	635	16-33
350	290	580	510	465	46	885	375	250	635	16-36
400	310	660	585	535	50	910	420	250	635	16-39
450	330	685	610	560	57	980	440	250	635	20-39
500	350	755	670	615	57	1060	500	250	635	20-42
600	390	890	795	735	72	1315	550	295	680	20-48

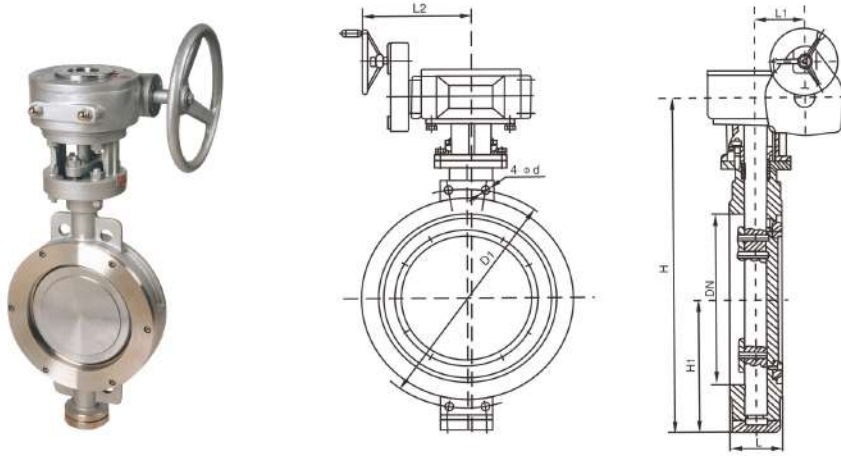

外型及连接尺寸 D373H/Y/F-PN6/10(DN50-2000) Contour and connection size

公称通径 DN(mm) Nominal diameter	主要外型及连接尺寸(mm) Main contour and connection size								
	L	H	H1	L1	L2	PN0.6MPa		PN1.0MPa	
						D1	4-Φd	D1	4-Φd
50	43	250	80	48	145	110	4-14	125	4-18
65	46	265	95	48	145	130	4-14	145	4-18
80	64	275	100	48	145	150	4-18	160	4-18
100	64	370	125	48	145	170	4-18	180	4-18
125	70	420	135	70	175	200	4-18	210	4-18
150	76	505	172	70	175	225	4-18	240	4-22
200	89	610	240	90	200	280	4-18	295	4-22
250	114	665	265	90	200	335	4-18	350	4-22
300	114	755	295	125	280	395	4-22	400	4-22
350	127	860	330	125	280	445	4-22	460	4-22
400	140	890	370	125	280	495	4-22	515	4-26
450	152	966	395	130	280	550	4-22	565	4-26
500	152	1040	430	130	280	600	4-22	620	4-26
600	154	1285	490	175	365	705	4-26	725	4-30
700	165	1395	545	175	365	810	4-26	840	4-30
800	190	1560	615	225	440	920	4-30	950	4-33
900	203	1700	700	225	440	1020	4-30	1050	4-33
1000	216	1865	715	290	490	1120	4-30	1160	4-36
1200	254	2125	865	290	490	1340	4-33	1380	4-39
1400	279	2340	950	290	490	1560	4-36	1590	4-42
1600	318	2580	1070	410	600	1760	4-36	1820	4-48
1800	356	2880	1200	500	600	1970	4-39	2020	4-48
2000	406	3200	1350	500	800	2180	4-42	2230	4-48

外型及连接尺寸 D373H/Y/F-PN16/25(DN50-2000) Contour and connection size

公称通径 DN(mm) Nominal diameter	主要外型及连接尺寸(mm) Main contour and connection size								
	L	H	H1	L1	L2	PN1.6MPa		PN2.5MPa	
						D1	4-Φd	D1	4-Φd
50	50	250	80	48	145	125	4-18	125	4-18
65	65	265	95	48	145	145	4-18	145	4-18
80	80	275	100	48	145	160	4-18	160	4-18
100	64	370	125	48	145	180	4-18	190	4-22
125	70	420	135	70	175	210	4-18	220	4-26
150	76	505	172	70	175	240	4-22	250	4-26
200	89	610	240	90	200	295	4-22	310	4-26
250	114	665	265	90	200	355	4-26	370	4-30
300	114	755	295	125	280	410	4-26	430	4-30
350	127	860	330	125	280	470	4-26	490	4-33
400	140	890	370	125	280	525	4-30	550	4-36
450	152	966	395	130	280	585	4-30	600	4-36
500	152	1040	430	130	280	650	4-33	660	4-36
600	154	1285	490	175	365	770	4-36	770	4-39
700	165	1395	545	175	365	840	4-36	875	4-42
800	190	1560	615	225	440	950	4-39	990	4-48
900	203	1700	700	225	440	1050	4-39	1090	4-48
1000	216	1865	715	290	490	1170	4-42	1210	4-55
1200	254	2125	865	290	490	1390	4-48	1420	4-55
1400	279	2340	950	290	490	1590	4-48	1640	4-60
1600	318	2580	1070	410	600	1820	4-55	1860	4-60
1800	356	2880	1200	500	600	2020	4-55	2070	4-68
2000	406	3200	1350	500	800	2230	4-60	2300	4-68

外型及连接尺寸 D373H/Y/F-PN40(DN100-600) Contour and connection size

公称通径 DN(mm) Nominal diameter	主要外型及连接尺寸(mm) Main contour and connection size						
	L	D1	H	H1	L1	L2	4-Φd
50	43	125	320	110	130	180	4-18
65	46	145	320	110	130	180	4-18
80	64	160	320	120	140	205	4-18
100	64	190	370	142	160	223	4-22
125	70	220	420	157	160	223	4-26
150	76	250	505	192	195	230	4-26
200	89	320	620	255	195	230	4-30
250	114	385	680	270	195	300	4-33
300	114	450	770	350	250	635	4-33
350	127	510	885	375	250	635	4-36
400	140	585	910	420	250	635	4-39
450	152	610	980	440	250	635	4-39
500	152	670	1060	500	250	635	4-42
600	178	795	1315	550	295	680	4-48

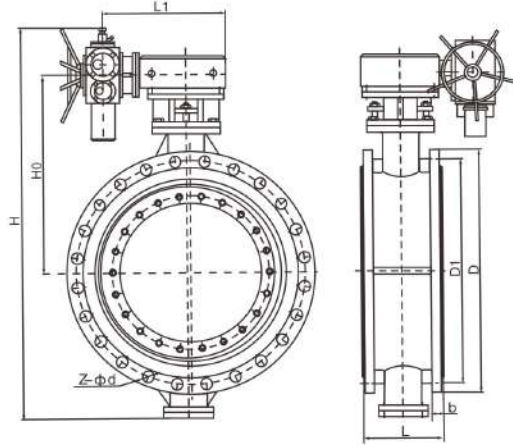

外型及连接尺寸 D943H/Y/F-PN6/10/16/25(DN50-3000) Contour and connection size

公称口径 DN(mm) Nominal diameter	主要外型及连接尺寸(mm) Main contour and connection size																			
	L	L1	H	H0	PN0.6MPa				PN1.0MPa				PN1.6MPa				PN2.5MPa			
					D	D1	b	Z-φd	D	D1	b	Z-φd	D	D1	b	Z-φd	D	D1	b	Z-φd
50	108	160	340	240	140	110	16	4-14	165	125	20	4-18	165	125	20	4-18	165	125	20	4-18
65	112	160	340	260	160	130	16	4-14	185	145	20	4-18	185	145	20	4-18	185	145	22	4-18
80	114	178	360	260	190	150	18	4-18	200	160	20	8-18	200	160	20	4-18	200	160	24	4-18
100	127	178	390	290	210	170	18	4-18	220	180	22	8-18	220	180	22	8-18	235	190	24	8-22
125	140	178	450	310	240	200	18	8-18	250	210	22	8-18	250	210	22	8-18	270	220	26	8-26
150	140	178	555	340	265	225	20	8-18	285	240	24	8-22	285	240	24	8-22	300	250	28	8-26
200	152	419	690	370	320	280	22	8-18	340	295	24	8-22	340	295	24	12-22	360	310	30	12-26
250	165	419	730	400	375	335	24	12-18	395	350	26	12-22	405	355	26	12-26	425	370	32	12-30
300	178	437	810	460	440	395	24	12-22	445	400	26	12-22	460	410	28	12-26	485	430	34	12-30
350	190	460	890	500	490	445	24	12-22	505	460	26	16-22	520	470	30	16-26	555	490	38	16-33
400	216	470	950	520	540	495	24	16-22	565	515	26	16-26	580	525	32	16-30	620	550	40	16-36
450	222	490	1050	571	595	550	24	16-22	615	565	28	20-26	640	585	34	20-30	670	600	42	20-36
500	229	510	1080	610	645	600	26	20-22	670	620	28	20-26	715	650	36	20-33	730	660	44	20-36
600	267	650	1360	795	755	705	26	20-26	780	725	34	20-30	840	770	38	20-36	845	770	46	20-39
700	292	750	1480	850	860	810	26	24-26	895	840	34	24-30	910	840	40	24-36	960	875	50	24-42
800	318	750	1600	945	975	920	26	24-30	1015	950	36	24-33	1025	950	42	24-39	1085	990	54	24-48
900	330	840	1780	1000	1075	1020	26	24-30	1115	1050	38	28-33	1125	1050	44	28-39	1185	1090	58	28-48
1000	410	840	1900	1250	1175	1120	26	28-30	1230	1160	38	28-36	1255	1170	46	28-42	1320	1210	62	28-55
1200	470	840	2270	1260	1405	1340	28	32-33	1455	1380	44	32-39	1485	1390	52	32-48	1530	1420	70	32-55
1400	530	1190	2480	1390	1630	1560	32	36-36	1675	1590	48	36-42	1685	1590	58	36-48	1755	1640	76	36-60
1600	600	1190	2690	1510	1830	1760	34	40-36	1915	1820	52	40-48	1930	1820	64	40-55	1975	1860	84	40-60
1800	670	1190	3000	1680	2045	1970	36	44-39	2115	2020	56	44-48	2130	2020	68	44-55	2195	2070	90	44-68
2000	760	1190	3400	1850	2265	2180	38	44-42	2325	2230	60	48-48	2345	2230	70	48-60	2425	2300	96	48-68
2200	590		3750		2475	2390	60	52-48	2550	2440	64	52-56								
2400	650		4350		2685	2600	62	56-48	2760	2650	65	56-56								
2600	700		4600		2905	2810	64	60-49	2960	2850	67	60-56								
2800	760		4900		3115	3020	66	64-49	3290	3050	68	64-64								
3000	810		5300		3315	3220	68	68-49	3500	3250	70	64-68								

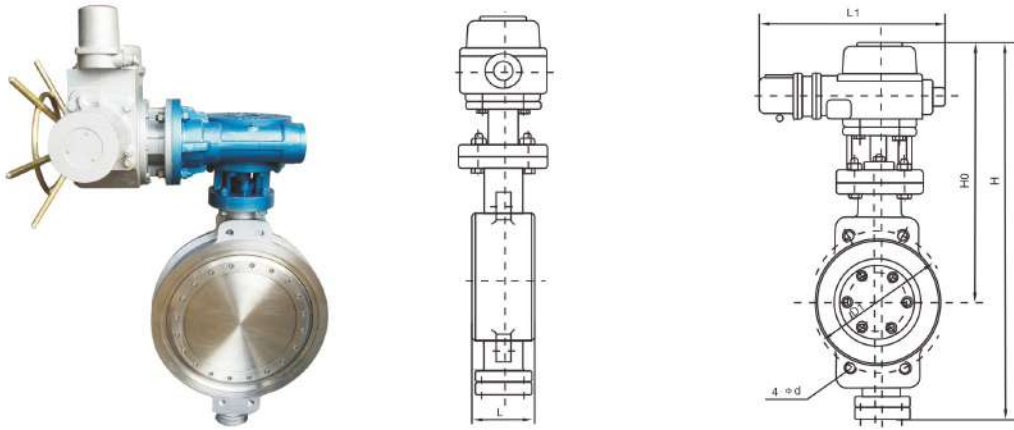

外型及连接尺寸 D973H/Y/F-PN6/10/16/25(DN50-2000) Contour and connection size

公称通径 DN(mm) Nominal diameter	主要外型及连接尺寸(mm) Main contour and connection size											
	L	L1	H	H0	PN0.6MPa		PN1.0MPa		PN1.6MPa		PN2.5MPa	
					D1	4-Φd	D1	4-Φd	D1	4-Φd	D1	4-Φd
50	50	43	340	240	110	4-14	125	4-18	125	4-18	125	4-18
65	65	46	360	260	130	4-14	145	4-18	145	4-18	145	4-18
80	80	64	360	260	150	4-18	160	4-18	160	4-18	160	4-18
100	64	178	390	290	170	4-18	180	4-18	180	4-18	190	4-22
125	70	178	450	310	200	4-18	210	4-18	210	4-18	220	4-26
150	76	178	555	340	225	4-18	240	4-22	240	4-22	250	4-26
200	89	419	690	370	280	4-18	295	4-22	295	4-22	310	4-26
250	114	419	730	400	335	4-18	350	4-22	355	4-26	370	4-30
300	114	437	810	460	395	4-22	400	4-22	410	4-26	430	4-30
350	127	460	890	500	445	4-22	460	4-22	470	4-26	490	4-33
400	140	470	950	520	495	4-22	515	4-26	525	4-30	550	4-36
450	152	490	1050	571	550	4-22	565	4-26	585	4-30	600	4-36
500	152	510	1080	610	600	4-22	620	4-26	650	4-33	660	4-36
600	154	650	1360	795	705	4-26	725	4-30	770	4-36	770	4-39
700	165	750	1480	850	810	4-26	840	4-30	840	4-36	875	4-42
800	190	750	1600	945	920	4-26	950	4-33	950	4-39	990	4-48
900	203	840	1780	1000	1020	4-30	1050	4-33	1050	4-39	1090	4-48
1000	216	840	1900	1250	1120	4-30	1160	4-36	1170	4-42	1210	4-55
1200	254	840	2270	1260	1340	4-33	1380	4-39	1390	4-48	1420	4-55
1400	279	1190	2480	1390	1560	4-33	1590	4-42	1590	4-48	1640	4-60
1600	318	1190	2690	1510	1760	4-36	1820	4-48	1820	4-55	1860	4-60
1800	356	1190	3000	1680	1970	4-39	2020	4-48	2020	4-55	2070	4-68
2000	406	1190	3400	1850	2180	4-42	2230	4-48	2230	4-60	2300	4-68

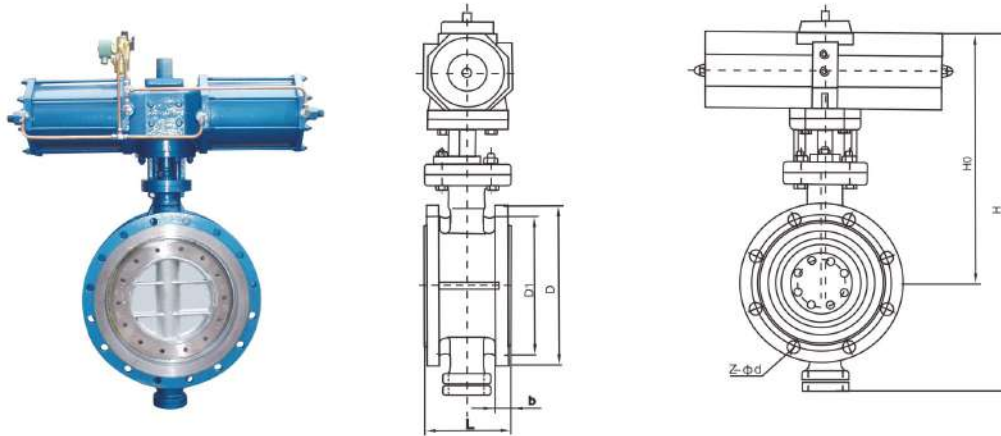

外型及连接尺寸 D643H/Y/F-PN6/10/16/25(DN50-2000) Contour and connection size

公称口径 Nominal diameter (DN)	主要外型及连接尺寸(mm) Main contour and connection size																		
	L	H	H0	PN0.6MPa				PN1.0MPa				PN1.6MPa				PN2.5MPa			
				D	D1	b	Z-Φd	D	D1	b	Z-Φd	D	D1	b	Z-Φd	D	D1	b	Z-Φd
50	108	340	240	140	110	16	4-14	165	125	20	4-18	165	125	20	4-18	165	125	20	4-18
65	112	360	260	160	130	16	4-14	185	145	20	4-18	185	145	20	4-18	185	145	22	4-18
80	114	360	260	190	150	18	4-18	200	160	20	4-18	200	160	20	4-18	200	160	24	4-18
100	127	390	290	210	170	18	4-18	220	180	22	8-18	220	180	22	8-18	235	190	24	8-22
125	140	400	300	240	200	18	8-18	250	210	22	8-18	250	210	22	8-18	270	220	26	8-26
150	140	485	340	265	225	20	8-18	285	240	24	8-22	285	240	24	8-22	300	250	28	8-26
200	152	490	360	320	280	22	8-18	340	295	24	8-22	340	295	24	12-22	360	310	30	12-26
250	165	530	390	375	335	24	12-18	395	350	26	12-22	405	355	26	12-26	425	370	32	12-30
300	178	610	440	440	395	24	12-22	445	400	26	12-22	460	410	28	12-26	485	430	34	16-30
350	190	690	480	490	445	24	12-22	505	460	26	16-22	520	470	30	16-26	555	490	38	16-33
400	216	750	520	540	495	24	16-22	565	515	26	16-26	580	525	32	16-30	620	550	40	16-36
450	222	850	600	595	550	24	16-22	615	565	28	20-26	640	585	34	20-30	670	600	42	20-36
500	229	860	620	645	600	26	20-22	670	620	28	20-26	715	650	36	20-33	730	660	44	20-36
600	267	960	680	755	705	26	20-26	780	725	34	20-30	840	770	38	20-36	845	770	46	20-39
700	292	980	740	860	810	26	24-26	895	840	34	24-30	910	840	40	24-36	960	875	50	24-42
800	318	1100	790	975	920	26	24-30	1015	950	36	24-33	1025	950	42	24-39	1085	990	54	24-48
900	330	1300	840	1075	1020	26	24-30	1115	1050	38	28-33	1125	1050	44	28-39	1185	1090	58	28-48
1000	410	1500	890	1175	1120	26	28-30	1230	1160	38	28-36	1255	1170	46	28-42	1320	1210	62	28-55

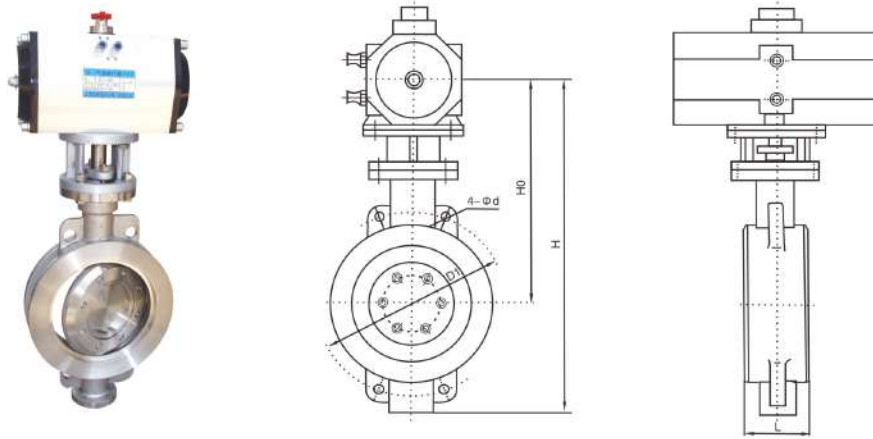

外型及连接尺寸 D673H/Y/F-PN6/10/16/25(DN50-2000) Contour and connection size

公称通径 Nominal diameter (DN)	主要外型及连接尺寸(mm) Main contour and connection size														
	L	H	H0	PN0.6MPa			PN1.0MPa			PN1.6MPa			PN2.5MPa		
				D	D1	4-φd	D	D1	4-φd	D	D1	4-φd	D	D1	4-φd
50	43	340	240	140	110	4-14	165	125	4-18	165	125	4-18	165	125	4-18
65	46	360	260	160	130	4-14	185	145	4-18	185	145	4-18	185	145	4-18
80	64	360	260	190	150	4-18	200	160	4-18	200	160	4-18	200	160	4-18
100	64	390	290	210	170	4-18	220	180	4-18	220	180	4-18	235	190	4-22
125	70	400	300	240	200	4-18	250	210	4-18	250	210	4-18	270	220	4-26
150	76	485	340	265	225	4-18	285	240	4-22	285	240	4-22	300	250	4-26
200	89	490	360	320	280	4-18	340	295	4-22	340	295	4-22	360	310	4-26
250	114	530	390	375	335	4-18	395	350	4-22	405	355	4-26	425	370	4-30
300	114	610	440	440	395	4-22	445	400	4-22	460	410	4-26	485	430	4-30
350	127	690	480	490	445	4-22	505	460	4-22	520	470	4-26	555	490	4-33
400	140	750	520	540	495	4-22	565	515	4-26	580	525	4-30	620	550	4-36
450	152	850	600	595	550	4-22	615	565	4-26	640	585	4-30	670	600	4-36
500	152	860	620	645	600	4-22	670	620	4-26	715	650	4-33	730	660	4-36
600	154	960	680	755	705	4-26	780	725	4-30	840	770	4-36	845	770	4-39
700	165	980	740	860	810	4-26	895	840	4-30	910	840	4-36	960	875	4-42
800	190	1100	790	975	920	4-30	1015	950	4-33	1025	950	4-39	1085	990	4-48
900	203	1300	840	1075	1020	4-30	1115	1050	4-33	1125	1050	4-39	1185	1090	4-48
1000	216	1500	890	1175	1120	4-30	1230	1160	4-36	1255	1170	4-42	1320	1210	4-55

普通的三偏心多层次金属硬密封的密封环由2层或2层以上的金属片和非金属片复合而成，密封环通过蝶板压环和螺栓固定安装在蝶板上。这种结构的金属硬密封蝶阀，由于受密封环上非金属片的物理及化学性能的影响，仅能适用于一般的非高温高压和非腐蚀性工况。当管道内压力较高，介质流速较快，蝶板处于部分开启或全部开启状态时，高速流体会对蝶板上的密封环产生正面冲刷，导致密封环上的非金属夹层磨损甚至脱落，极大地影响了阀门的密封性能；当管道内介质有腐蚀性时，密封环上的非金属夹层易受到介质的腐蚀，引起阀门密封面泄漏。

综合以上三偏心多层次金属硬密封蝶阀的不足，我司经过多年研发的金属硬碰硬蝶阀(又叫全金属密封蝶阀)克服了普通三偏心多层次金属硬密封蝶阀的各种不足之处，其显著特点有：

1、密封环完全由金属材料制成，不存在PTFE、石墨、橡胶石棉板等非金属材料做成的夹层，阀门在全开或是部分开启的状态下，不会因高速流体的冲刷而造成密封环的损坏，从而极大地提高了阀门使用寿命。

2、密封副部分全部采用了金属材料，能适应高温( $\leq 800^{\circ}\text{C}$ )、低温( $\geq -196^{\circ}\text{C}$ )、高压( $\leq \text{PN260/Class1500}$ )、有腐蚀性等苛刻工况。

An ordinary three eccentric, multi layer, hard metal seal ring consists of 2 or more than 2 layers of metal and nonmetal. The sealing ring is fixed on the butterfly plate through the butterfly plate, the pressure ring and the bolt. The metal hard sealing butterfly valve of the structure is only suitable for the general non high temperature, high pressure and non corrosive working conditions because of the influence of the physical and chemical properties of the non-metal sheets on the sealing ring. When the high pressure pipeline, the medium flow faster, the butterfly plate in the opening part or all of the open state, the high-speed fluid will produce a positive erosion of the sealing ring on the sealing disc, resulting in non metal sandwich ring wear or even fall off, greatly affect the sealing performance of the valve; when the pipeline medium is corrosive the sealing ring of non metal sandwich is susceptible to corrosion, caused by the leakage of the valve sealing surface.

Lack of the above three eccentric multi-level metal seal butterfly valve, after many years of our research and development of metal cutting butterfly valve (also called full metal sealing butterfly valve) overcomes various shortcomings of the ordinary three eccentric multi-level metal seal butterfly valve, its salient features are:

1, completely sealing ring is made of metal materials, there is no sandwich made of PTFE, graphite, asbestos rubber plate and other non-metallic materials, the valve in the fully open or partially open state, will not damage the sealing ring caused by high-speed fluid erosion, thereby greatly improving the service life of the valve

2, the sealing parts used in all metal materials, can adapt to high temperature ( $\leq 800^{\circ}\text{C}$ ) and low temperature ( $\geq -196^{\circ}\text{C}$ ) and high pressure ( $\leq \text{PN260/Class 1500}$ ), corrosion resistance and other harsh conditions.

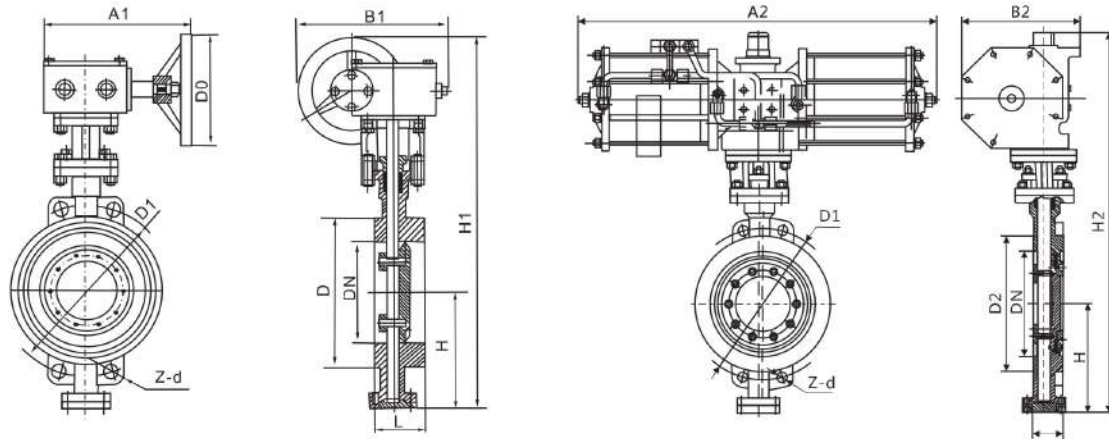

设计标准 Design standard	JB/T8527,API609,EN593,JIS B2071
结构长度 Structural length	GB/T12221,API609,EN558,JIS B2002
法兰连接尺寸 Flange size	GB/T9113,HG/T20592,JB/T79,ASMEB16.5, ASME B16.47,EN1092,GOST54432,J1S B2220
压力试验 Pressure test	GB/T13927,API598,EN12266,JIS B2003
规格范围 Specification range	DN50-2000,NPS 2-60
压力范围 Pressure range	PN1-260,150LB-1500LB,5K-30K
使用介质 Use medium	水、油品、气体及各种腐蚀性介质 Water,oil,gas and various corrosive mediums
温度范围 Temperature range	-196℃-800℃
操作方式 Operation mode	蜗轮、气动、电动、液动等 Worm gear,pneumatic,electric,hydraulic,etc

零件名称 Part name	可选材料 Optional material
阀体 Body	WCB,CF8,CF3,CF3M,CF8M,2205,2507,WC6,LCB, C95800等
蝶板 Disc	WCB,CF8,CF3,CF3M,CF8M,2205,2507,WC6,LCB, C95800等
压板圈 Clamping ring	A105,F304,F304L,F316,F316L,F51,F53,C95800等
阀杆 Stem	F6a,F304,F304L,F316,F316L,F51,F53,Monel K400/500, 17-4PH等
密封圈 Seal ring	F304,F316,F316L,S31803,S32750,S32760,Monel K400/500等
底盖 Bottom cover	Q235,F304,F304L,F316,F316L,F51,F53,C95800等
垫片 Shim	SS304+Graphite,SS316+Graphite,PTFE等
轴套 Axle sleeve	SF-1,SF-1B,SS304,SS316,SS304+PTFE,SS316+PTFE等
填料垫 Packing pad	F304,F316,F304L,F316L等
填料 Filler	Graphite,PTFE,PPL等
填料压盖 Packing gland	WCB,CF8,CF3,CF3M,CF8M,2205,2507,WC6,LCB, C95800等
螺母 Nut	B7,B8,B7M等
螺栓 Bolt	2H,8,2HM等
支架 Bracket	WCB,CF8,CF8M,Q235等

## 用途及特点Uses and Characteristics

伸缩蝶阀适用于温度 $\leq 260^{\circ}\text{C}$ ，公称压力 $\leq 1.6\text{MPa}$ 的食品、医药、化工、石油、电力、轻纺、造纸等给排水、气体管道上作调节流量和截流介质的作用，具有补偿管道热胀冷缩的功能。其主要特点如下：

- 1、设计新颖、合理、结构独特、重量轻、操作方便、启闭迅速；
- 2、伸缩蝶阀除了能作调节和截流作用、补偿管道温差所产生的热胀冷缩功能外，还有为安装更换、维修阀门提供方便；
- 3、密封部位可调节更换、密封性能可靠等特点。

Telescopic butterfly valve suitable for temperature are less than 260, nominal pressure is less than 1.6MPa of food, medicine, chemical, petroleum, electric power, textile, papermaking, water supply and drainage, gas pipes to regulate the flow and closure of the role of media, with compensation pipeline expansion and contraction function. Its main features are as follows:

1. Neoteric design, reasonable and unique structure, light weight, and quick opening and closing.
2. Telescopic valve is also convenient for installation, replacing and valve-repairing.
3. The valve has reliable sealing, and the sealing parts can be changeable.

## 主要技术参数Main Technology Parameter

公称通径 Nominal diameter	DN(mm)	50 - 2000		
公称压力 Nominal pressure	PN(MPa)	0.6	1.0	1.6
压力试验 Ps(MPa) Pressure Test	强度试验 Shell Test	0.9	1.5	2.4
	密封试验 Seal Test	0.66	1.1	1.76
	气密封试验 Air Sealing Test	0.6	0.6	0.6
适用温度 Applicable Temperature		$\leq 260^{\circ}\text{C}$		
适用介质 Applicable Media		空气、水蒸气、煤气、油品等 Air, Steam, Gas, oil etc.		
驱动形式 Operation		手动、蜗杆蜗轮传动、气传动、电传动 Manual, Worm Gear, Pneumatic, Electric		

## 主要零件材质Material for Main Parts

零件名称 Parts name	材料 Material
阀体 Body	铸钢、不锈钢、铬钼钢、合金钢 Cast iron, Cast Steel, Stainless Steel, Chrome-molybdenum Steel, Alloy Steel
蝶板 Disc	铸钢、合金钢、不锈钢、铬钼钢 Alloy Steel, Stainless Steel, Chrome-molybdenum Steel
密封圈 Seal Ring	橡胶、聚四氟、聚内脂、不锈钢 Rubber, PTFE, Polyester, Stainless Steel
阀杆 Stem	20Cr13、不锈钢、铬钼钢 20Cr13, Stainless Steel, Chrome-molybdenum Steel
伸缩管 Flexible Tube	铸钢、不锈钢、铬钼钢 Alloy Steel, Chrome-molybdenum Steel
填料 Packing	柔性石墨 Flexible Graphite

- 1、伸缩蝶阀在安装前必须平放，切勿随意磕碰。
- 2、伸缩蝶阀出厂时结构长度为最小长度，安装时，拉至安装长度(即设计长度)。
- 3、当管道间长度超过伸缩阀安装长度时，请调整管道间隔，切勿强行拉伸伸缩阀，以免损坏伸缩阀。
- 4、伸缩蝶阀可在任意位置安装，做温度补偿用时，在管道安装完成后，需沿管道轴线方向两端加支架，防止伸缩阀伸缩管拉出(见图1)，支架的承载力按下式公式计算，运行时严禁将支架卸掉。

$$F > \frac{\pi}{4} PS \cdot DN^2 \cdot (\text{kgf})$$

式中：PS-管道试验压力，DN-管道直径

- 5、伸缩蝶阀不做温度补偿时，只做安装更换、维修阀门方便时，可用通螺栓限位，对称夹紧伸缩蝶阀以防止伸缩管拉出(见图2)，损坏伸缩蝶阀及管道装置或建筑物。螺栓直径可按照法兰螺栓直径，其螺栓强度和承受试验压力及管道拉力，按上公式进行计算，运行时限位螺栓严禁卸掉(螺栓另配)

- 6、管道施工现场严禁随意拆卸解体伸缩蝶阀。

- 7、本伸缩蝶阀，加工精细，配合严密，请勿在现场随意反复拉长压短伸缩蝶阀。管道安装时，要求伸缩阀两端管道必须同心，管道上的两法兰面要求平行。

- 8、法兰固定螺栓应对称紧固，请勿单边强行紧固法兰固定螺栓。

- 9、伸缩管安装在阀门后。

- 10、伸缩阀伸缩部分不得安装在管道拐角处或管道末端。

1. Telescopic butterfly valve should be placed horizontally, any collision is not allowed.
2. When telescopic butterfly valve left factory, its face to face dimension is the minimum length. While installing, the valve should be stretched to installation length(Design Length).
3. When the space between pipelines is larger than the valve installation length, plz adjust the space between pipelines, and don't force to stretch the valve to prevent the damage of valve.
4. Telescopic butterfly valve can be installed in any position. When it used as temperature compensation, brackets should be added both ends along the axis of the pipeline to prevent the telescopic tube of the valve extends after installing the pipeline(Figure 1). It's not allowed that disassembling th bracket under working. Holding power of brackets is calculated as below:

$$F > \frac{\pi}{4} PS \cdot DN^2 \cdot (\text{kgf})$$

Note: PS stands for Pipe Test Pressure DN stands for Nominal Diameter

5. Telescopic butterfly valve can limit space through bolts when the valve is used as installation, valve-repairing and replacing. Clamp the telescopic butterfly valve tightly to prevent the stretch tube extending(Figure 2), and damaging the valve, pipe devices and buildings. Diameter of bolts can be calculated through upper formula according to the flange bolts' diameter and strength, affording test pressure and traction of pipeline. Disassembling bolts is not allowed under working(Equipped bolts).

6. It's not allowed that disboard the valve at live pipeline construction spot.

7. This product is processed minutely and working tightly, plz don't stretch the valve causally at the spot. Two flange flats is required parallel, and the both ends' pipeline of the valve should be concentric while installing the pipeline.

8. Fixed flange bolts should be symmetrically fastened, plz don't force to fasten the bolts on one side.

9. Telescopic tube should be installed as the back of the valve.

10. The stretch part of telescopic butterfly valve isn't allowed to install as the corner of the pipeline.

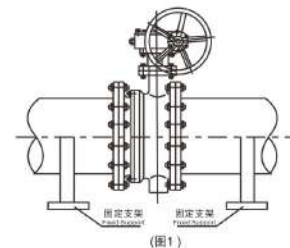

(图1)

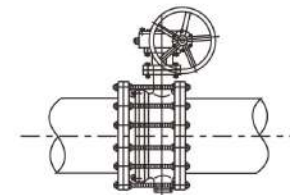

(图2)

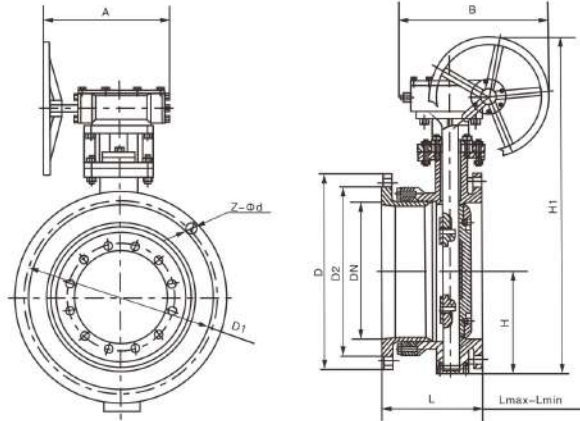

主要连接尺寸 Main Connection Dimension

单位Unit:mm

公称通径 Nominal Diameter (mm)		外形尺寸 (参考值) External Dimension(Consult)							法兰尺寸和螺栓孔尺寸 (标准值) Flange Dimension and Bolt Hole Dimension(Standard)											
		H	H1	设计 最大 长度 Design Max. Length	设计 最小 长度 Design Min. Length	设计 长度 L Design Length	A	B	0.6MPa				1.0MPa				1.6MPa			
mm	inch								D	D1	D2	Z-φd	D	D1	D2	Z-φd	D	D1	D2	Z-φd
50	2	80	309	186	156	171	180	200	140	110	88	4-14	165	125	99	4-18	165	125	99	4-18
65	2 1/2"	95	337	190	160	175	180	200	160	130	108	4-14	185	145	118	4-18	185	145	118	4-18
80	3	98	347	198	166	182	180	200	190	150	124	4-18	200	160	132	8-18	200	160	132	8-18
100	4	114	373	228	188	208	180	200	210	170	144	4-18	220	180	156	8-18	220	180	156	8-18
125	5	128	405	240	201	220	180	200	240	200	174	8-18	250	210	184	8-18	250	210	184	8-18
150	6	139	440	246	206	226	270	280	265	225	199	8-18	285	240	211	8-22	285	240	211	8-22
200	8	174	612	265	219	242	400	425	320	280	254	8-18	340	295	266	8-22	340	295	266	12-22
250	10	215	693	295	240	267	400	425	375	335	309	12-18	395	350	319	12-22	405	355	319	12-26
300	12	245	747	308	254	282	450	560	440	395	363	12-22	445	400	370	12-22	460	410	370	12-26
350	14	270	802	327	272	300	450	560	490	445	413	12-22	505	460	429	16-22	520	470	429	16-26
400	16	305	991	368	308	338	535	580	540	495	463	16-22	565	515	480	16-26	580	525	480	16-30
450	18	325	1037	370	310	340	535	580	595	550	518	16-22	615	565	530	20-26	640	585	548	20-30
500	20	360	1127	392	332	362	535	580	645	600	568	20-22	670	620	582	20-26	715	650	609	20-33
600	24	445	1377	441	375	408	570	660	755	705	667	20-26	780	725	682	20-30	840	770	720	20-36
700	28	505	1496	460	400	430	750	550	860	810	772	24-26	895	840	794	24-30	910	840	794	24-36
800	32	560	1584	499	445	475	750	550	975	920	878	24-30	1015	950	901	24-33	1025	950	901	24-39
900	36	630	1676	520	460	490	750	550	1075	1020	978	24-30	1115	1050	1001	28-33	1125	1050	1001	28-39
1000	40	680	1760	600	530	565	900	750	1175	1120	1078	28-30	1230	1160	1112	28-36	1255	1170	1112	28-42
1200	48	795	2018	675	571	623	1000	925	1405	1340	1295	32-33	1455	1380	1328	32-39	1485	1390	1328	32-48
1400	56	900	2363	760	683	722	1000	925	1630	1560	1510	36-36	1675	1590	1530	36-42	1685	1590	1530	36-48
1600	64	1100	2723	860	770	815	1000	925	1830	1760	1710	40-36	1915	1820	1750	40-48	1930	1820	1750	40-56
1800	72	1124	2844	930	830	880	1100	980	2045	1970	1718	44-39	2115	2020	1950	44-48	2130	2020	1950	44-56
2000	80	1292	3127	1020	920	970	1100	980	2265	2180	2125	48-42	2325	2230	2150	48-48	2345	2230	2150	48-62



HBD7(B, S, X, XS)41X(H)

## 用途及特点 Purpose and Characteristic

液控缓闭止回蝶阀是目前国内外较先进的管理控制设备，主要安装于水电站水轮机进口，用作水轮机进口阀；或安装于水利、电力、给排水等各类泵站的水泵出口，替代止回阀和闸阀的功能。工作时，阀门与管道主机配合，按照水力过渡过程原理，通过预设的启闭程序，有效消除管路水锤，实现管路的可靠截止，起到保护管路系统安全的作用。

本公司生产的液控缓闭止回蝶阀流阻系数小、智能化程度高、功能齐全、性能稳定可靠，是我公司设计人员在广泛搜集、研究、总结国内外同类产品性能的基础上，引入阀门、液压、电气等行业的多项研究成果，厚积而薄发，开发出来的新一代智能化高效节能产品。公司技术力量雄厚，并可根据用户的特殊要求单独进行设计，多方位满足广大用户对该类产品的需要。

该产品主要有如下特点：

- 1、可取代水泵出口处原电动闸阀和止回阀的功能，且机、电、液系统集成为一个整体，减少占地面积及基建投资。
- 2、电液控制功能齐全，无需另外配置即可以作为一个独立的系统单机就地调试、控制；也可以作为集散性控制系统(DCS)的一个设备单元，通过I/O通道由中央计算机进行集中管理，与水泵、水轮机、旁通阀及其他管道设备实现联动操作；并配有手动功能，无动力电源时也可以实现手动开、关阀，满足特殊工况下的阀门调试、控制要求。
- 3、可控性好，调节范围大、适应性强。电液控制系统设有多处调节点，可以按不同的管道控制要求进行启闭程序设置，保证在满足开、关阀条件时，阀门能够且才能够自动按预先设定的时间、角度开启和分快、慢二阶段关闭。并能实现无电关阀，有效消除破坏性水锤，防止水泵和水轮机组飞逸事故的发生，降低管网系统的压力波动，保障设备的安全可靠运行。
- 4、主阀密封副为三偏心金属或双偏心橡胶密封结构，启闭轻松、密封可靠；并有一道额外加大的偏心，使阀门具有良好的自关闭、自密封性能。中、小口径蝶阀设计面双平板桁架式结构，排挤小、水流平顺，阀门流阻系数仅为0.1~0.6，远小于止回阀的流阻系数(1.7~2.6)，节能效果明显。

The hydraulic slow-closing check butterfly valve is more advanced managing and control equipment in the world at present. It is mainly used as hydroturbine inlet valve which is installed at hydropower station, or replacing the functions of check valves and gate valves, installed as pump outlet at various pump stations, such as irrigation, electric power and water supply and drainage. In working time, valves cooperating with pipeline main engine achieve pipeline's reliable cutting off and effectively protect the pipeline system from pipeline water hammer through presupposed procedure of opening and closing.

The hydraulic slow-closing check butterfly valve is based on that our designers empolder new intelligent, high-effect and energy-saving products, widely searching, studying and concluding same type products' performance, adopted various industries research results, such as valve, hydraulic pressure and electricity, etc. Our products are characterised by small flow-resistance, high intelligence, comprehensive functions and reliable performance. Our company can design on customers' special requirements through our strong tech strength to satisfy the customers' demands.

The main characteristics of the valves are as below:

1. It can replace the function of the electric gate valve and check valve at water pump outlet, and reduce the footprint area and initial cost because the systems of electricity, liquid and machinery integrate one part.
2. Products have comprehensive functions of electric and hydraulic control, can finish local adjustment and control independently; also can be an equipment unit of Distributed Control System(DCS), can achieve linkage operation with water pump, hydroturbine, by-pass valve and other pipeline equipments by centre computer managing integrately through I/O channel.
3. Products have good controllability, great adjustable range and strong applicability. The electric and hydraulic control system is designed as many adjust points, and it can set up the procedure of opening and closing according to the different pipe control requirements, to assure the valve can open automatically according to the presupposed time and angle and close as fast or slow two stages when the condition satisfies opening and closing the valve. It can be achieved that close the valve without electricity to assure the equipment word reliably. It can effectively eliminate destructive water hammer, prevent the runaway accident of the pump and hydroturbine, and reduce the pressure fluctuation of pipe network system.
4. The secondary sealing of main valve is triple offset metal sealing or double eccentric rubber sealing structure. It is easily opening and closing, and sealing is reliable. There's an extra increasing eccentricity to make the valve have good self-sealing and closing automatically. Middle and small size disc design and double flat trussed construction make the valve little supplant and the flow smooth. The effect of energy-saving is obvious, the valve flow-resistance coefficient is only 0.1~0.6, far from the check valve flow-resistance coefficient(1.7~2.6).

## 主要性能规范 Main Performance Specification

产品标准 Product Standard	GB/T 14478、GB/T 12238、JB/T 8527	
传动装置 Transmission Device	JB/T 5299	
结构长度 Face to Face Length	GB/T 12221	
配管法兰 Pipe Flange	灰铸铁法兰 Grey Iron Flange	GB/T1724.1、GB/T1724.2
	球墨铸铁法兰 Ductile Iron Flange	GB 12380.1~12380.3
	钢制法兰 Steel Flange	GB/T 9113
蓄能器标准 Accumulator Standard	GB/T 2352	
试验与检验 Test and Inspection	GB/T 14478、GB/T 13927	
质量保证 QA	ISO9001	

注Note: 可采用其他有关标准和国外标准, 法兰尺寸可按用户要求制造, 但应在订货合同中写明。Note: It can adopt other relevant standards and foreign standards, and flange dimension can be manufacturer

## 主要技术参数 Main Technology Parameter

公称通径DN(mm) Nominal Diameter	150~4000	
公称压力PN(MPa) Nominal Pressure	0.25~4.0	
试验压力 Test Pressure PS(MPa)	密封 Seal	1.1 × PN
	强度 Strength	1.5 × PN
工作压力(MPa) Working Pressure	≤1.0 × PN	
介质温度(°C) Medium Temperature	≤80	
适用介质 Applicable Medium	清水、海水、泥沙水、油品等 Water, Sea water, Sediment, Oil etc.	

注: 1、1MPa=10.2kgf/cm<sup>2</sup>; 2、用于水电站时, 密封试验压力可按电站最高静水头计算值。For the hydropower station, the sealing test pressure can be calculated according to the maximum hydrostatic head power station.

## 启闭参数 Opening and Closing Parameters

公称通径 Nominal diameter	< 1000		≥1000
开阀时间(可调) Valve opening time (adjustable)	10~16秒(S)		20~120秒(S)
关阀时间(可调) Valve closing time (adjustable)	快关 Quick Closing	3.5~15秒(S)	4~30秒(S)
	慢关 Slow Closing	5~60秒(S)	8~90秒(S)
关阀角度(可调) Valve Closing angle (Adjustable)	快关 Quick Closing	70 ± 10°	70 ± 10°
	慢关 Slow Closing	20 ± 10°	70 ± 10°
全开位最小流阻系数 Open a Minimum Flow Resistance Coefficient	0.1		

## 主要零件材质 Material for Main Parts

零件名称 Part Name	材料 Material
阀体 Body	灰铸铁、球墨铸铁、碳素钢、镀铬铸铁 Grey Iron, Ductile Iron, Carbon Steel, Nickel Chromium Cast Iron
蝶板 Disc	灰铸铁、球墨铸铁、碳素钢、镀铬铸铁 Grey Iron, Ductile Iron, Carbon Steel, Nickel Chromium Cast iron
阀轴 Shaft	不锈钢、碳素钢 Stainless Steel, Carbon Steel
阀体密封面 Sealing Surface Of The Valve Body	铜合金、不锈钢 Copper Alloy, Stainless Steel
蝶板密封圈 Disc Seal Ring	优质丁腈橡胶、不锈钢/柔性石墨层叠 High Quality Rubber, Stainless Steel / Graphite Layers
滑动轴承 Sliding Bearing	铜合金 Copper Alloy
填料 Packing	V形密封圈、柔性石墨 V Shaped Sealing ring, Flexible Graphite
墙板 Wallboard	碳素钢 Carbon Steel

## 产品结构说明 Products Structure Description

产品按照控制系统蓄能类型分为重锤式和蓄能器式两大系列，其中重锤式控制系统又分为普通重锤式、自动保压重锤式(B)和锁定型自动保压重锤式(S)；蓄能器式控制系统则分为普通蓄能器式(X)和锁定型蓄能器式(XB)。

阀门主要由阀门本体、传动机构、液压站、电控箱等四部分组成。

阀门本体由阀体、蝶板、阀轴、滑动轴承、密封组件等主要零件组成。

重锤式阀体均采用卧式结构，阀轴采用半轴结构。

蓄能器式一般采用卧式布置；也可根据用户要求采用立式布置。

传动机构主要由液压缸、摇臂、支撑墙板(重锤式还有重锤、杠杆、锁定油缸等)等连接、传动件组成，是液压动力开、关阀门的主执行机构。

传动液压缸上设有快关时间调节阀、慢关时间调节阀和快、慢关角度调节阀。调节范围见第五节<启闭参数>。

卧式布置时，传动机构一般采用正向安装；受现场空间限制时也可根据用户要求采用反装型。

液压站包括油泵机组，手动泵、蓄能器、电磁阀、溢流阀、流量控制阀、截止阀、液压集成块、油箱等零部件。

重锤式自动保压系统中，蓄能器用作系统压力的补偿。

锁定型重锤式自动保压系统中，蓄能器作系统压力的补偿和锁定油缸的退锁蓄能器式系统中，蓄能器为阀门启闭提供主动力源。

流量控制阀用于开阀时间调节，调节范围见第五章<启闭参数>。

手动泵用于系统调节和特殊工况下的阀门启闭。

液压系统电磁换向阀控制特征一般为正作用型，即：电磁阀得电蝶阀开阀、失电蝶阀关阀；反之则为反作用型，即电磁阀失电蝶阀开阀、得电蝶阀关阀。常规配套用作水轮机进口阀时电磁换向阀为反作用型，其余工况采用正作用型，如有不同选择应在订货时说明。

液压系统与阀门本体可以是整体式安装，也可以分开安装。用户未作特殊说明时为整体式安装。蓄能器式采用立式布置时均为分体式安装。

Products in accordance with the control system energy storage type can be divided into two series: heavy hammer type and accumulator type. Heavy hammer control system is divided into ordinary heavy hammer, automatic pressure hammer type (B) and lock automatic pressure (S). Accumulator control system is divided into ordinary accumulator type (X) and lock type accumulator type (XB).

Valve is mainly composed of four parts: valve body, transmission, hydraulic station, electric control box.

Valve body is composed of body, disc, shaft, sliding bearings, sealing components and other major components.

The body of heavy hammer type valve adopts horizontal structure and the shaft adopt half axle structure.

Accumulator type valve generally adopts horizontal layout, which also can adopt vertical arrangement according to users' requirements.

Transmission mechanism is mainly composed of connections and transmission components, including the hydraulic cylinder, rocker, wall supporting (there are heavy hammer, lever, locked cylinder, etc. in heavy hammer type), which is the main valve actuator that hydraulic power open and close valve.

There are fast-closing time control valve, slow-off time control valve and fast-off & slow-off angle control valve on transmission hydraulic cylinder. The adjustment range is shown in Section 5 <Opening and closing parameters>.

As layout is horizontal, the transmission mechanism generally adopts positive installation. When limited by the space, it can also adopt anti-loaded type according to user requirements.

Hydraulic station includes oil pump unit, manual pump, accumulator, solenoid valve, relief valve, flow control valve, globe valve, hydraulic manifold, fuel tank and other parts.

In the automatic pressure maintaining system of heavy hammer type, the accumulator is used as compensation of the system pressure.

In lock-type heavy hammer automatic pressure maintaining system, the accumulator for the system pressure compensation and lock cylinder lockout accumulator system, the accumulator for the valve opening and closing to provide the main power source.

The flow control valve aims to adjust opening time of the valve, the adjustment range is shown in Section 5 <Opening and closing parameters>.

The manual pump is using to adjust the system and open and close the valve in the special working condition.

Hydraulic system electromagnetic reversing valve control features are generally positive type, that is; the solenoid valve is energized butterfly valve open, loss of power butterfly valve off valve; otherwise it is the reaction type, that is, solenoid valve power failure butterfly valve open, the butterfly valve off valve. Conventional support for the turbine inlet valve solenoid valve for the reaction type, the rest of the working conditions are positive type, if there are different options should be specified when ordering.

The hydraulic system and valve body connection can be installed as unitary and split. If the customer doesn't explain, it is installed as unitary. If the accumulator adopts vertical structure, it is installed as split.

## 电气控制方式说明 Electric Control Instruction

本阀电气控制系统按主逻辑元件类别分为普通继电型和PLC智能控制型。出厂配套一般为普通继电型，需PLC智能控制型应在订货时说明。

按液压系统类别分为普通型、B型、S型、X型、XS型等，每类中又分为离心泵、轴流泵和水轮机等使用工况。其中：

开阀离心泵(含离心式混流泵)工况：先启动泵，延迟预定时间后开阀，或泵阀同时启动。

开阀轴流泵(含轴流式混流泵)工况：先开阀至一定角度，再启动泵，或泵阀同时启动。

开阀水轮机工况：先开旁通阀平衡压力，在开阀，后运行水轮机。

各种工况一般要求在管道主机停机或控制电源失电的同时关闭阀门；也可先关阀至一定角度，在连锁停泵，或将“管道主机停机”设计成阀门关闭的充要条件。

本阀电气控制系统均配有就地控制回路和远程联动控制回路。就地控制回路主要用于现场调试，正常工作时一般均使用远程联动控制回路。

系统动力电源为AC380V，控制电源可以是AC220V、DC220V、DC110V、DC24V或其它电源等级。

电液控制原理详细说明参看我公司各类液控蝶阀产品<安装使用说明书>。

The electric control system of the valve is divided into common relay type and PLC intelligent control type. Usually common relay type is matched before leaving the factory, plz explain in order if you need PLC intelligent control type.

According to the hydraulic system, the electric control system is divided into Ordinary type, B type, S type, X type and XS type, etc. In each type, there are many working conditions, such as centrifugal pump, axial pump and hydroturbine.

Opening centrifugal pump valves (contain centrifugal mixed-flow pump) working condition: open the pump, and open the valve after delaying concerted time, or open the pump and the valve as the same time.

Opening axial pump valves (contain axial mixed-flow pump) working condition: open the valve to a fixed angle, and open the pump, or open the pump and the valve at the same time.

Opening hydroturbine working condition: open the by-pass valve to balance the pressure, and open the valve, finally open hydroturbine.

It is required that close the valve meanwhile the pipeline's main engine doesn't work and the control power is out of supplying in any working condition, or close the valve as a fixed angle, and stop the pump interlocking, or design the "pipeline main engine" as the valve closing's necessary and sufficient condition.

The electric control system of the valve is matched with local control circuit and remote linkage control circuit. Local control circuit uses to adjust at the live, normal work uses remote linkage control circuit.

用户订货时请详细说明主逻辑元件类别、液压系统类别、管道主机联动方式、换向阀控制特征、控制电源等级等具体使用工况条件。我公司可按用户的不同要求进行一定调整，并可根据用户特殊工况要求单独进行设计。

Customer should note detailed working condition, such as the type of main logic element and hydraulic system, pipeline main engine linkage method, the feature of reversing valve and control power class, etc.

Our company can adjust products according to customers' requirements, or design depending on unique working condition.

### 外形尺寸图 Appearance Size Drawing

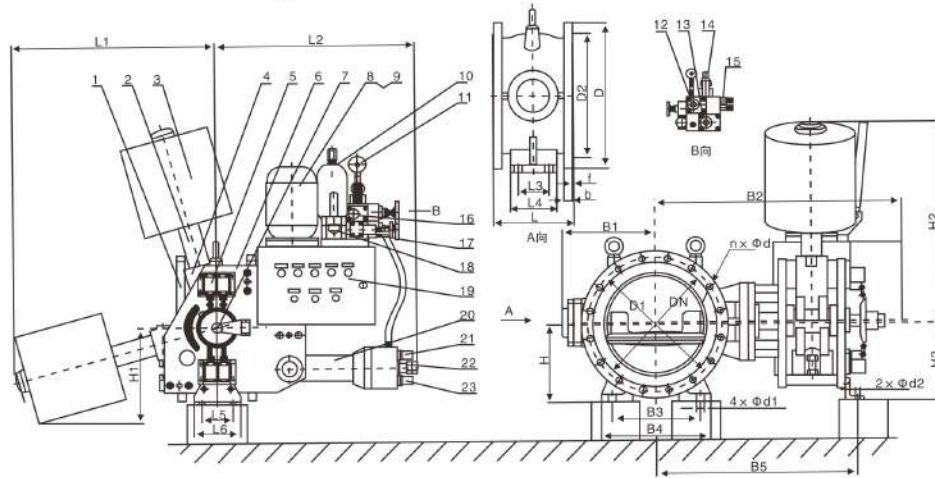

- 1、阀体 2、杠杆 3、重锤 4、摇臂 5、行程开关 6、墙板 7、开度电位器 8、电机 9、油泵 10、蓄能器  
11、耐震压力表 12、常开截止阀 13、常闭截止阀 14、电磁阀 15、压力开关 16、流量控制阀 17、溢流阀  
18、手动泵 19、电气控制箱 20、油缸 21、快关调节阀 22、快慢角度调节 23、慢关调节阀  
1、Body 2、Lever 3、Heavy Hammer 4、Rocker 5、Position Switch 6、Wallboard 7、Open Potentionmeter 8、Motor 9、Oil Pump  
10、Accumulator 11、Shock-resistant Pressure Guages 12、Normally Open Globe Valve 13、Normally Close Globe Valve  
14、Solenoid Valve 15、Pressure Switch 16、Flow Control Valve 17、Relief Valve 18、Manual Pump 19、Electric Control Box  
20、Hydrocylinder 21、Fast Closing Regulator 22、Fast-slow Angle Regulator 23、Slow Closing Regulator

自动保压重锤式液控缓闭回蝶阀外形及连接尺寸图(DN≤500)

The Appearance and Connection Size of Automatic Pressure Heavy Hammer Hydraulic Closure Check Butterfly Valve (Dn≤500)

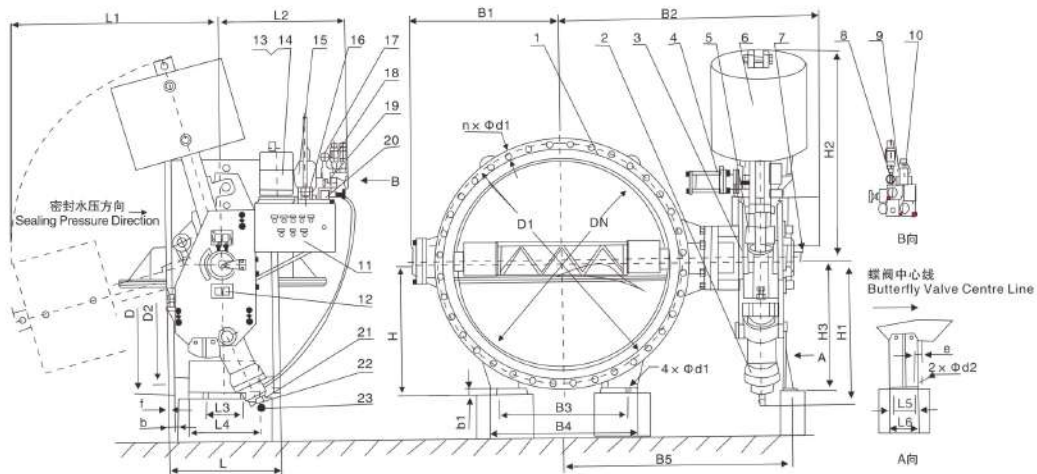

- 1、阀体 2、油缸 3、传动支架 4、摇臂 5、杠杆 6、重锤 7、开度电位器 8、常开截止阀 9、常闭截止阀  
10、电磁阀 11、压力开关 12、行程开关 13、电机 14、油泵 15、蓄能器 16、手动泵 17、压力表  
18、流量控制阀 19、溢流阀 20、电气控制箱 21、快关调节阀 22、慢关调节阀 23、快慢角度调节  
1、Body 2、Hydrocylinder 3、Transmission Bracket 4、Rocker 5、Lever 6、Heavy Hammer 7、Open Potentionmeter  
8、Normally Open Globe Valve 9、Normally Close Globe Valve 10、Solenoid Valve 11、Pressure Switch 12、Position Switch  
13、Motor 14、Oil Pump 15、Accumulator 16、Manual Pump 17、Piezometer 18、Flow Control Valve 19、Relief Valve  
20、Electric Control Box 21、Fast Closing Regulator 22、Slow Closing Regulator 23、Fast-slow Angle Regulator

自动保压重锤式液控缓闭回蝶阀外形及连接尺寸图(DN≥600)

The Appearance and Connection Size of Automatic Pressure Heavy Hammer Hydraulic Closure Check Butterfly Valve (Dn≥600)

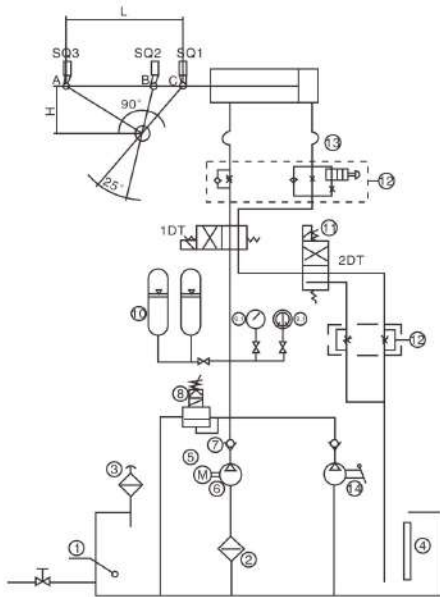

- 1、油箱 2、滤油网 3、空气滤清器 4、液位温度计 5、电机
- 6、油泵 7、单向阀 8、先导式溢流阀
- 9、电极点压力表开关压力表 10、蓄能器 11、电磁换向阀
- 12、叠加式双单节流阀 13、高压胶管 14、手动泵
- 1, fuel tank 2, filter oil network 3, air filter 4, liquid level thermometer 5, motor
- 6, oil pump 7, one-way valve 8, and pilot overflow network
- 9, electrode point pressure gauge switch, pressure gauge 10, accumulator 11, solenoid valve
- 12, stacked double single throttle valve 13, high pressure hose 14, manual pump

液控系统原理图  
Schematic diagram of hydraulic system

主要连接尺寸 Main Connection Dimension(PN0.25Mpa)

单位Unit: mm

公称 口径 DN Nominal diameter	L	D	D1	D2	b	f	n	d	L1	L2	L3	L4	L5	L6	H	H1	H2	H3	B1	B2	B3	B4	B5	b1	e	d1	d2
300	270	435	395	366	26	4	12	23	800	850	100	140	120	180	300	365	780	280	280	900	320	380	683	30	75	30	24
350	290	490	445	413	28	4	12	23	800	850	100	150	120	180	300	365	780	280	305	930	320	380	713	30	75	30	24
400	310	540	495	463	32	4	16	23	900	850	120	180	120	180	300	390	880	280	365	980	340	420	765	30	75	30	24
500	350	645	600	568	34	4	20	23	1100	850	150	220	120	180	350	443	1070	280	440	1045	400	500	830	40	75	32	24
600	390	755	705	667	35	5	20	26	1275	860	150	250	160	220	405	860	1245	610	525	1210	430	546	965	40	65	32	24
700	430	860	810	772	35	5	24	26	1275	860	180	290	160	220	460	860	1245	610	555	1250	570	700	1005	40	65	32	24
800	470	975	920	878	40	5	24	31	1275	860	180	310	160	220	520	860	1245	610	605	1300	610	740	1055	40	65	32	24
900	510	1075	1020	978	40	5	24	31	1385	860	180	320	160	220	570	935	1350	685	670	1360	700	860	1110	40	40	35	24
1000	550	1175	1120	1078	42	5	28	31	1385	860	200	360	160	220	640	935	1350	685	755	1480	740	900	1237	40	40	35	24
1200	630	1375	1320	1280	45	5	32	31	1385	860	200	360	160	220	750	935	1350	685	855	1580	790	950	1337	40	40	35	24
1300	710	1475	1420	1380	30	5	32	31	1510	870	260	460	160	220	780	1065	1475	820	935	1695	820	960	1468	40	40	42	28
1400	710	1575	1520	1480	30	5	36	31	1510	870	260	460	160	220	835	1065	1475	820	1010	1760	840	1000	1536	40	40	42	28
1500	790	1690	1630	1590	30	5	36	31	1510	870	260	500	160	220	900	1065	1475	820	1055	1800	900	1040	1572	40	40	42	28
1600	790	1790	1730	1690	32	5	40	31	1765	870	270	500	160	220	950	1075	1720	820	1120	1875	960	1140	1598	40	40	42	28
1750	870	1935	1880	1840	32	5	44	31	1765	870	270	500	160	220	1000	1075	1720	820	1175	1910	1350	1500	1682	45	40	42	28
1800	870	1990	1930	1890	34	5	44	31	1765	870	270	500	160	220	1040	1075	1720	820	1210	1940	1370	1570	1708	45	40	42	28
2000	950	2190	2130	2090	34	6	48	31	2060	910	360	600	200	280	1130	1180	1990	910	1380	2080	1370	1650	1848	45	40	42	32
2200	1000	2405	2340	2295	36	6	52	34	2060	910	360	600	200	280	1240	1180	1990	910	1480	2180	1600	1880	1948	45	40	42	32
2400	1100	2605	2540	2495	38	6	56	34	2150	910	450	800	200	280	1340	1250	2080	980	1590	2350	1740	2020	2118	45	40	42	32
2600	1200	2805	2740	2695	40	6	60	34	2150	910	500	900	200	280	1440	1250	2080	980	1770	2470	1850	2200	2238	50	40	42	32
2800	1300	3030	2960	2910	42	6	64	37	2050	910	600	950	200	280	1560	1180	1990	1050	1890	2640	2000	2400	2355	50	20	48	32
3000	1400	3230	3160	3110	42	6	68	37	2050	950	600	1000	200	280	1660	1180	1990	1050	2005	2820	2160	2560	2535	50	20	48	32
3200	1500	3430	3360	3310	44	6	72	37	2150	950	700	1100	200	280	1760	1250	2080	1180	2120	2980	2360	2760	2695	50	20	48	32
3400	1600	3630	3560	3510	46	6	76	37	2150	950	750	1200	200	280	1860	1250	2080	1180	2240	3140	2420	2920	2855	50	20	48	32
3500	1650	3730	3660	3610	48	6	78	37	2150	950	750	1200	200	280	1910	1250	2080	1180	2340	3210	2680	3180	2925	50	20	48	32

主要连接尺寸 Main Connection Dimension(PN0.6Mpa)

单位Unit: mm

DN	L	D	D1	D2	b	f	n	d	L1	L2	L3	L4	L5	L6	H	H1	H2	H3	B1	B2	B3	B4	B5	b1	d1	e	d2
300	270	440	395	363	24	4	12	23	1000	850	100	150	120	180	300	495	965	280	280	900	320	380	683	30	30	-	24
350	290	490	445	413	24	4	12	23	1000	850	100	140	120	180	320	495	965	280	305	930	320	380	713	30	30	-	24
400	310	540	495	463	24	4	16	23	1000	850	120	180	120	180	350	495	965	280	365	980	340	420	765	30	30	-	24
500	350	645	600	568	26	4	20	23	1000	850	150	220	120	180	400	495	965	280	440	1045	400	500	830	40	32	-	24
600	390	755	705	667	26	5	20	28	1400	860	150	250	160	220	460	840	1380	610	525	1210	450	550	965	40	32	65	24
700	430	860	810	772	26	5	24	28	1400	860	180	290	160	220	520	840	1380	610	555	1250	570	700	1005	40	32	65	24
800	470	975	920	878	28	5	24	31	1400	860	180	310	160	220	580	840	1380	610	605	1300	650	780	1055	40	32	65	24
900	510	1075	1020	978	28	5	24	31	1600	860	180	320	160	220	640	915	1575	685	670	1360	700	860	1110	40	35	40	24
1000	550	1175	1120	1078	30	5	28	31	1600	860	200	360	160	220	690	915	1575	685	755	1480	740	900	1237	40	35	40	24
1200	630	1405	1340	1295	30	5	32	34	1600	860	200	360	160	220	810	915	1575	685	855	1580	790	950	1337	40	35	40	24
1300	530	1520	1450	1405	32	5	32	37	1800	870	260	400	160	220	860	1035	1575	820	935	1695	820	960	1468	40	42	40	28
1400	530	1630	1560	1510	32	5	36	37	1800	870	260	400	160	220	940	1035	1575	820	1010	1760	840	1000	1536	40	42	40	28
1500	600	1730	1660	1610	34	5	36	37	1800	870	260	400	160	220	1000	1035	1575	820	1055	1800	900	1040	1572	40	42	40	28
1600	600	1830	1760	1710	34	5	40	37	2100	870	270	400	160	220	1080	1120	2050	840	1120	1875	1100	1300	1598	40	42	40	28
1750	670	1995	1920	1868	36	5	44	40	2100	870	300	500	160	220	1130	1120	2050	840	1175	1910	1350	1500	1682	45	42	40	28
1800	670	2045	1970	1918	38	5	44	40	2100	870	300	500	160	220	1130	1120	2050	840	1210	1940	1370	1570	1708	45	42	40	28
2000	760	2265	2180	2125	40	5	48	43	2300	950	360	560	200	280	1250	1255	2245	925	1380	2080	1400	1650	1848	45	42	40	32
2200	590	2475	2390	2335	42	6	52	43	2300	950	300	450	200	280	1320	1255	2245	925	1480	2180	1600	1880	1948	45	42	40	32
2400	650	2685	2600	2545	45	6	56	43	2400	950	350	500	200	280	1440	1250	2340	980	1590	2350	1740	2020	2118	45	48	40	32
2600	700	2905	2810	2750	46	6	60	49	2400	950	400	550	200	280	1520	1250	2340	980	1750	2470	1850	2200	2238	50	48	40	32
2800	760	3115	3020	2960	48	6	64	49	2400	950	500	650	200	280	1620	1255	2340	980	1850	2640	2000	2400	2355	50	48	20	32
3000	810	3315	3220	3160	50	6	68	49	2500	-	550	700	200	280	1720	1360	2435	1180	-	2820	2160	2560	2535	50	48	20	32
3200	870	3525	3430	3370	54	6	72	49	2500	-	600	750	200	280	1820	1360	2435	1180	-	2980	2360	2760	2695	50	48	20	32
3400	920	3735	3640	3580	56	6	76	49	2500	-	650	800	200	280	1920	1360	2435	1180	-	3140	2420	2920	2855	50	48	20	32
3500	920	3840	3745	3685	58	6	80	49	2500	-	650	800	200	280	1980	1360	2435	1180	-	3210	2680	3180	2925	50	48	20	32
3600	970	3970	3860	3790	62	6	80	56	-	-	700	850	-	-	2050	-	-	-	-	-	2750	3250	-	-	-	-	-
3800	1020	4180	4065	3990	66	6	80	62	-	-	750	900	-	-	2150	-	-	-	-	-	2880	3380	-	-	-	-	-
4000	1070	4380	4265	4190	70	6	84	62	-	-	800	950	-	-	2250	-	-	-	-	-	2980	3480	-	-	-	-	-

主要连接尺寸 Main Connection Dimension(PN1.0Mpa)

单位Unit: mm

DN	L	D	D1	D2	b	f	n	d	L1	L2	L3	L4	L5	L6	H	H1	H2	H3	B1	B2	B3	B4	B5	b1	d1	e	d2
300	270	445	400	370	26	4	12	23	1000	850	100	150	120	180	300	495	965	280	280	900	320	380	683	30	30	-	24
350	290	505	460	429	28	4	16	23	1000	850	100	140	120	180	320	495	965	280	305	930	320	380	713	30	30	-	24
400	310	565	515	480	32	4	16	28	1000	850	120	180	120	180	350	495	965	280	365	980	340	420	765	30	30	-	24
500	350	670	620	582	34	4	20	28	1400	850	150	220	120	180	400	840	1380	610	440	1045	400	500	830	40	32	-	24
600	390	780	725	682	35	5	20	31	1400	860	150	250	160	220	460	840	1380	610	525	1210	450	550	965	40	32	65	24
700	430	895	840	794	35	5	24	31	1400	860	180	290	160	220	520	840	1380	610	555	1250	570	700	1005	40	32	65	24
800	470	1015	950	901	40	5	24	34	1400	860	180	310	160	220	580	840	1380	610	605	1300	650	780	1055	40	32	65	24
900	510	1115	1050	1001	40	5	28	34	1600	860	180	320	160	220	640	915	1575	685	670	1360	700	860	1110	40	35	40	24
1000	550	1230	1160	1112	42	5	28	37	1600	860	200	360	160	220	690	915	1575	685	755	1480	740	900	1237	40	35	40	24
1100	550	1340	1270	1222	42	5	28	37	1600	860	200	360	160	220	750	915	1575	685	805	1530	760	920	1287	40	35	40	24
1200	630	1455	1380	1328	45	5	32	40	1800	870	200	360	160	220	810	1030	1755	820	855	1630	790	950	1378	40	35	40	24
1250	530	1505	1430	1378	45	5	32	40	1800	870	200	360	160	220	810	1030	1755	820	910	1670	1140	1280	1442	40	42	40	24
1300	530	1575	1490	1425	45	5	32	43	1800	870	260	400	160	220	860	1030	1755	820	935	1695	820	960	1468	40	42	40	28
1400	530	1675	1590	1530	46	5	36	43	2100	870	260	400	160	220	940	1120	2050	840	1010	1760	840	1000	1536	40	42	40	28
1500	600	1785	1700	1640	46	5	36	49	2100	870	260	400	160	220	1000	1120	2050	840	1055	1800	900	1040	1572	40	42	40	28
1600	600	1915	1820	1750	50	5	40	49	2100	870	270	400	160	220	1080	1120	2050	840	1120	1875	1100	1300	1598	40	42	40	28
1750	670	2065	1970	1900	50	5	44	49	2300	950	300	500	200	280	1130	1255	2230	925	1175	1980	1350	1500	1752	45	42	40	32
1800	670	2115	2020	1950	52	5	44	49	2300	950	300	500	200	280	1130	1255	2230	925	1210	2010	1370	1570	1778	45	42	40	32
2000	760	2325	2230	2150	54	5	48	49	2400	950	360	560	200	280	1250	1255	2340	980	1380	2180	1400	1650	1948	45	48	40	32
2200	590	2550	2440	2370	58	6	52	56	2400	950	300	450	200	280	1320	1255	2340	980	1480	2280	1600	1880	2048	45	48	40	32
2250	590	2600	2490	2420	60	6	52	56	2400	950	300	450	200	280	1330	1255	2340	980	1510	2310	1600	1880	2078	45	48	40	32
2400	650	2760	2650	2570	65	6	56	56	2550	950	350	500	200	280	1440	1360	2435	1180	1590	2350	1740	2020	2118	45	48	40	32
2600	700	2960	2850	2780	66	6	60	56	2400	950	400	550	200	280	1520	1250	2340	980	1750	2470	1850	2200	2238	50	48	40	32
2850	760	3180	3070	3000	70	6	64	56	2400	950	500	650	200	280	1620	1255	2340	980									

主要连接尺寸 Main Connection Dimension(PN1.6Mpa)

单位Unit: mm

DN	L	D	D1	D2	b	f	n	d	L1	L2	L3	L4	L5	L6	H	H1	H2	H3	B1	B2	B3	B4	B5	b1	d1	e	d2
300	270	460	410	375	26	4	12	27	1000	850	100	150	120	180	300	495	965	280	280	900	320	380	683	30	30	-	24
350	290	520	470	429	28	4	16	27	1000	850	100	140	120	180	320	495	965	280	305	930	320	380	713	30	30	-	24
400	310	580	525	480	32	4	16	31	1000	850	120	180	120	180	350	495	965	280	365	980	340	420	765	30	30	-	24
500	350	715	650	609	34	4	20	34	1400	860	150	220	120	180	400	840	1380	610	440	1045	400	500	830	40	32	65	24
600	390	840	770	720	35	5	20	37	1400	860	150	250	160	220	460	840	1380	610	525	1210	450	550	965	40	32	65	24
700	430	910	840	794	35	5	24	37	1600	860	180	290	160	220	520	915	1575	685	555	1250	570	700	1005	40	32	40	24
800	470	1025	950	901	40	5	24	40	1600	860	180	310	160	220	580	915	1575	685	605	1300	650	780	1055	40	32	40	24
900	510	1125	1050	1001	40	5	28	40	1600	860	180	320	160	220	640	915	1575	685	670	1360	700	860	1110	40	35	40	24
1000	550	1255	1170	1112	42	5	28	43	1800	870	200	360	160	220	690	1030	1755	820	755	1530	740	900	1287	40	35	40	24
1100	550	1370	1280	1222	42	5	28	43	1800	870	200	360	160	220	750	1030	1755	820	805	1580	760	920	1337	40	35	40	24
1200	630	1485	1390	1328	45	5	32	49	1800	870	200	360	160	220	810	1030	1755	820	855	1630	790	950	1387	40	35	40	24
1250	530	1535	1440	1378	46	5	32	49	1800	870	200	360	160	220	810	1030	1755	820	910	1670	1140	1280	1442	40	42	40	24
1300	530	1585	1490	1425	50	5	32	49	2100	870	260	400	160	220	860	1120	2050	840	935	1695	820	960	1468	40	42	40	28
1400	530	1685	1590	1530	54	5	36	49	2100	870	260	400	160	220	940	1120	2050	840	1010	1760	840	1000	1536	40	42	40	28
1500	600	1820	1710	1640	54	5	36	49	2100	870	260	400	160	220	1000	1120	2050	840	1055	1800	900	1040	1572	40	42	40	28
1600	600	1930	1820	1750	56	5	40	56	2300	950	270	400	200	280	1080	1255	2230	925	1120	1945	1100	1300	1668	40	42	40	32
1750	670	2080	1970	1900	60	5	44	56	2300	950	270	500	200	280	1130	1255	2230	925	1175	1980	1350	1500	1752	45	42	40	32
1800	670	2130	2020	1950	60	5	44	56	2300	950	270	500	200	280	1130	1255	2230	925	1210	2010	1370	1570	1778	45	42	40	32
2000	760	2345	2230	2150	65	5	48	62	2400	910	360	560	200	280	1250	1255	2340	980	1380	2180	1370	1650	1948	45	48	40	32
2200	590	2555	2440	2360	70	6	52	62	2400	910	300	450	200	280	1320	1255	2340	980	1480	2280	1600	1880	2048	45	48	40	32
2250	590	2605	2490	2410	70	6	52	62	2400	910	300	450	200	280	1330	1255	2340	980	1510	2310	1600	1880	2078	45	48	40	32

主要连接尺寸 Main Connection Dimension(PN2.5Mpa)

单位Unit: mm

DN	L	D	D1	D2	b	f	n	d	L1	L2	L3	L4	L5	L6	H	H1	H2	H3	B1	B2	B3	B4	B5	b1	d1	e	d2
300	270	485	430	389	34	4	16	31	1000	850	100	150	120	180	300	495	965	280	280	838	320	380	683	30	30	-	24
350	290	555	490	448	38	4	16	34	1000	850	100	150	120	180	320	495	965	280	305	868	320	380	713	30	30	-	24
400	310	620	550	503	40	4	16	37	1400	860	120	180	160	220	350	840	1380	610	365	970	340	420	815	30	32	65	24
500	350	730	660	609	44	4	20	37	1400	860	150	220	160	220	400	840	1380	610	440	1090	400	500	880	40	32	65	24
600	390	845	770	720	46	5	20	40	1600	860	150	250	160	220	460	915	1575	685	525	1210	450	550	965	40	35	40	24
700	430	960	875	820	50	5	24	43	1600	860	180	290	160	220	520	915	1575	685	555	1300	570	700	1005	40	35	40	24
800	470	1085	990	928	54	5	24	49	1600	860	180	310	160	220	580	915	1575	685	605	1350	650	780	1055	40	35	40	24
900	510	1185	1090	1028	58	5	28	49	1800	870	180	320	160	220	640	1030	1755	820	670	1410	700	860	1160	40	42	40	24
1000	550	1320	1210	1140	62	5	28	56	2100	870	200	360	160	220	690	1120	2050	840	755	1535	740	900	1287	40	42	40	24
1100	550	1425	1315	1245	65	5	28	56	2100	870	200	360	160	220	750	1120	2050	840	805	1580	760	920	1337	40	42	40	24
1200	630	1530	1420	1350	70	5	32	56	2100	870	200	360	160	220	810	1120	2050	840	855	1630	790	950	1387	40	42	40	24
1250	530	1575	1470	1400	70	5	32	56	2100	870	200	360	160	220	810	1120	2050	840	910	1740	1140	1280	1442	40	42	40	24
1300	530	1640	1530	1450	74	5	32	62	2100	870	260	400	160	220	860	1120	2050	840	935	1765	820	960	1468	40	42	40	28
1400	530	1755	1640	1560	76	5	36	62	2300	950	260	400	200	280	940	1255	2230	925	1010	1830	840	1000	1606	40	42	40	32
1500	600	1865	1750	1670	80	5	36	62	2300	950	260	400	200	280	1000	1255	2230	925	1055	1870	900	1040	1645	40	42	40	32
1600	600	1975	1860	1780	84	5	40	62	2300	950	270	400	200	280	1080	1255	2230	925	1120	1945	1100	1300	1668	40	42	40	32
1750	670	2145	2020	1935	90	5	44	70	2400	950	270	500	200	280	1130	1255	2340	980	1175	2035	1350	1500	1832	45	48	40	32
1800	670	2195	2070	1985	90	5	44	70	2400	950	270	500	200	280	1130	1255	2340	980	1210	2065	1370	1570	1858	45	48	40	32

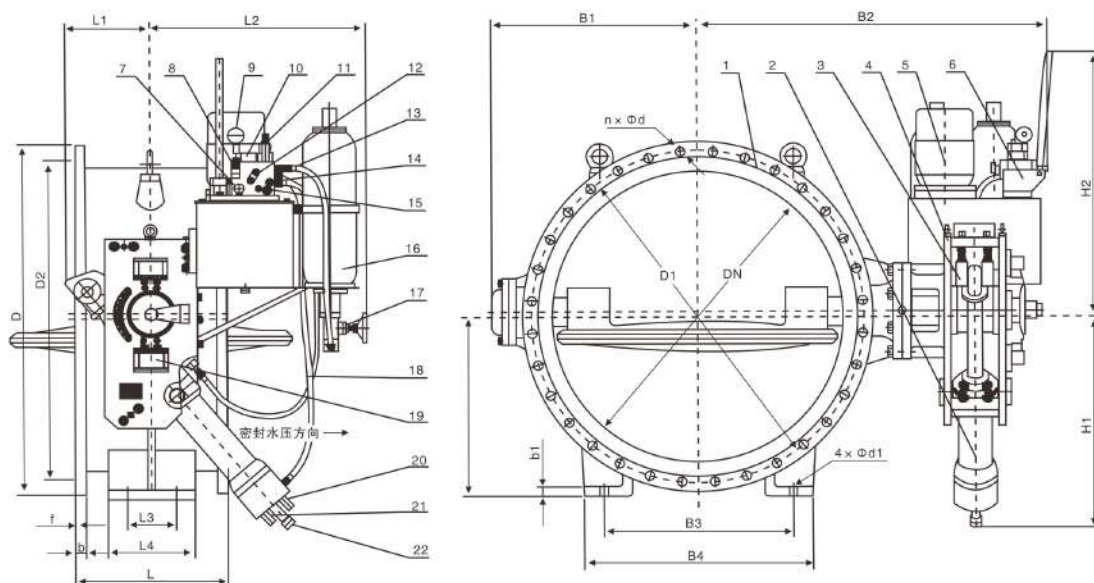

- 1、阀体 2、油缸 3、摇臂 4、支架 5、油泵电机 6、手动泵 7、流量控制阀 8、压力控制器 9、压力表  
10、插装阀 11、电磁阀(一) 12、电磁阀(二) 13、截止阀 14、单向阀 15、溢流阀 16、蓄能器  
17、蓄能器截止阀 18、高压软管 19、行程开关 20、快关调节阀 21、慢关调节阀 22、快慢角度调节  
1, valve 2, cylinder 3, rocker 4, support 5, oil pump motor 6, manual pump 7, flow control valve 8, pressure controller 9, pressure gauge  
10, cartridge valve 11, solenoid valve (12), solenoid valve (two) 13, stop valve 14, one-way valve 15, relief valve 16, accumulator  
17. Accumulator, stop valve 18, high pressure hose 19, trip switch 20, quick closing control valve 21, slow closing control valve 22, speed angle adjustment

蓄能器式液控缓闭止回蝶阀外形尺寸图  
energy storage type hydraulic control slow closing butterfly valve size drawing

### 主要连接尺寸 Main Connection Dimension(PN0.25Mpa)

单位Unit: mm

DN	L	D	D1	D2	b	f	n	d	L1	L2	L3	L4	H	H1	H2	B1	B2	B3	B4	b1	d1
300	270	435	395	366	20	4	12	23	210	705	100	150	300	650	860	280	765	320	380	30	30
350	290	490	445	413	2	4	12	23	210	705	100	140	320	650	860	305	810	320	380	30	30
400	310	540	495	463	24	4	16	23	210	705	120	180	350	650	860	365	860	340	420	30	30
500	350	645	600	568	26	4	20	23	235	740	150	220	400	730	1020	440	1016	400	500	40	32
600	390	755	705	667	26	5	20	26	235	740	150	250	460	730	1020	525	1066	450	550	40	32
700	430	860	810	772	26	5	24	26	235	740	180	290	520	730	1020	555	1080	570	700	40	32
800	470	975	920	878	26	5	24	31	235	740	180	310	580	730	1020	605	1240	650	780	40	32
900	510	1075	1020	978	28	5	24	31	380	890	180	320	640	960	1160	670	1310	700	860	40	35
1000	550	1175	1120	1078	30	5	28	31	380	890	200	360	690	960	1160	755	1360	740	900	40	35
1200	630	1375	1320	1280	30	5	32	31	380	890	200	360	810	960	1160	855	1500	790	950	40	35
1300	530	1475	1420	1380	30	5	32	31	380	890	260	400	860	960	1160	935	1565	820	960	40	42
1400	530	1575	1520	1480	30	5	36	31	460	920	260	400	940	1040	1210	1010	1630	840	1000	40	42
1500	600	1690	1630	1590	30	5	36	31	460	920	260	400	1000	1040	1210	1055	1670	900	1040	40	42
1600	600	1790	1730	1690	32	5	40	31	540	980	270	400	1080	1105	1320	1120	1830	1100	1300	40	42
1750	670	1935	1880	1840	32	5	44	31	540	980	300	500	1130	1105	1320	1175	1955	1350	1500	45	42
1800	670	1990	1930	1890	34	5	44	31	540	980	300	500	1130	1105	1320	1210	1980	1370	1570	45	42
2000	760	2190	2130	2090	34	5	48	31	680	1040	360	560	1250	1250	1380	1380	2250	1370	1650	45	42
2200	590	2405	2340	2295	36	6	52	34	680	1040	300	450	1320	1250	1380	1480	2350	1600	1880	45	42
2400	650	2605	2540	2495	38	6	56	34	850	1090	350	500	1440	1360	1540	1590	2470	1740	2020	45	42
2600	700	2805	2740	2695	40	6	60	34	850	1090	400	550	1520	1360	1540	1670	2520	1850	2200	50	42
2800	760	3030	2960	2910	42	6	64	37	850	1090	500	650	1620	1360	1540	1775	2630	2000	2400	50	48
3000	810	3230	3160	3110	42	6	68	37	920	1140	550	700	1720	1430	1620	1885	2770	2160	2560	50	48
3200	870	3430	3360	3310	44	6	72	37	920	1140	600	750	1820	1430	1620	1970	2910	2360	2760	50	48
3400	920	3630	3560	3510	46	6	76	37	920	1140	650	800	1920	1430	1620	2060	3050	2420	2920	50	48
3500	920	3730	3660	3610	48	6	80	37	920	1140	650	800	1980	1430	1620	2110	3120	2680	3180	50	48
3600	970	3840	3770	3720	48	6	80	37	-	-	650	850	2050	-	-	-	-	2750	3250	50	56
3800	1020	4045	3970	3920	48	6	80	40	-	-	750	900	2100	-	-	-	-	2880	3380	50	56
4000	1070	4245	4170	4020	50	6	84	40	-	-	800	950	2200	-	-	-	-	2980	3480	50	56

主要连接尺寸 Main Connection Dimension(PN0.6Mpa)

单位Unit: mm

DN	L	D	D1	D2	b	f	n	d	L1	L2	L3	L4	H	H1	H2	B1	B2	B3	B4	b1	d1
300	270	440	395	363	24	4	12	23	210	705	100	150	300	650	860	280	760	320	380	30	30
350	290	490	445	413	24	4	12	23	210	705	100	140	320	650	860	305	810	320	380	30	30
400	310	540	495	463	24	4	16	23	210	705	120	180	350	650	860	365	860	340	420	30	30
500	350	645	600	568	26	4	20	23	235	745	150	220	400	730	1020	440	1016	400	500	40	32
600	390	755	705	667	26	5	20	28	235	745	150	250	460	730	1020	525	1066	450	550	40	32
700	430	860	810	772	26	5	24	28	235	745	180	290	520	730	1020	555	1080	570	700	40	32
800	470	975	920	878	28	5	24	31	235	745	180	310	580	730	1020	605	1240	650	780	40	32
900	510	1075	1020	978	28	5	24	31	380	890	180	320	640	960	1160	670	1310	700	860	40	35
1000	550	1175	1120	1078	30	5	28	31	380	890	200	360	690	960	1160	775	1360	740	900	40	35
1200	630	1405	1340	1295	30	5	32	34	380	890	200	360	810	960	1160	855	1500	790	950	40	35
1300	530	1520	1450	1405	32	5	32	37	380	890	260	400	860	960	1160	935	1565	820	960	40	42
1400	530	1630	1560	1510	32	5	36	37	460	920	260	400	940	1040	1210	1010	1630	840	1000	40	42
1500	600	1730	1660	1610	34	5	36	37	460	920	260	400	1000	1040	1210	1055	1670	900	1040	40	42
1600	600	1830	1760	1710	34	5	40	37	540	980	270	400	1080	1105	1320	1120	1830	1100	1300	40	42
1750	670	1995	1920	1868	36	5	44	40	540	980	300	500	1130	1105	1320	1175	1955	1350	1500	45	42
1800	670	2045	1970	1918	38	5	44	40	540	980	300	500	1130	1105	1320	1210	1980	1370	1570	45	42
2000	760	2265	2180	2125	40	5	48	43	680	1040	360	560	1250	1250	1380	1380	2250	1400	1650	45	42
2200	590	2475	2390	2335	42	6	52	43	680	1040	300	450	1320	1250	1380	1480	2350	1600	1880	45	42
2400	650	2685	2600	2545	45	6	56	43	850	1090	350	500	1440	1360	1540	1590	2470	1740	2020	45	48
2600	700	2905	2810	2750	46	6	60	49	850	1090	400	550	1520	1360	1540	1670	2520	1850	2200	50	48
2800	760	3115	3020	2960	48	6	64	49	850	1090	500	650	1620	1360	1540	1775	2630	2000	2400	50	48
3000	810	3315	3220	3160	50	6	68	49	920	1140	550	700	1720	1430	1620	1885	2770	2160	2560	50	48
3200	870	3525	3430	3370	54	6	72	49	920	1140	600	750	1820	1430	1620	1970	2910	2360	2760	50	48
3400	920	3735	3640	3580	56	6	76	49	920	1140	650	800	1920	1430	1620	2060	3050	2420	2920	50	48
3500	920	3840	3745	3685	58	6	80	49	920	1140	650	800	1980	1430	1620	2110	3120	2680	3180	50	48
3600	970	3970	3860	3790	62	6	80	56	-	-	700	850	2050	-	-	-	-	2750	3250	50	56
3800	1020	4180	4065	3990	66	6	80	62	-	-	750	900	2150	-	-	-	-	2880	3380	50	56
4000	1020	4380	4265	4190	70	6	84	62	-	-	800	950	2250	-	-	-	-	2980	3480	50	56

主要连接尺寸 Main Connection Dimension(PN1.0Mpa)

单位Unit: mm

DN	L	D	D1	D2	b	f	n	d	L1	L2	L3	L4	H	H1	H2	B1	B2	B3	B4	b1	d1
300	270	445	400	370	26	4	12	23	210	705	100	150	300	650	860	280	765	320	380	30	30
350	290	505	460	429	28	4	16	23	210	705	100	140	320	650	860	305	810	320	380	30	30
400	310	565	515	480	32	4	16	28	210	705	120	180	350	650	860	365	860	340	420	30	30
500	350	670	620	582	34	4	20	28	235	745	150	220	400	730	1020	440	1016	400	500	40	32
600	390	780	725	682	35	5	20	31	235	740	150	250	460	730	1020	525	1066	450	550	40	32
700	430	895	840	794	35	5	24	31	235	740	180	290	520	730	1020	555	1080	570	700	40	32
800	470	1015	950	901	40	5	24	34	235	740	180	310	580	730	1020	605	1240	650	780	40	32
900	510	1115	1050	1001	40	5	28	34	380	890	180	320	640	960	1160	670	1310	700	860	40	35
1000	550	1230	1160	1112	42	5	28	37	380	890	200	360	690	960	1160	755	1360	740	900	40	35
1100	550	1340	1270	1222	42	5	28	37	380	890	200	360	750	960	1160	805	1410	760	920	40	35
1200	630	1455	1380	1328	45	5	32	40	460	920	200	360	810	1040	1210	855	1500	790	950	40	35
1250	530	1505	1430	1378	45	5	32	40	460	920	200	360	810	1040	1210	910	1525	1140	1280	40	42
1300	530	1575	1490	1425	45	5	32	43	460	920	260	400	860	1040	1210	935	1565	820	960	40	42
1400	530	1675	1590	1530	46	5	36	43	540	980	260	400	940	1105	1320	1010	1630	840	1000	40	42
1500	600	1785	1700	1640	46	5	36	49	540	980	260	400	1000	1105	1320	1055	1670	900	1040	40	42
1600	600	1915	1820	1750	50	5	40	49	540	980	270	400	1080	1105	1320	1120	1830	1100	1300	40	42
1750	670	2065	1970	1900	50	5	44	49	680	1040	300	500	1130	1250	1380	1175	1955	1350	1500	45	42
1800	670	2115	2020	1950	52	5	44	49	680	1040	300	500	1130	1250	1380	1210	1980	1370	1570	45	42
2000	760	2325	2230	2150	54	5	48	49	850	1090	360	560	1250	1360	1540	1380	2250	1370	1650	45	48
2200	590	2550	2440	2370	58	5	52	56	850	1090	300	450	1320	1360	1540	1480	2350	1600	1880	45	48
2250	590	2600	2490	2420	60	5	52	56	850	1090	300	450	1330	1360	1540	1510	2375	1600	1880	45	48
2400	650	2760	2650	2570	65	6	56	56	920	1140	350	500	1440	1430	1620	1590	2470	1740	2020	45	48
2600	700	2960	2850	2780	65	6	60	56	850	1090	400	550	1520	1360	1540	1670	2520	1850	2200	50	42
2800	760	3180	3070	3000	70	6	64	56	850	1090	500	650	1620	1360	1540	1775	2630	2000	2400	50	48
3000	810	3405	3290	3210	75	6	68	62	920	1140	550	700	1720	1430	1620	1885	2770	2160	2560	50	48

主要连接尺寸 Main Connection Dimension(PN1.6Mpa)

单位Unit: mm

DN	L	D	D1	D2	b	f	n	d	L1	L2	L3	L4	H	H1	H2	B1	B2	B3	B4	b1	d1
300	270	460	410	375	26	4	12	27	210	705	100	150	300	650	860	280	765	320	380	30	30
350	290	520	470	429	28	4	16	27	210	705	100	140	320	650	860	305	810	320	380	30	30
400	310	580	525	480	32	4	16	31	210	705	120	180	350	650	860	365	860	340	420	30	30
500	350	715	650	609	34	4	20	34	235	740	150	220	400	730	1020	440	1020	400	500	40	32
600	390	840	770	720	35	5	20	37	235	740	150	250	460	730	1020	525	1066	450	550	40	32
700	430	910	840	794	35	5	24	37	235	740	180	290	520	730	1020	555	1080	570	700	40	32
800	470	1025	950	901	40	5	24	40	380	890	180	310	580	960	1160	605	1240	650	780	40	32
900	510	1125	1050	1001	40	5	28	40	380	890	180	320	640	960	1160	670	1310	700	860	40	35
1000	550	1255	1170	1112	42	5	28	43	460	920	200	360	690	1040	1210	755	1360	740	900	40	35
1100	550	1370	1280	1222	42	5	28	43	460	920	200	360	750	1040	1210	805	1410	760	920	40	35
1200	630	1485	1390	1328	45	5	32	49	540	980	200	360	810	1105	1320	855	1500	790	950	40	35
1250	530	1535	1440	1378	46	5	32	49	540	980	200	360	810	1105	1320	910	1525	1140	1280	40	42
1300	530	1585	1490	1425	50	5	32	49	540	980	260	400	860	1105	1320	935	1565	820	960	40	42
1400	530	1685	1590	1530	54	5	36	49	540	980	260	400	940	1105	1320	1010	1630	840	1000	40	42
1500	600	1820	1710	1640	54	5	36	49	540	980	260	400	1000	1105	1320	1055	1670	900	1040	40	42
1600	600	1930	1820	1750	56	5	40	56	680	1040	270	400	1080	1250	1380	1120	1830	1100	1300	40	42
1750	670	2080	1970	1900	60	5	44	56	680	1040	300	500	1130	1250	1380	1175	1955	1350	1500	45	42
1800	670	2308	2020	1950	60	5	44	56	680	1040	300	500	1130	1250	1380	1210	1980	1370	1570	45	42
2000	760	2345	2230	2150	65	5	48	62	850	1090	360	560	1250	1360	1540	1380	2250	1370	1650	45	48
2200	590	2555	2440	2360	70	6	52	62	850	1090	300	450	1320	1360	1540	1480	2350	1600	1880	45	48
2250	590	2605	2490	2410	70	6	52	62	850	1090	350	500	1330	1360	1540	1510	2375	1600	1880	45	48

主要连接尺寸 Main Connection Dimension(PN2.5Mpa)

单位Unit: mm

DN	L	D	D1	D2	b	f	n	d	L1	L2	L3	L4	H	H1	H2	B1	B2	B3	B4	b1	d1
300	270	485	430	389	34	4	12	31	210	705	100	140	300	650	860	280	765	320	380	30	32
350	290	555	490	448	38	4	16	34	210	705	100	150	300	650	860	305	810	320	380	30	32
400	310	620	550	503	40	4	16	37	235	740	120	180	330	730	1020	365	860	340	420	30	32
500	350	730	660	609	44	4	20	37	235	740	150	220	380	730	1020	440	1016	400	500	40	35
600	390	845	770	720	46	5	20	40	235	740	150	250	430	730	1020	525	1066	430	546	40	35
700	430	960	875	820	50	5	24	43	380	890	180	290	500	960	1160	555	1080	570	700	40	35
800	470	1085	990	928	54	5	24	49	380	890	180	310	550	960	1160	605	1240	610	740	40	38
900	510	1185	1090	1028	58	5	28	49	380	890	180	320	610	960	1160	670	1310	700	860	40	38
1000	550	1320	1210	1140	62	5	28	56	460	920	200	360	670	1040	1210	755	1360	740	900	40	42
1100	550	1425	1315	1245	65	5	28	56	460	920	200	360	750	1040	1210	805	1410	760	920	40	42
1200	630	1530	1420	1350	70	5	32	56	460	920	200	360	780	1040	1210	855	1500	790	950	40	48
1250	630	1575	1470	1400	70	5	32	56	460	920	200	360	800	1040	1210	910	1525	790	950	40	48
1300	710	1640	1530	1450	74	5	32	62	460	920	260	460	840	1040	1210	935	1565	820	960	40	48
1400	710	1755	1640	1560	76	5	36	62	540	980	260	460	890	1105	1320	1010	1630	840	1000	40	52
1500	790	1865	1750	1670	80	5	36	62	540	980	260	500	960	1105	1320	1055	1670	900	1040	40	52
1600	790	1975	1860	1780	84	5	40	62	540	980	270	500	1010	1105	1320	1120	1830	960	1140	40	56
1750	870	2145	2020	1935	90	5	44	70	680	1040	270	500	1100	1250	1380	1175	1955	1350	1500	45	56
1800	870	2195	2070	1985	90	5	44	70	680	1040	270	500	1110	1250	1380	1210	1980	1370	1570	45	56



合作伙伴  
Partner



中国石油



中国石化



中国海油



易派客



中国化学工程



国家能源集团



中国大唐集团



中化二建集团



中国华能集团



山东奇威特



哈电集团



华陆工程



化学工业集团



中国铝业股份



骏能化工



中国中药控股



北京佰能蓝天科技



江苏华能建设



中煤能源集团



东方锅炉集团



新疆东方希望



鲁西化工集团



新乡瑞诺药业



沧州信联化工



中国兵器采购



呼伦贝尔东能化工



中国核工业集团



科圣鹏环境科技



### OULAM 公司总部

浙江省温州市永嘉县瓯北街道林浦北路2665号

销售热线: 0577-67922555 0577-67999989

企业邮箱: oulam@188.com

#### 华东区域

销售热线: 0577-67922578

图文传真: 0577-67999178

华东地区包括: 上海市、安徽省、江苏省、

江西省、浙江省、福建省

(6个省、市)。

#### 华南区域

销售热线: 0577-67922558

图文传真: 0577-67999178

华南地区包括: 广东省、广西、海南省

个省(3区)。

#### 华北区域

销售热线: 0577-67922557

图文传真: 0577-67999178

华北地区包括: 内蒙古、北京市、天津市、

山西省、河北省(5个省、市、区)

#### 华中区域

销售热线: 0577-67977776

图文传真: 0577-67999178

华中地区包括: 山东省、河南省、湖北省、

湖南省(4个省)。

#### 西北区域

销售热线: 0577-67999177

图文传真: 0577-67999178

西北地区包括: 宁夏、新疆、甘肃省、

陕西省、青海省(5个省、市、区)。

#### 西南区域

销售热线: 0577-67999177

图文传真: 0577-67999178

西南地区包括: 四川省、云南省、西藏、

贵州省、重庆市(5个省、市、区)

#### 东北区域

销售热线: 0577-67999133

图文传真: 0577-67999178

东北地区包括: 吉林省、辽宁省、黑龙江省

(3个省)

# SERVICE 服务

1

## 售前服务 | Pre-sale service

当好客户的参谋和助手，让用户的每一份投资都获得丰厚的回报。

Being a good consultant and assistant of the customer; making customers get rich repayment to every investment.

**A、设备型号的选择。**

Selection to equipment pattern.

**B、根据客户的特殊要求，设计制造产品。**

Designing and producing according to the customer's requirement.

**C、为客户培训技术人员。**

Training technician for customer.

**D、提供新、特、难工程生产技术咨询或拟定合适的生产方案。**

Offering technical consultation or drawing up proper producing programs for new, special, and difficult projects.

2

## 售中服务 | Sale service

以尊重为本，让客户体验放心、轻松与惊喜，持续提升客户价值。

Based on respect, we aim to provide customers with a reassuring, relaxed and surprising experience, and continuously enhance customer value.

**A、保修期内送货上门。**

On-spot service in guarantee period.

**B、产品的预验收。**

Pre-acceptance and check of the products.

**C、向顾客介绍本企业的服务体系。**

Introducing the Enterprise service system to cutomers.

3

## 售后服务 | After-sale service

提高客户整体价值，让客户无后顾之忧。

Improving the customer's whole value; lettirvg customers have no worry.

**A、协助用户拟定首次施工方案。**

Assisting the customer to draw up the initial project plan.

**B、设备安装调试**

Debugging of the equipment installation.

**C、现场培训操作人员。**

Training technician on-spot.

**D、定期巡检设备。**

Checking and testing the equipment on terms.

**E、快速主动、现场排故。**

Quick and active; removing the malfunction on spot.

**F、保修配件送货上门。**

Delivering the guaranteed parts to customers.

**G、重点工程的跟踪服务。**

Follow-up service for key projects.

**H、提供超值服务。**

Offering over-value service.

**I、提供技术交流的机会。**

Offering opportunities for technical exchanges.

**J、开展大项维修业务。**

Offering the business for large maintenance.

**Note:**



A series of horizontal dotted lines spanning the width of the page, intended for handwritten notes.

**欧拉姆，好阀门柔性造！**  
OULAM, EXPERT VALVES, VERSATILE SOLUTIONS

**欧拉姆阀门科技有限公司**

OULAM VALVE TECHNOLOGY CO., LTD.

Add: 浙江省温州市永嘉县瓯北街道林浦北路2665号

Tel: 0577-67922555 67999989

E-mail: [oulam@188.com](mailto:oulam@188.com)

Http://[www.oulam.cn](http://www.oulam.cn)



欢迎关注欧拉姆